

Revisions at SR 525 interchange and 35th Avenue West

The recommended concept provides pedestrian and bicycle facilities through the interchange, realigns ramp connections to intersect SR 99 closer to 90 degrees to lower turning speeds, adds BAT lanes and adds raised, crossings with rectangular rapid flashing beacons (RRFB) to prioritize people walking and biking. Drivers would access the SR 525 on ramps from the BAT lane.

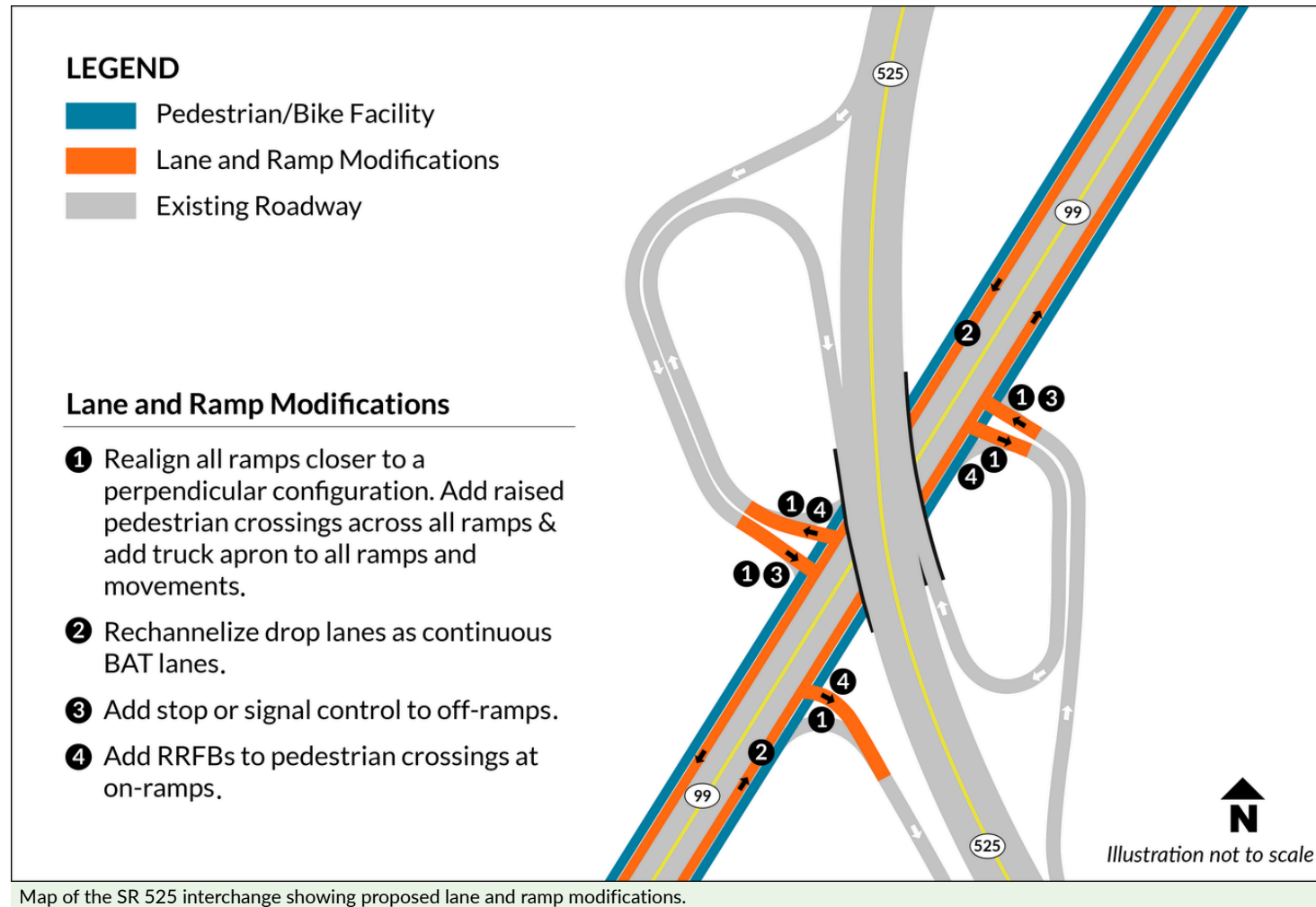

SR 99

Lynnwood and Unincorporated Snohomish County Pre-Design Study

Why is WSDOT Studying State Route 99 in South Snohomish County?

The SR 99 Lynnwood and Unincorporated Snohomish County Pre-Design Study developed improvement concepts and options to enhance safety and convenient connections for people walking, biking, rolling, and accessing transit. The study area extends along SR 99 from 212th Street Southwest to Airport Road. (See Map)

This project is needed to:

- Make walking and biking more comfortable and less stressful
- Provide continuous sidewalks and bike facilities
- Add more controlled marked crossings
- Reduce fatal and serious crashes
- Improve access to reliable transit
- Balance freight needs with other needs
- Support affordable, healthy travel options for all communities

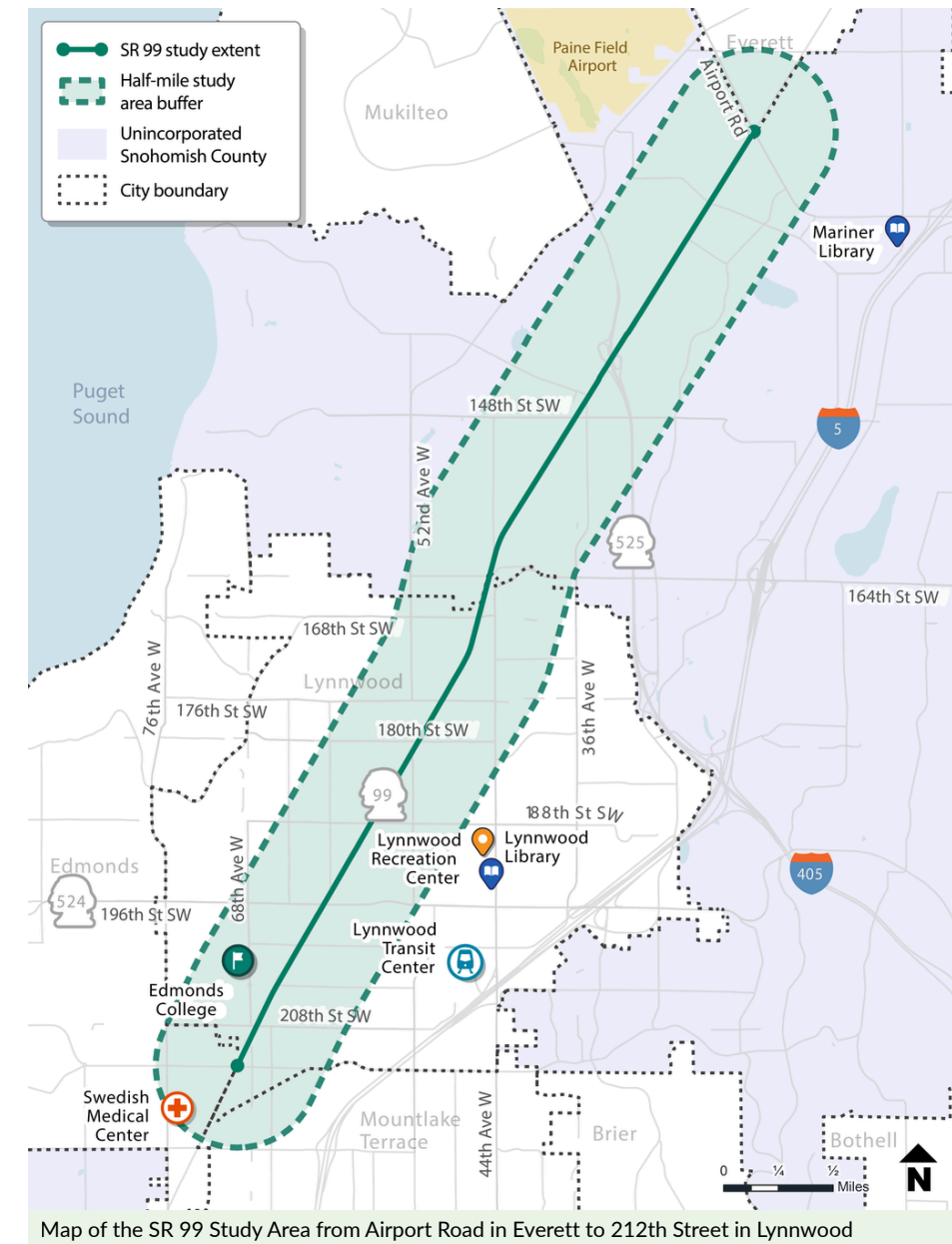

We want to hear from you!



This online open house provides information about an important WSDOT study focusing on improvements for people walking, rolling and taking transit. The full survey should take no more than 5 minutes and is available through January 20, 2026.

For more information, contact Amber Stanley
Amber.Stanley@Wsdot.WA.gov or at 206-817-8833

Americans with Disabilities Act (ADA) Information: Accommodation requests for people with disabilities can be made by contacting the WSDOT Diversity/ ADA Affairs team at wsdotada@wsdot.wa.gov or calling toll free, 855-362-4ADA (4232). Persons who are deaf or hard of hearing may make a request by calling the Washington State Relay at 711.

Title VI Statement to Public: It is the Washington State Department of Transportation's (WSDOT) policy to assure that no person shall, on the grounds of race, color, national origin or sex, as provided by Title VI of the Civil Rights Act of 1964, be excluded from participation in, be denied the benefits of, or be otherwise discriminated against under any of the programs and activities. Any person who believes his/her Title VI protection has been violated, may file a complaint with WSDOT's Office of Equal Opportunity (OEO). For additional information regarding Title VI complaint procedures and/or information regarding our non-discrimination obligations, please contact OEO's Title VI Coordinator at (360) 705-7090.

	Speed Limit Reduction		Transit Stop Integration
	Review Design Guidelines		Prioritization of Improvements
	Review Access Management Policies		Implement Cross-section Improvements with Development
	Study U-Turn Locations		Study Other Long Term Options

Policy changes that help address the identified needs

WSDOT coordinated with local agencies in a Technical Working Group and Executive Advisory Group. Collectively, WSDOT and partner agencies identified policy changes that would help address the needs identified using analysis and community feedback.

Spot treatments

Spot treatments address specific locations with crossing gaps, turning movement conflicts or transit access issues. To deliver improvements consistently, treatments are organized into four repeatable packages. Each treatment package includes multiple improvements. Four spot treatment packages are recommended at 37 locations.



Enhancements at traffic lights



New controlled crossings at intersections

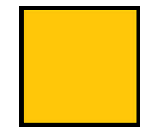





Midblock controlled crossings



Enhancements at driveways and intersections without traffic lights



LEGEND

-  Enhancements at Traffic Lights
-  New Controlled Crossing at Intersections
-  New Mid-Block Controlled Crossing
-  Enhancements at Driveways and Intersections without Traffic Lights
-  Potential New/Relocated Bus Stop

