

# **I-405/Brickyard to SR 527 Improvement Project**

Quarterly public meeting

February 26, 2025

# Zoom Controls

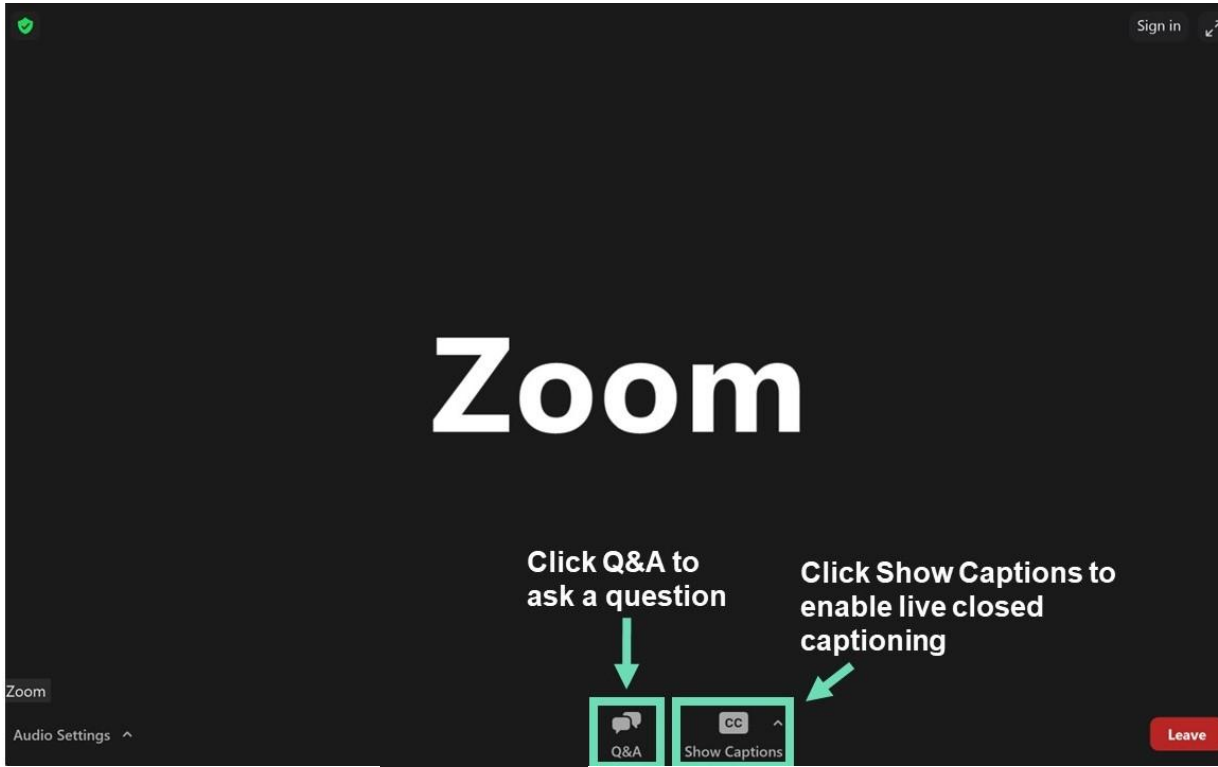

Isaiah is our meeting host

Please use the chat feature to message Isaiah if you have any technical difficulties

# Agenda

- Welcome and introductions
- Project overview
- Sound Transit updates
- Construction updates
- How to stay informed

# Welcome & introductions

- **Evelyn Pao**, WSDOT, Project Director
- **Lauren Penning**, WSDOT, Communications Lead
- **Pat Prendergast**, Skanska, Project Director
- **Paul Cornish**, Sound Transit Strategic Project Director, Bus Rapid Transit
- **Elizabeth Guevara**, Sound Transit, Stride Communications
- **Laura Halady**, Skanska Communications
- **Isaiah Honick**, Skanska Communications
- **Maddie Dewhirst**, Skanska Communications

---

# Poll question 1

---

# Project overview

# Project overview



Expand express toll lane (ETL) capacity.



Widen I-405 through the SR 522 interchange.



Add direct access ramps at the SR 527 and SR 522 interchanges.



Construct a new transit hub, build inline bus rapid transit (BRT) stations on I-405, and improve bus transit connections locally.



Improve connections for pedestrians and cyclists to transit and trails.



Improve local roadways and state routes.



Correct and repair fish barriers.

# *Stride*

*Bus Rapid Transit (BRT)*



# Program updates

## Key openings

- Downtown Redmond Link Extension
  - Start of Service on May 10, 2025
  - Two new stations

## Station, shelters, furnishings, systems:

- Construction to begin in late 2025

### S3 – SR522/Bothell

100% Design complete, advertise in Q1 2025

### S1 & S2 – I-405

90% Design complete on ST delivered work

### Bus Base North

Construction to be advertised in Q1 2025



# Program updates



Art credit: Angelina Villalobos



Art credit: Angelina Villalobos



---

# Poll question 2

---

# Construction updates

# Construction milestones

## I-405 Brickyard – Project Update

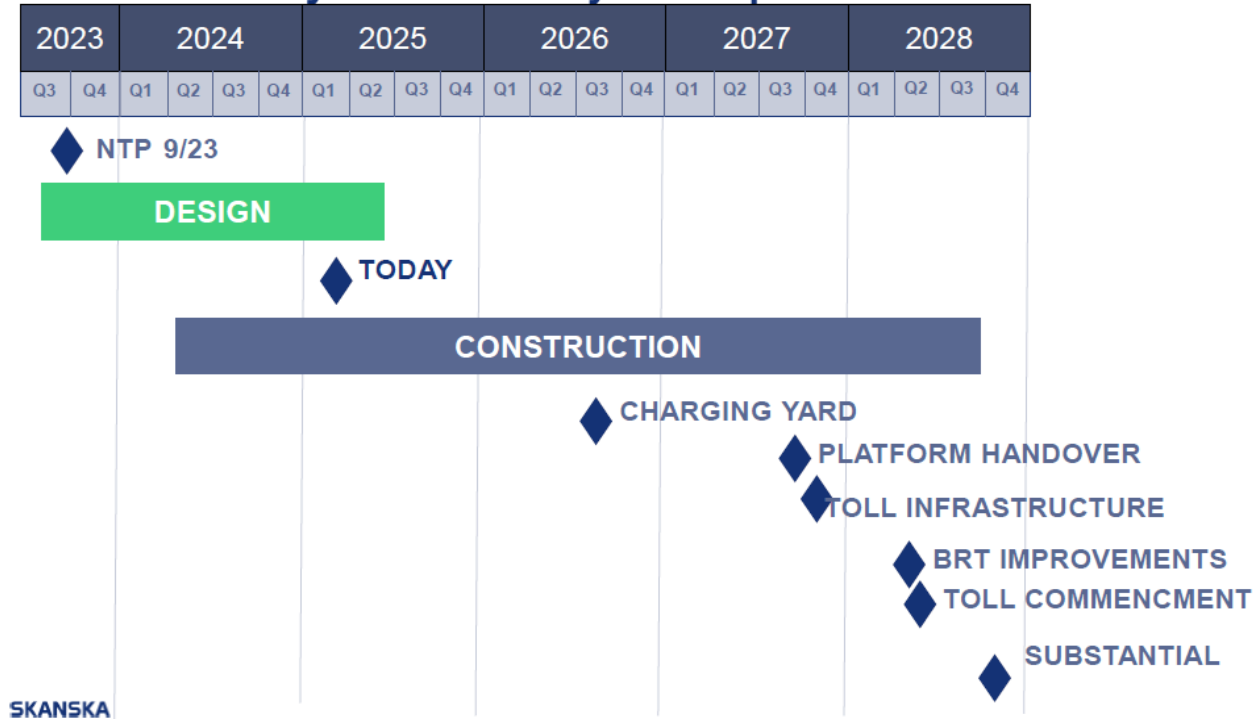

SKANSKA

# I-405/SR 522 work zone locations

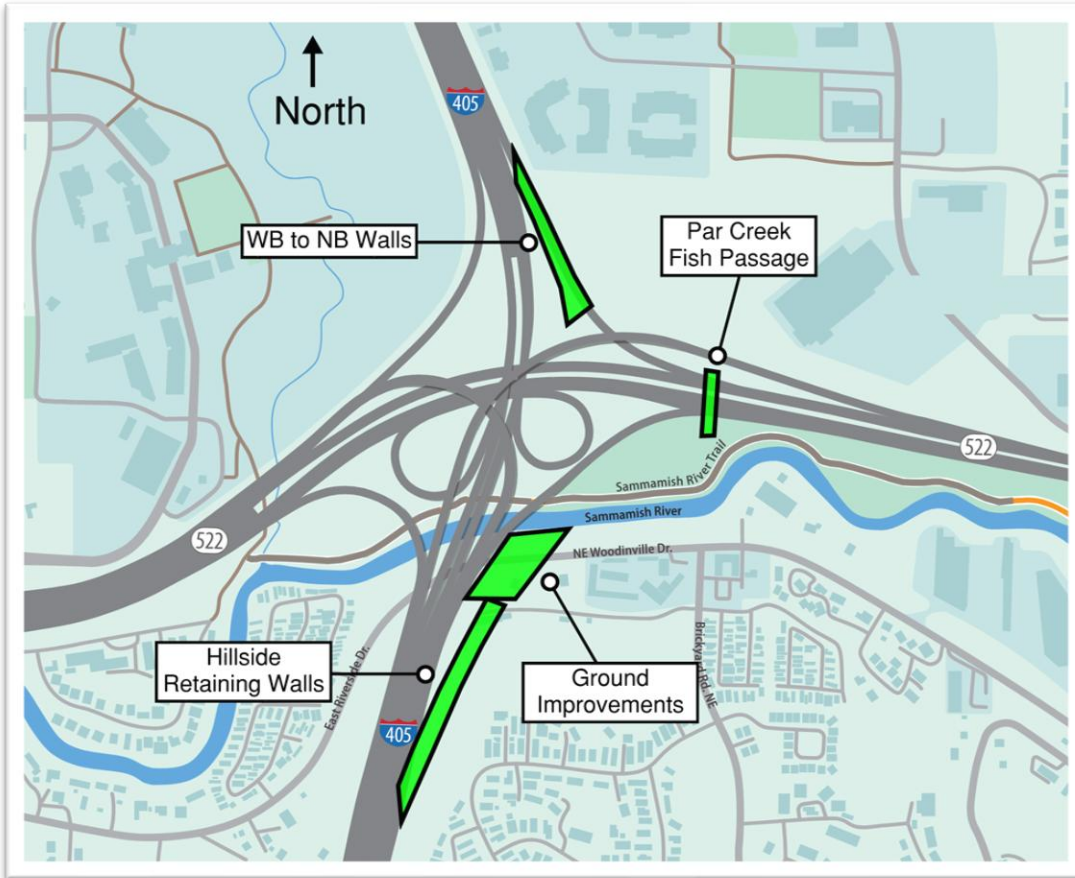



# Project Progress

## I-405 traffic shift near Northeast 160th Street

- Opened new work zones near Brickyard Park & Ride
- Completed staging/bus station relocation for Brickyard Station work
- Installing communications network infrastructure from Brickyard at Northeast 160th to the south end of the project.



*Looking north at I-405 and Northeast 160th Street.*

# Project Progress

## Northbound I-405 near SR 522 off-ramp

- Built soldier pile wall
- Building tieback wall

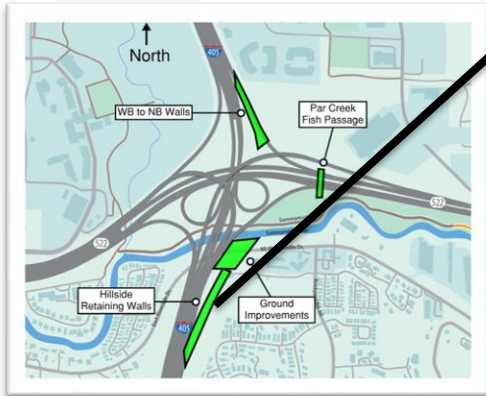

*Looking northeast at soldier pile and tieback wall construction along northbound I-405.*



# Project Progress

## Sammamish River Area/Woodinville Drive

Northbound I-405 to eastbound SR 522  
bridge construction start:

- Pile installation, November 2024
- Foundations started south side, November 2024
- Foundations start north side, March 2025

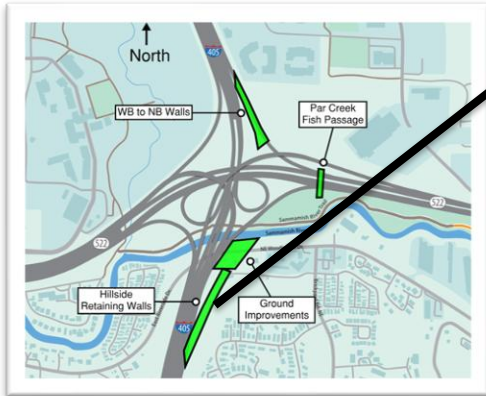

*Looking east, crews work on the south side of the Sammamish River, next to Woodinville Drive.*

# Project Progress

## Temporary trail detour

- Short reroute around the active work zone underneath the I-405/SR 522 interchange
- Brief closures of the trail no longer than 15 minutes and not to exceed 45 minutes in a day.

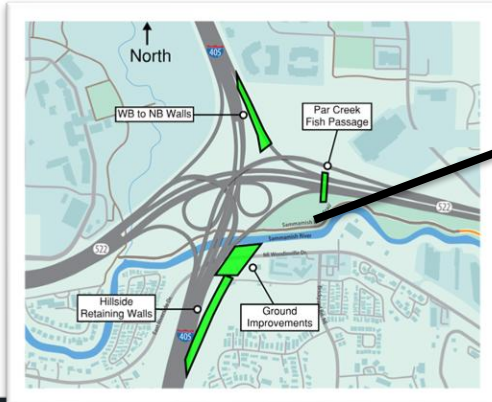

*Looking northeast on the Sammamish River reroute north of the Sammamish River.*



# Project Progress

## Par Creek fish passage SR 522

- Completed first segment of fish passage
- Shifted westbound SR 522 to northbound I-405 ramp traffic

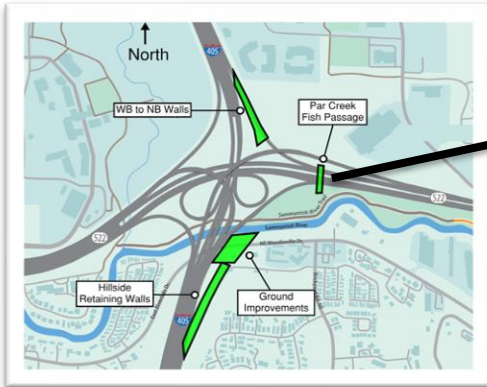

*Looking west at the westbound SR 522 ramp to northbound I-405 after paving over a section of the new Par Creek Fish Passage under SR 522.*

# Upcoming work

## Juanita Creek

Clear and grub west side of I-405 to prep site for construction – March

## Brickyard Station

Utility and foundation work – April



*Looking northwest at the Brickyard Park & Ride on the westside of I-405.*

# Upcoming work

## Westbound SR 522 to Northbound I-405 new on-ramp

Second phase of Par Creek work, final ramp alignment in place - April

## SR 522 both directions lane shifts

Lanes shift northward - April

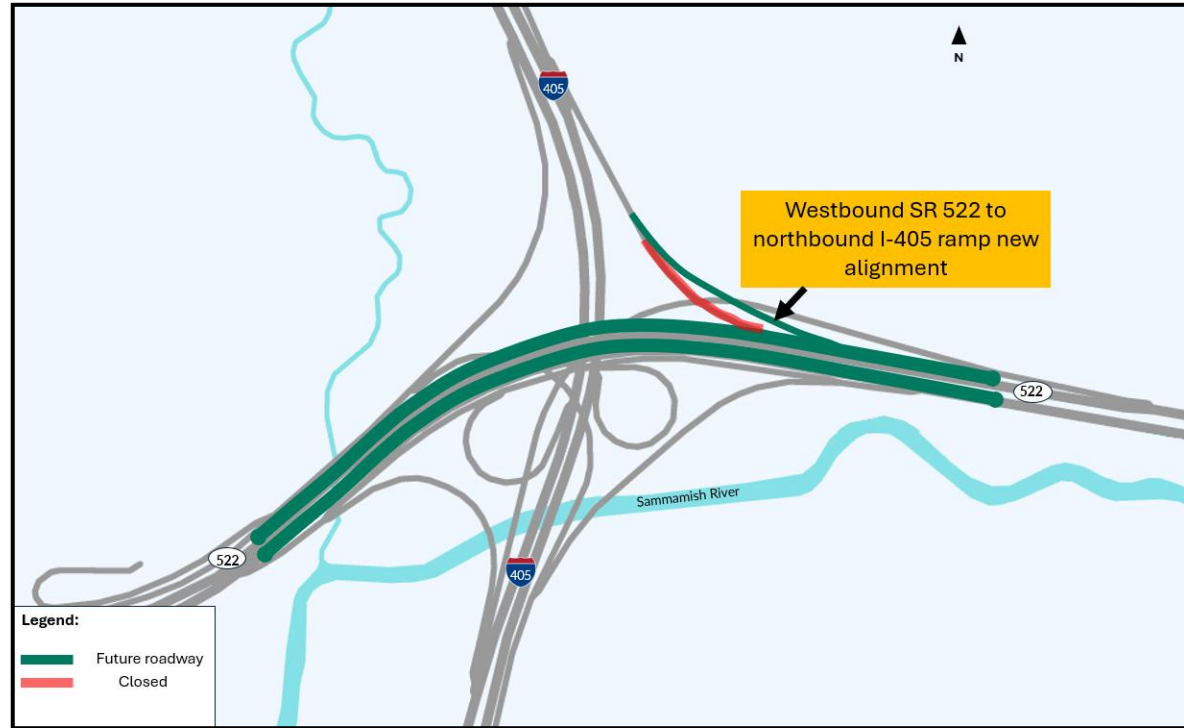

*Future alignment for SR 522 general purpose lanes and westbound SR 522 ramp to northbound I-405.*



# Upcoming work

## I-405 lane shifts near SR 527 - April

Both northbound and southbound lanes shift to create space for future roadway configuration

## Northbound I-405 to SR 527 ramp/North Fork Perry Fish Passage - April

- Access, egress to construct wall
- Clear and grub
- Build pond



*Looking northeast at the Canyon Park Park & Ride.*

---

# Poll question 3

---

# How to stay informed



# How we're keeping communities and partners informed

- Quarterly project updates
- Mailed materials and information
- Briefings, meetings and events
- Email and website updates
- Poster and flyer distribution
- Project toolkits



Stay informed by subscribing to email updates.

Updates include:

- Closures
- Lane shifts
- Night or potentially impactful work
- Changes in work hours
- Construction milestones

# How to stay updated



## General project questions and email list:

[I405SR167Program@wsdot.wa.gov](mailto:I405SR167Program@wsdot.wa.gov)

Email us to be added to the Brickyard to SR 527 Project email list.



## Construction email:

[info@405Brickyard.com](mailto:info@405Brickyard.com)



## Visit our website:

<https://bit.ly/BY-to-SR-527>



## Call our construction hotline:

425-354-3232

Monitored weekdays, 8 a.m. to 5 p.m.



Scan the QR code  
with your phone to  
visit our website.

# Questions?