

I-405/Northeast 85th Street Interchange and Inline BRT Station Project

Construction updates

Feb. 4, 2025

This meeting is being recorded. The recording will be sent to meeting registrants via email and posted on the project webpage.

Zoom controls

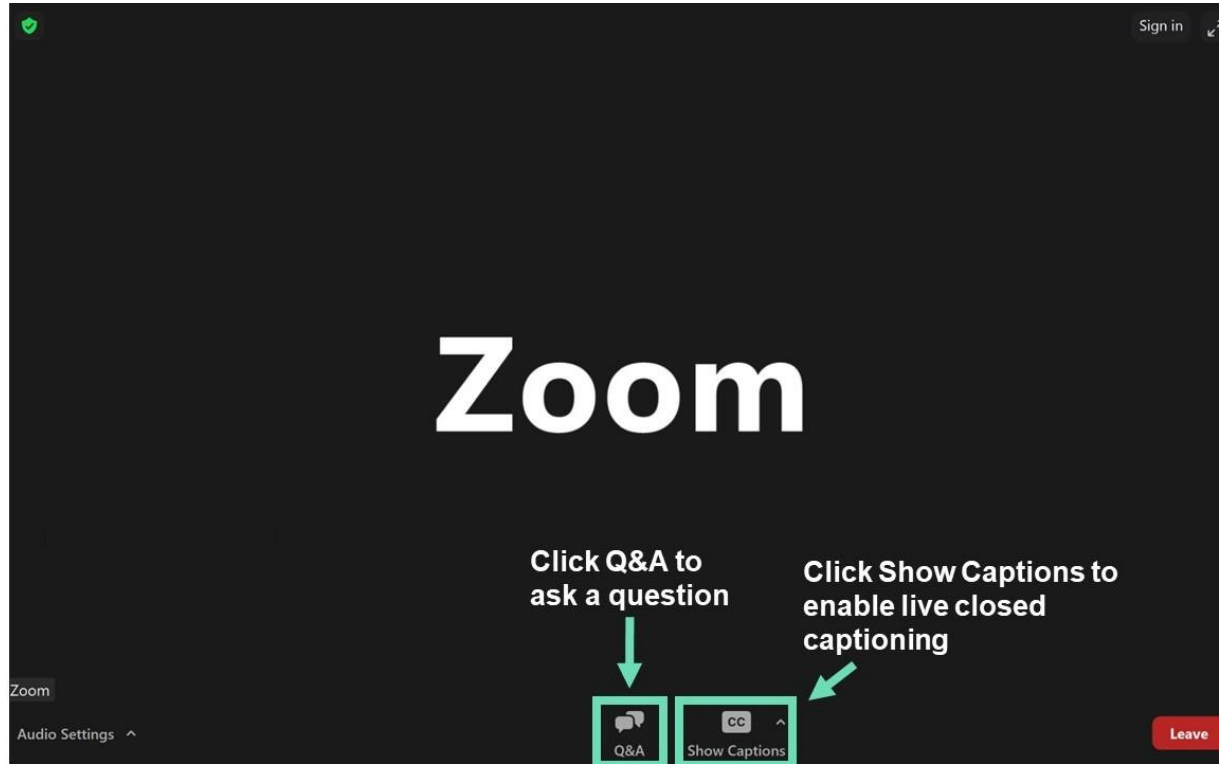

Welcome & introductions

- **Aliah Marzolf**, Meeting Facilitator, Graham Communications
- **Cheryl Webster**, Graham Construction Project Controls Specialist
- **Steve M. Beadle, PE**, WSDOT Project Engineer
- **Paul Cornish**, Sound Transit Strategic Project Director
- **Sarah Olson**, City of Kirkland Deputy Director of Public Works Department

Agenda

Project overview and benefits

Bus Rapid Transit (BRT)

Construction updates

- Schedule (2023 – 2027)
- What's completed or in progress? What's next?
- Upcoming City of Kirkland construction projects
- What you can expect during construction

Keeping the community informed

- Outreach efforts
- Real-time travel map and app

Stay in touch!

Questions?

Poll questions

Before we start, we want to hear from you

Project overview



Coordinated Projects on I-405 Corridor

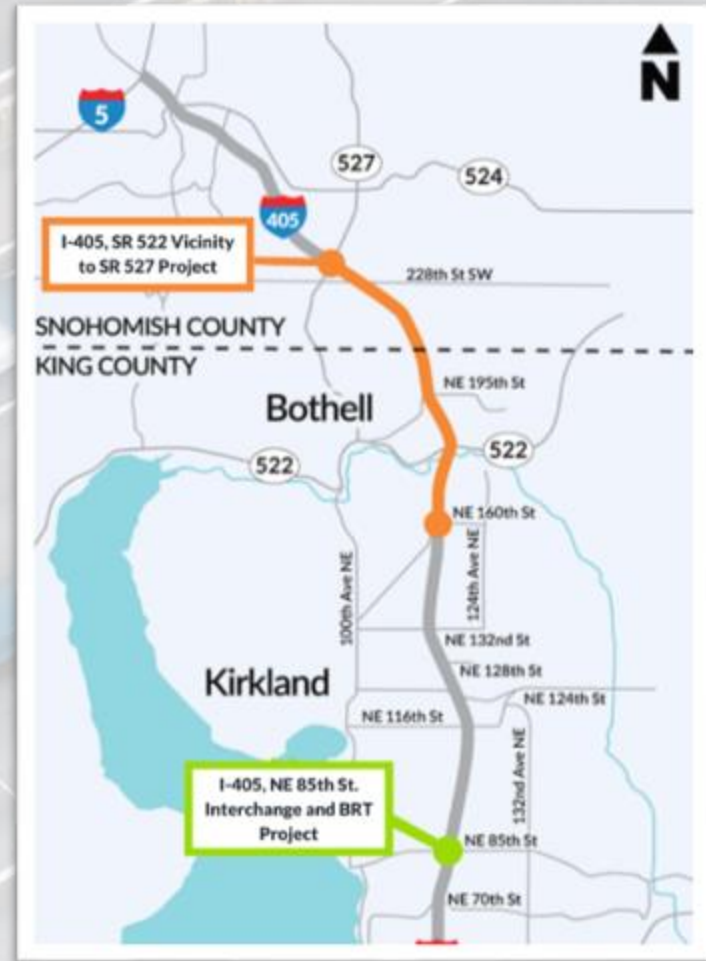

The future of Northeast 85th Street

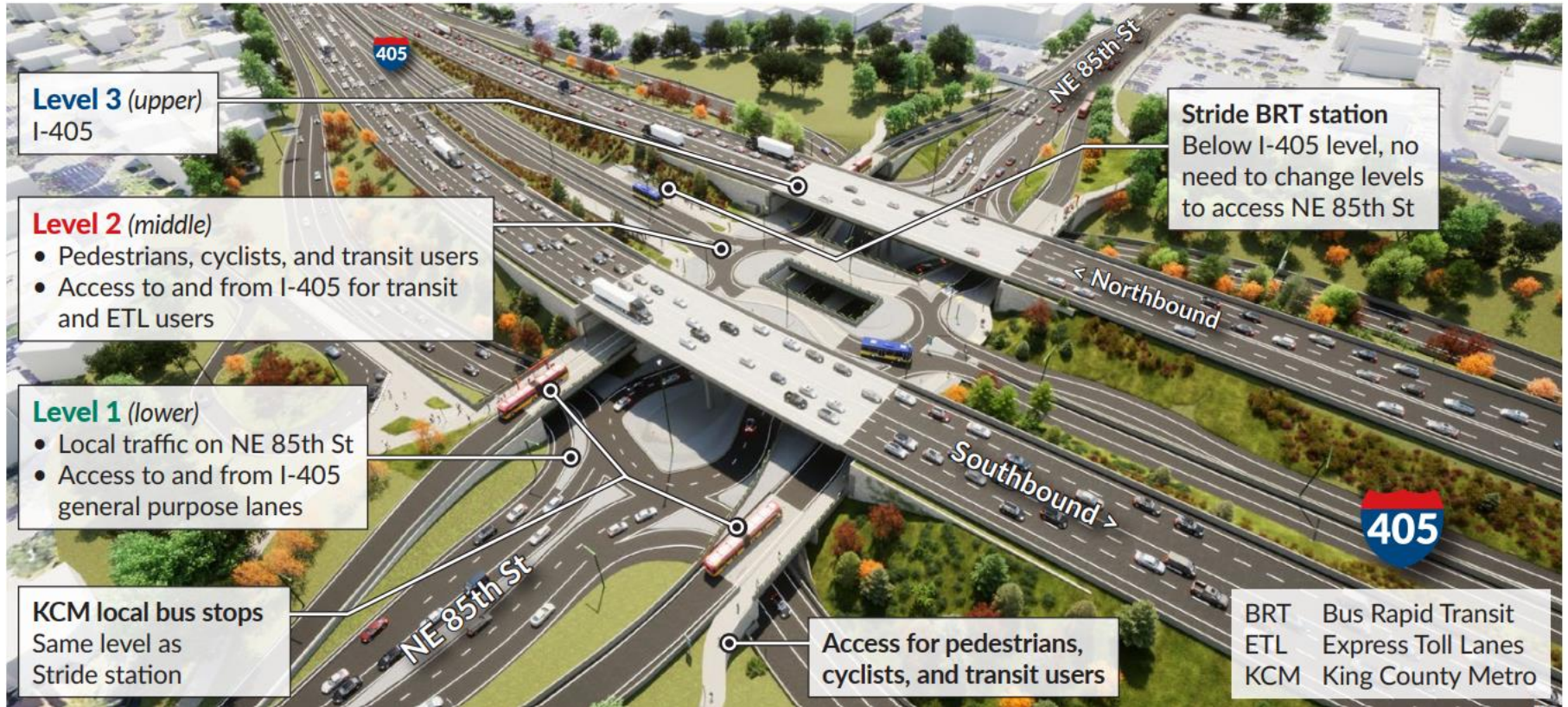

Northeast 85th Street and I-405



Level One

- Below existing Northeast 85th Street elevation
- Passenger and truck traffic

Level Three

- At existing I-405 elevation
- Freeway traffic

Bus Rapid Transit, Express Toll Lanes, and Pedestrians

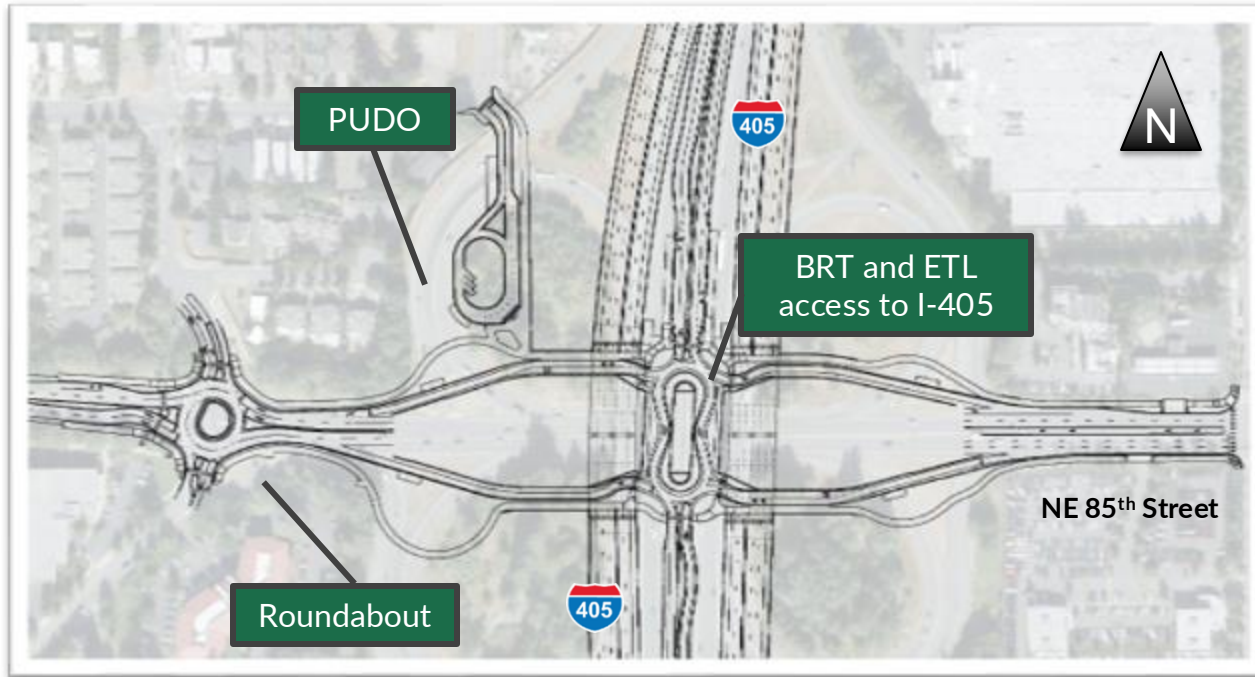

The new middle level is at the existing NE 85th St elevation and includes:

- Access for Bus Rapid Transit (BRT), Express Toll Lanes (ETL)
- The Pick-Up-Drop-Off (PUDO)
- New roundabout
- Access for people who walk, bike, or roll

Stride

Bus Rapid Transit (BRT)

Program updates

Key openings

- Downtown Redmond Link Extension
 - Start of Service on May 10, 2025
 - Two new stations

Stations, shelters, furnishings, systems:

- Construction to begin in late 2025

S3 – SR522/Bothell

- 100% Design Complete, Advertise in Q1 2025

S1 & S2 – I-405

- 90% Design Complete on ST Delivered Work

Bus Base North

- Construction To Be Advertised on Q1 2025



Program updates

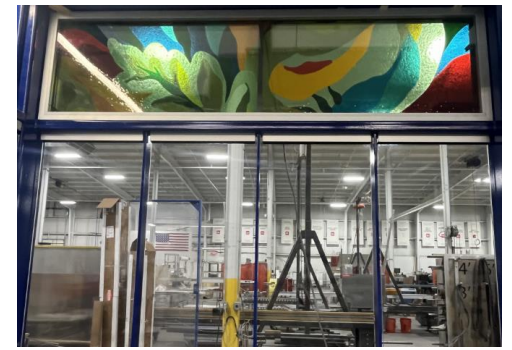

Art credit Angelina Villalobos



Art credit Angelina Villalobos



Construction updates

Project schedule

Design

February 2023 – June 2024



Phase 5

All traffic to new alignments, Direct access ramps, PUDO, landscaping

Phase 4

Northeast 85th Street traffic on direct access level I-405 alignment to include new general-purpose ramp configuration

Phase 3

Northeast 85th Street traffic to direct access alignment

★ We are here

Phase 2 - Milestone

I-405 shifts into new traffic alignment throughout the duration of the project

Phase 1

Current traffic alignment of I-405 85th Street remains in Phase 1 until Q3 2025 Phase 3



Completed construction activities

- **Girder setting:** Set girders over Northeast 85th Street for new mainline I-405 northbound and southbound bridges. Set girders for three of six bridges on the middle level for new transit configuration.
- **Bridge supports:** Supports between girders and approaches for the roadway



Girders for new northbound I-405 bridge.

In progress construction activities



Crews preparing for the girders on the I-405 bridge.

- **Mainline I-405 bridges:** Completing northbound bridge deck and placing barriers.
- **I-405 roadway construction:** Completing tie in, prep for northbound and southbound switch of traffic. Placing barrier on left-hand & right-hand shoulders of mainline
- **Deck pours:** New southbound I-405 bridge deck poured. New northbound I-405 bridge deck pours. Weather dependent.
- **Drainage work:** Completing southbound off-ramp drainage work.

Current lane alignment

Northeast 85th Street lanes shifted until 2025



- Crews restriped Northeast 85th Street into a new lane alignment to accommodate I-405 column work.
- Sidewalk path is maintained on north side of Northeast 85th Street.
- Left turn lanes remain same length.
- Will be in place until early summer 2025.

Construction activities

Winter - Spring 2025 Overview



Ongoing: Weeknight single-lane closures of Northeast 85th Street; one lane open in both directions.



March 2025: New lane alignments on I-405 southbound lanes.

Closures are necessary for the safety of the traveling public and to accommodate additional space requirements.

Upcoming construction activities



Southbound traffic lane shift on I-405 to new mainline bridge

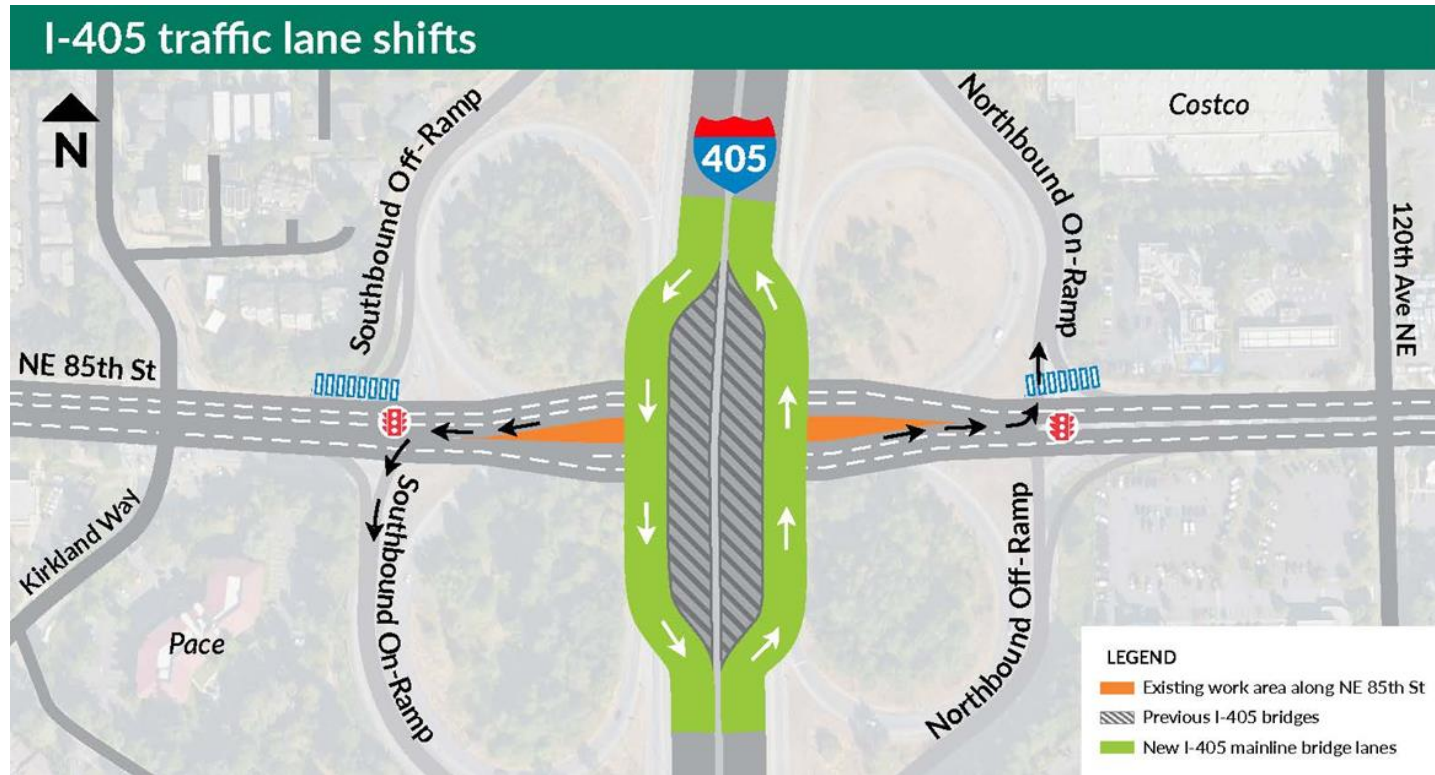

Upcoming construction activities



**Traffic lane shift
on for Northeast
85th Street**

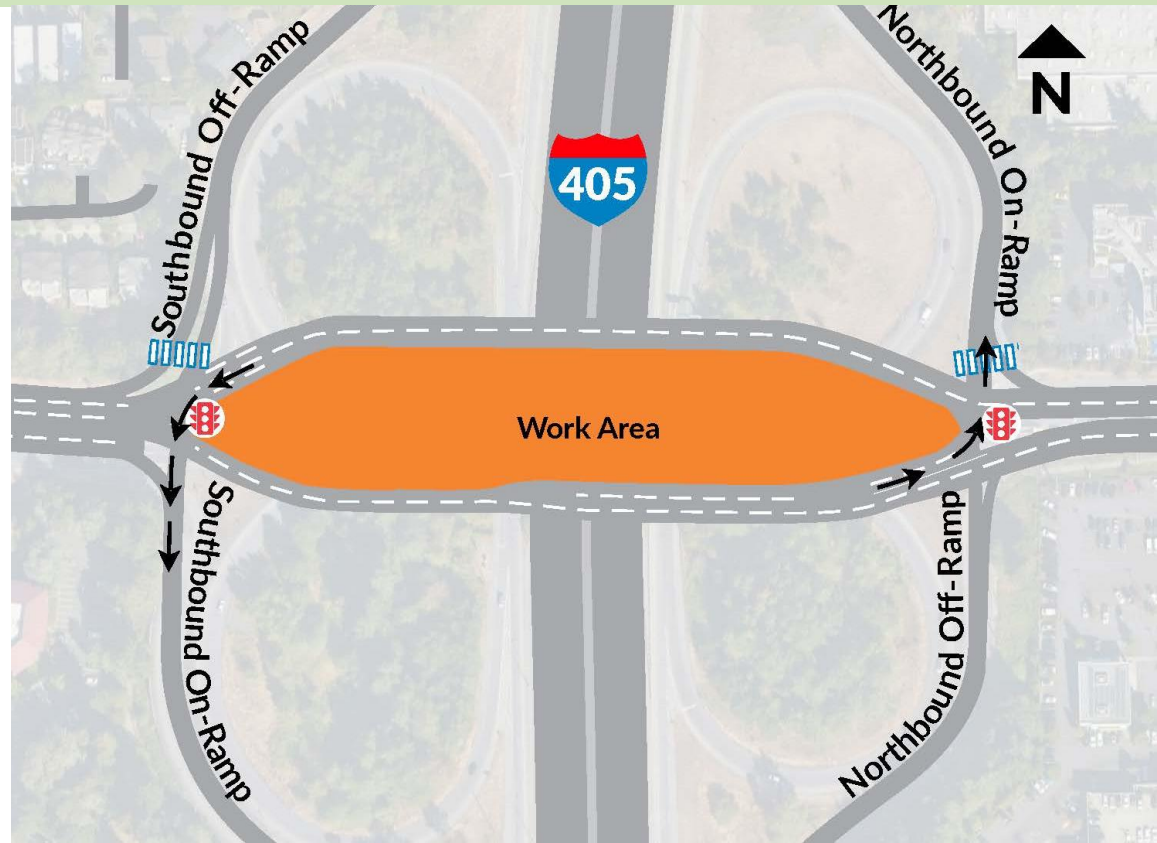

Upcoming City of Kirkland construction

Shared-Use Path

- Builds a connection for bikes and pedestrians from 6th Street
- Project funded primarily by ST3 initiative
- One-year construction (approx) begins this Spring with two lanes closed to traffic for the duration

Eastbound 3rd Lane

- Builds a eastbound third lane becoming a right-turn only lane at 122nd Ave NE
- Night construction expected
- Transportation elements of 3rd lane project funded by ST
- Six-month construction (approx) begins this Spring

www.kirklandwa.gov/capitalprojects

What to expect during construction

- Weekday, weekend, and night work
- Lane closures and reductions
- Northeast 85th Street closures (partial and full closures)
- I-405 ramp closures
- Signed detours and flaggers
- Noise, dust, exhaust, and vibrations



Vector truck crew working near the southbound I-405 off-ramp to Northeast 85th Street.

How we're reducing community impacts

Minimizing noise

- Noisy work is completed during the day unless lane closures are required.
- During night work, noisy work is conducted earlier in the evening shift when possible.
- Equipment is selected for reduced noise levels.
- Vehicles use an ambient backup alarm versus the loud, audible backup alarms.
- All trucks on the night shift have bed liners to reduce impact noise.
- Horn honking for vehicle positioning is prohibited.
- Dumping trucks are prohibited from slamming tailgates while dumping.

Reducing exhaust

- Truck idle times are monitored, and engines must be shut off when not in use.

Lowering light from work zones

- Generators, light plants, and towers are set back from property lines and homes to minimize light and noise impacts on homes.

Stay in touch!

How we're keeping Kirkland informed



- Road signs
- Mailed materials and information
- Briefings, meetings, and pop-up events
- Email and website updates
- Quarterly project updates on Zoom
- Poster and flyer distribution
- Coordination and meeting with businesses near the project site

**Stay informed by
subscribing to email
updates.**

Updates include:

- Closures
- Lane shifts
- Nighttime or other potentially disruptive work
- Changes in work hours
- Construction milestones

I405SR167Program@wsdot.wa.gov

For the most up-to-date travel impacts:

- Visit our real-time travel map:
<http://wsdot.com/travel/real-time>

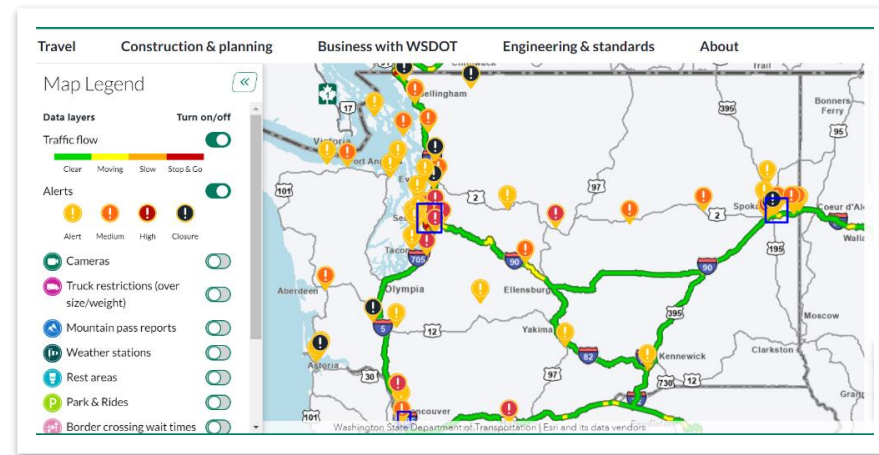

- Download the WSDOT mobile app:
Just type in the term "WSDOT"
in [Google play](#) or [the App Store](#) to
download the WSDOT app.

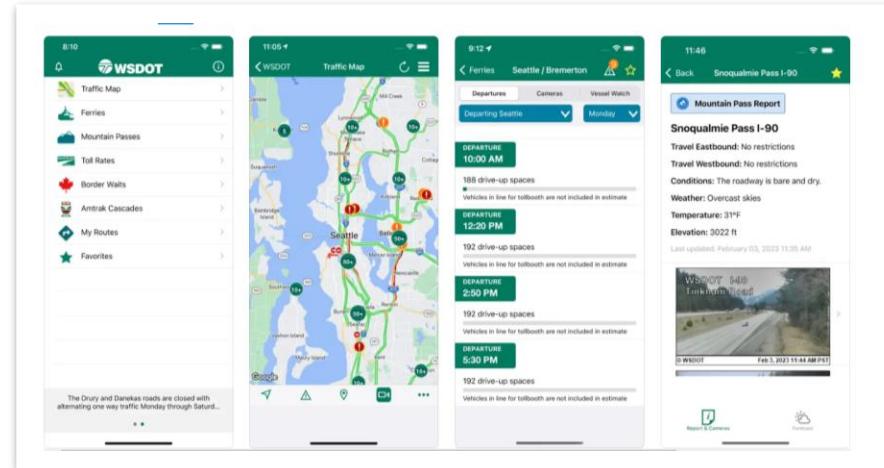

How to stay updated



Email us:
I405SR167Program@wsdot.wa.gov

Email us to be added to the 85th project updates list.



Visit the website:
[**bit.ly/85th-interchange-BRT**](https://bit.ly/85th-interchange-BRT)



Call our construction hotline:
425-224-2423

Monitored weekdays, 8 a.m. – 5 p.m.

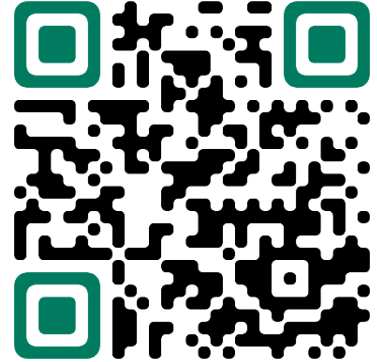

Questions, comments, or concerns?

Submit a question via Zoom Q&A window

- Keep questions focused on this project
- Submit your questions as short, complete sentences
- We will answer as many questions as possible by 1:30 p.m.

Questions specific to an individual situation can be difficult for us to answer now.

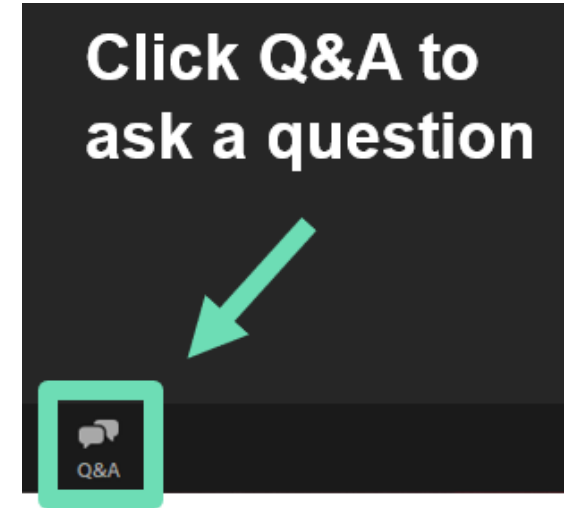

 425-456-8585 (general program info.)
425-224-2423 (project hotline)



I405SR167Program@wsdot.wa.gov



bit.ly/85th-interchange-BRT

The future of Northeast 85th Street

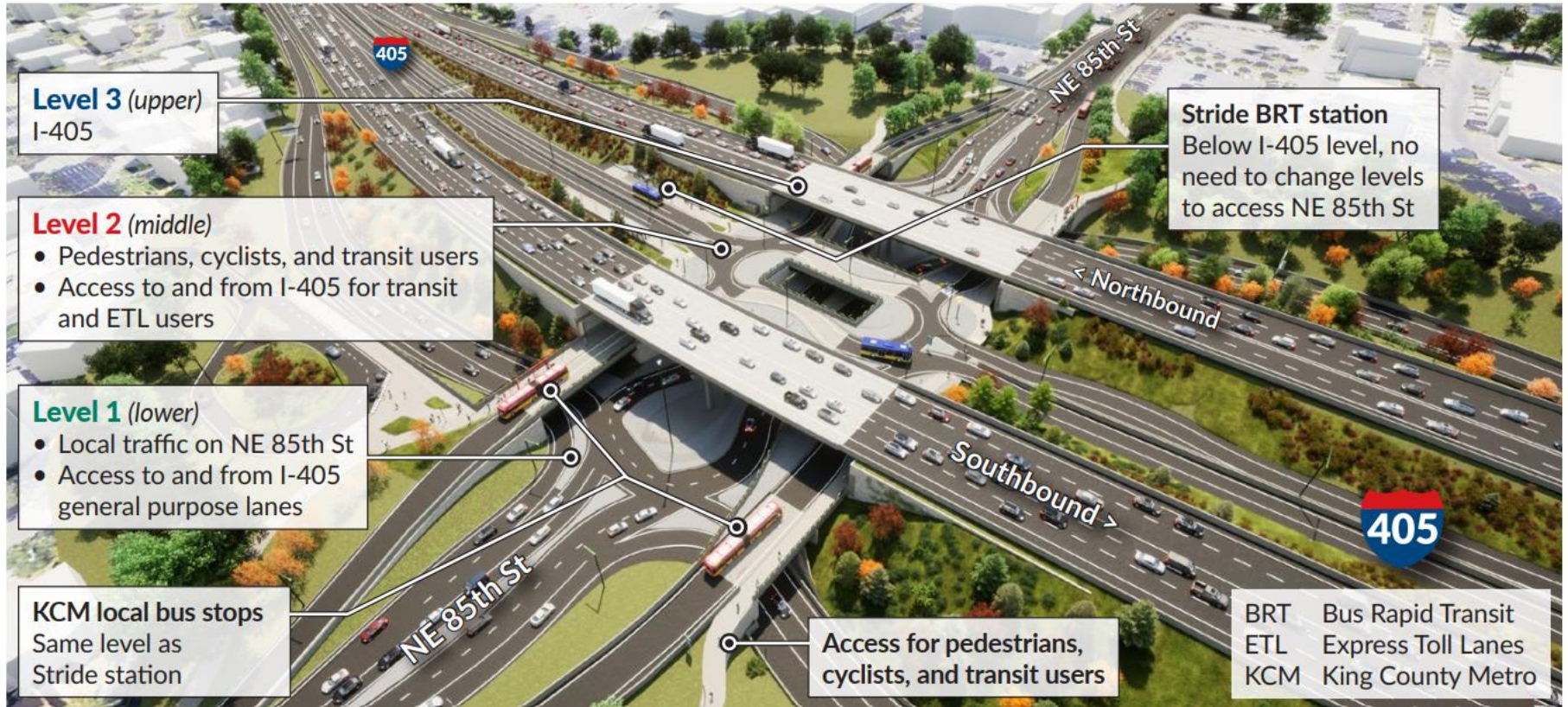

How to stay updated



Email us:

I405SR167Program@wsdot.wa.gov

Email us to be added to the 85th project updates list.



Visit the website:

bit.ly/85th-interchange-BRT



Call our construction hotline:

425-224-2423

Monitored weekdays, 8 a.m. – 5 p.m.

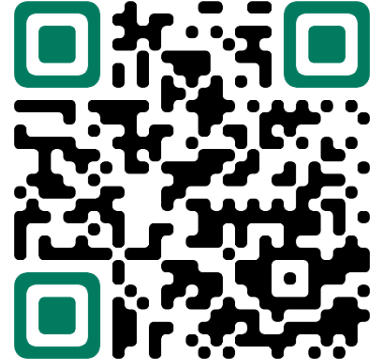

**Thank you for
joining us today!**