

Montlake Project

Monthly Construction Update

Jan. 11, 2023
5:30 p.m. – 6:30 p.m.

Graham Visitors Center
Washington Park Arboretum
2300 Arboretum Dr. East

Major project elements

The Montlake Project will improve transportation for motorized and nonmotorized travel along the SR 520 corridor, including:

- A new eastbound bridge
- Montlake lid
- Bicycle and pedestrian bridge



Illustration of major project elements.



Future westbound exit. (Dec. 12)

Agenda

- Current and upcoming work
- How to stay informed
- Comments and questions



Looking west over the Montlake lid. (Nov. 9)

Building the Montlake lid

In November, crews poured concrete to continue extending the Montlake lid to the east.



Looking west over the Montlake lid. (Nov. 9)

Building the Montlake lid

In January, crews installed 27 girders to construct the west side of the lid. There are 15 additional girders to place in that location. Once complete (in mid-2023), we will shift Montlake Boulevard west to its final configuration.



Girder installation zones.



These girders were installed on the west side of the lid the weekend of Jan. 6 – 9. (Jan. 10)

Retaining wall and soil compaction

This month, crews continue installing a retaining wall and compacting the soil below Lake Washington Boulevard East. Impacts on nearby residents include vibration from soil compaction and nighttime construction noise.



Soil compaction work north of Lake Washington Boulevard. (Oct.20)



View of retaining wall construction north of Lake Washington Boulevard. (Jan.10)

Retaining wall demolition

Earlier this month, crews demolished about seven feet of the retaining wall along Lake Washington Boulevard.



Work zone for retaining wall demolition.



Retaining wall along Lake Washington Boulevard.(Dec.12)

Lake Washington Boulevard berm design

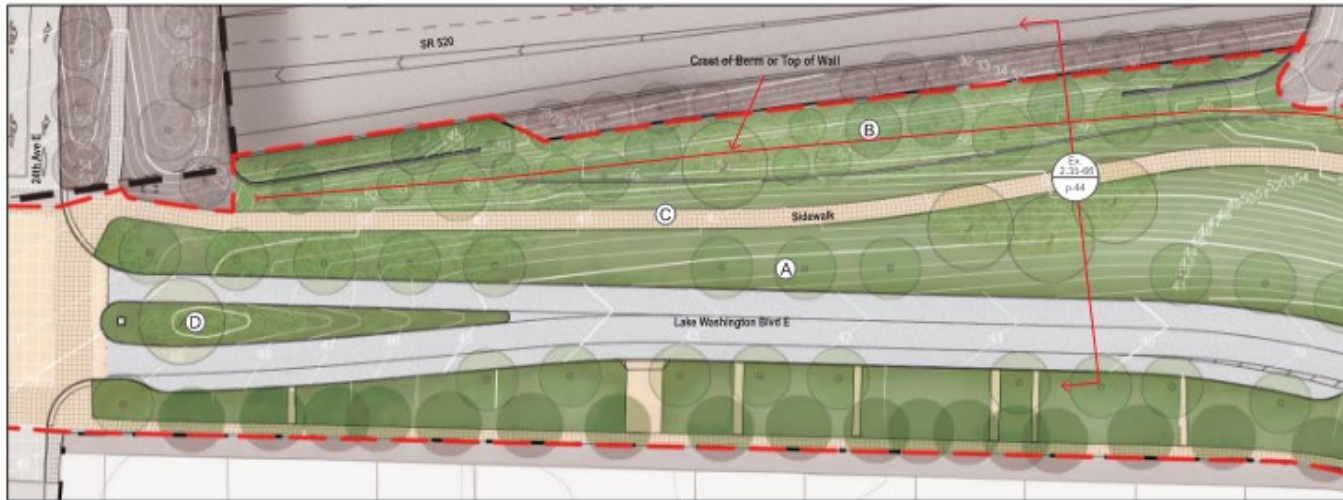

Exhibit 2.35-66: E Lake Washington Blvd east of 24th detail plan

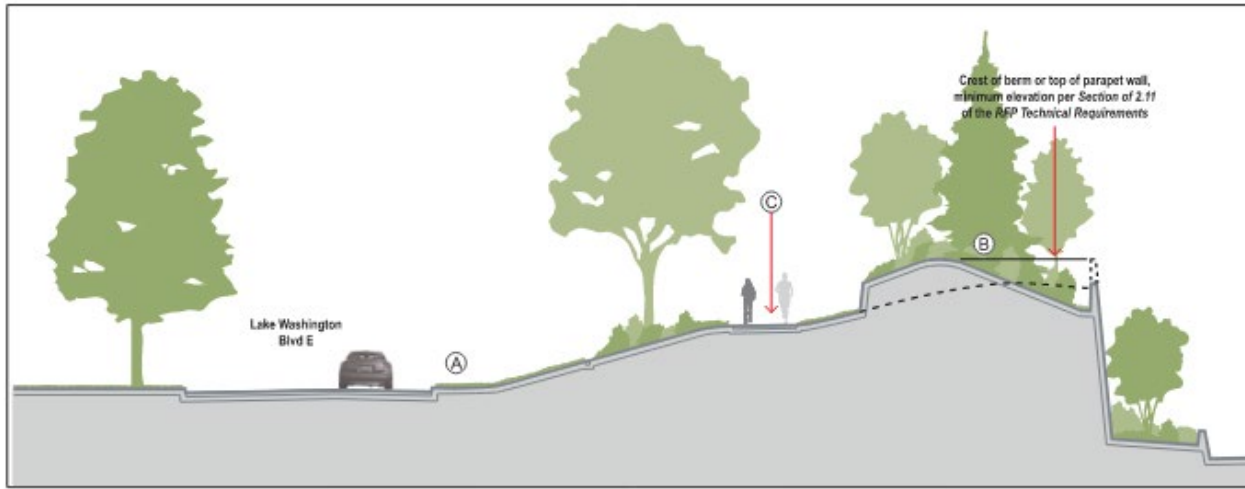

Exhibit 2.35-66: E Lake Washington Blvd east of 24th Ave E section

2018 conceptual drawings from design phase.

The sidewalk along Lake Washington Boulevard will have a buffer from the road and be at a higher elevation.

Bicycle and pedestrian bridge

Crews continue building the support structures for the bicycle and pedestrian bridge across SR 520.

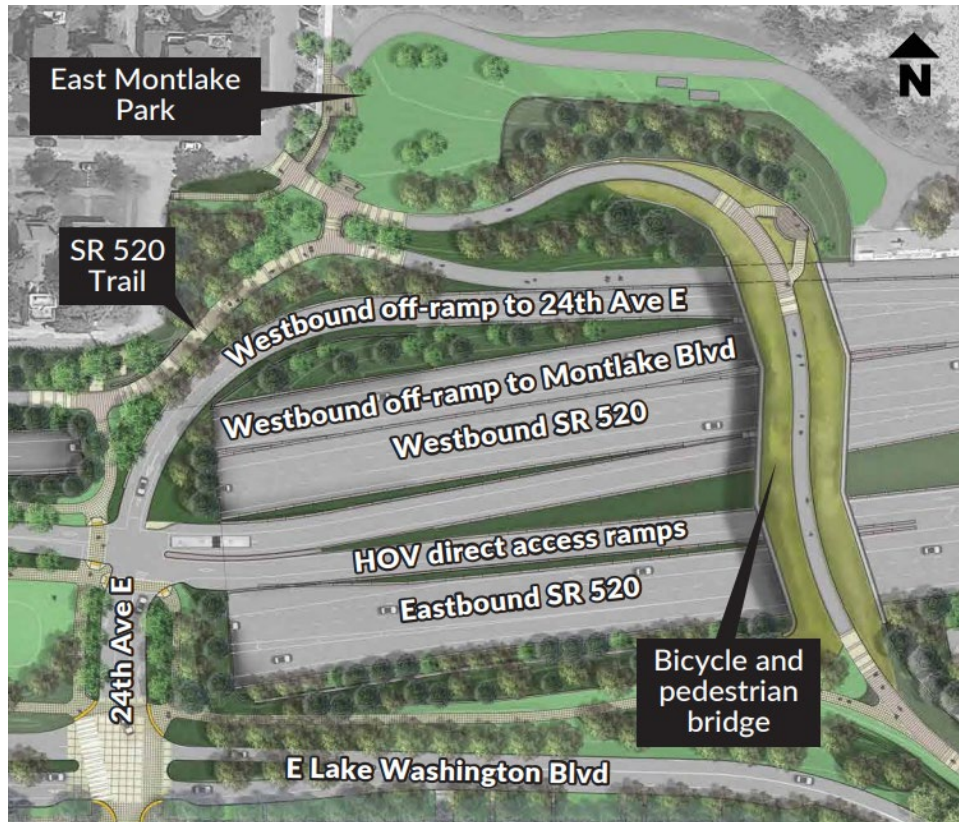

Site of future bicycle and pedestrian bridge. (Nov. 9)

Bicycle and pedestrian tunnel

Construction continues for a tunnel under Montlake Boulevard to connect the SR 520 Trail across Lake Washington to the Bill Dawson Trail. Girders were installed for the tunnel on Dec. 28 and 29.



The roof of the bike and pedestrian tunnel. (Jan. 10)

Bridge construction



*Completed concrete deck paving is the white area.
(Nov. 9)*



*The green re-bar is installed prior to pouring concrete.
(Nov. 9)*

Eastbound SR 520 closed Jan. 13 - 15

Eastbound SR 520 will be closed between I-5 and 92nd Avenue Northeast from 11 p.m. Friday, Jan. 13, to 7 a.m. Sunday, Jan. 15. Crews will pour concrete for the new eastbound bridge.

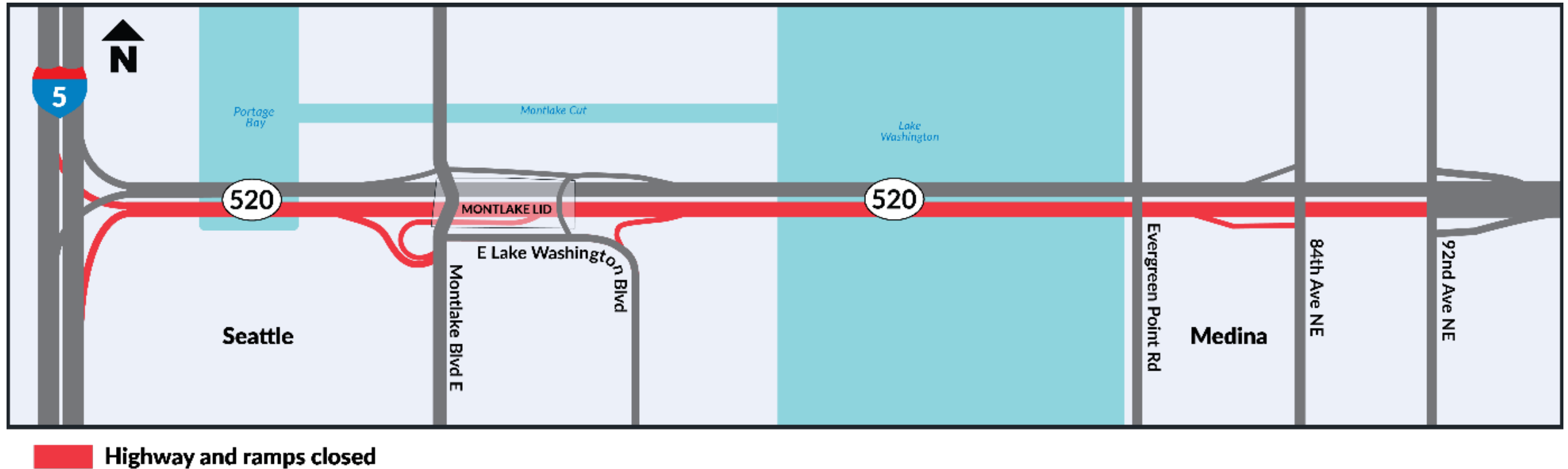

Bridge construction progress

- Casings
- Shafts
- Girders
- Bridge deck

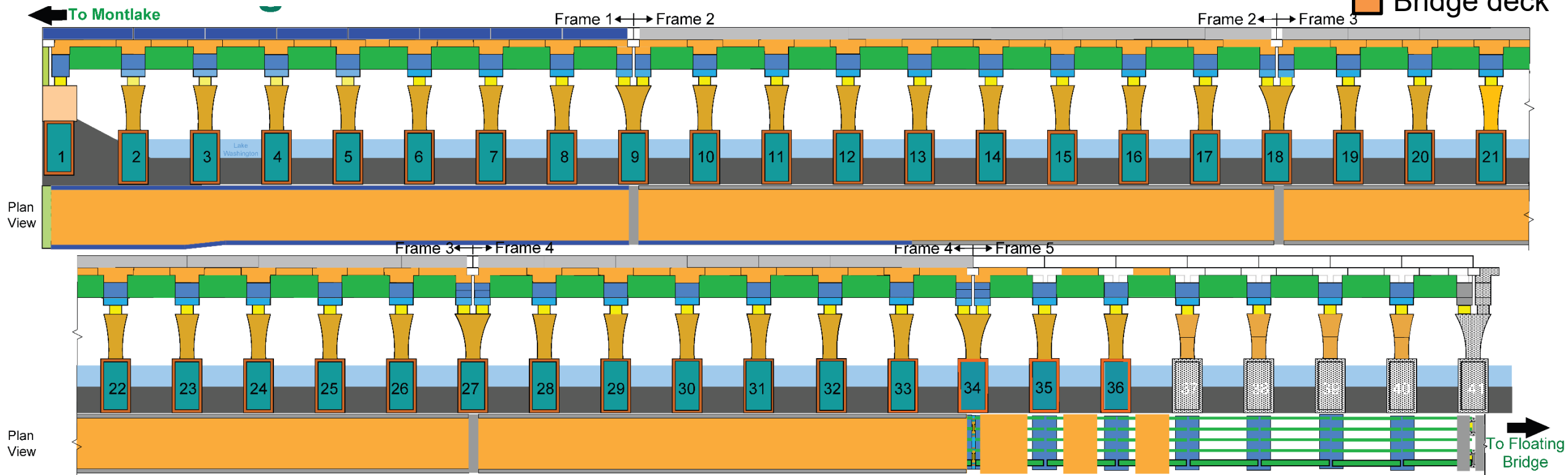

What to expect: Noise and vibration

- Different types of equipment result in different levels and kinds of noise and vibration.
- Electronic noise and vibration meters record levels throughout the project area.
- Vibration monitors collect data in the field and immediately alert the project team when readings are outside the set tolerances.
- Nighttime construction has stricter rules for noise levels and equipment use.
- We've received a Major Public Project Construction Noise Variance (MPPCNV) permitting higher than normal decibel levels between the hours of 10 p.m. and 7 a.m.
- Crews may work 24 hours a day, seven days a week throughout construction.
- Typical work hours for the loudest work:
 - 7 a.m. to 10 p.m. weekdays
 - 9 a.m. to 10 p.m. weekends and holidays
 - Impact pile driving has stricter work hours and will occur:
 - 8 a.m. to 5 p.m. weekdays
 - 9 a.m. to 5 p.m. weekends
- Independent noise monitors will be present for night work to ensure compliance with specified noise levels.

Our 24-hour hotline, **206-775-8885**, is the best way to report noise and vibration concerns and to have questions addressed in the moment.

Visit the SR 520 Construction Corner to view the MPPCNV, read up on the allowable nighttime decibel levels, or read our weekly noise report:
www.sr520construction.com/ManagingConstructionEffects

How to stay informed

- Call our 24-hour hotline: [206-775-8885](tel:206-775-8885)
- Email us with questions: sr520bridge@wsdot.wa.gov
- Visit the Montlake Project website: https://bit.ly/520montlake_program
- Visit the SR 520 Construction Corner to learn more about upcoming construction: www.sr520construction.com
- Follow us on Twitter: [@wsdot_520](https://twitter.com/wsdot_520)
- Sign up to receive our email updates at sr520bridge@wsdot.wa.gov
- Watch construction in “real time” on construction cameras: <http://bit.ly/520cams>
- Participate in our online meetings and events

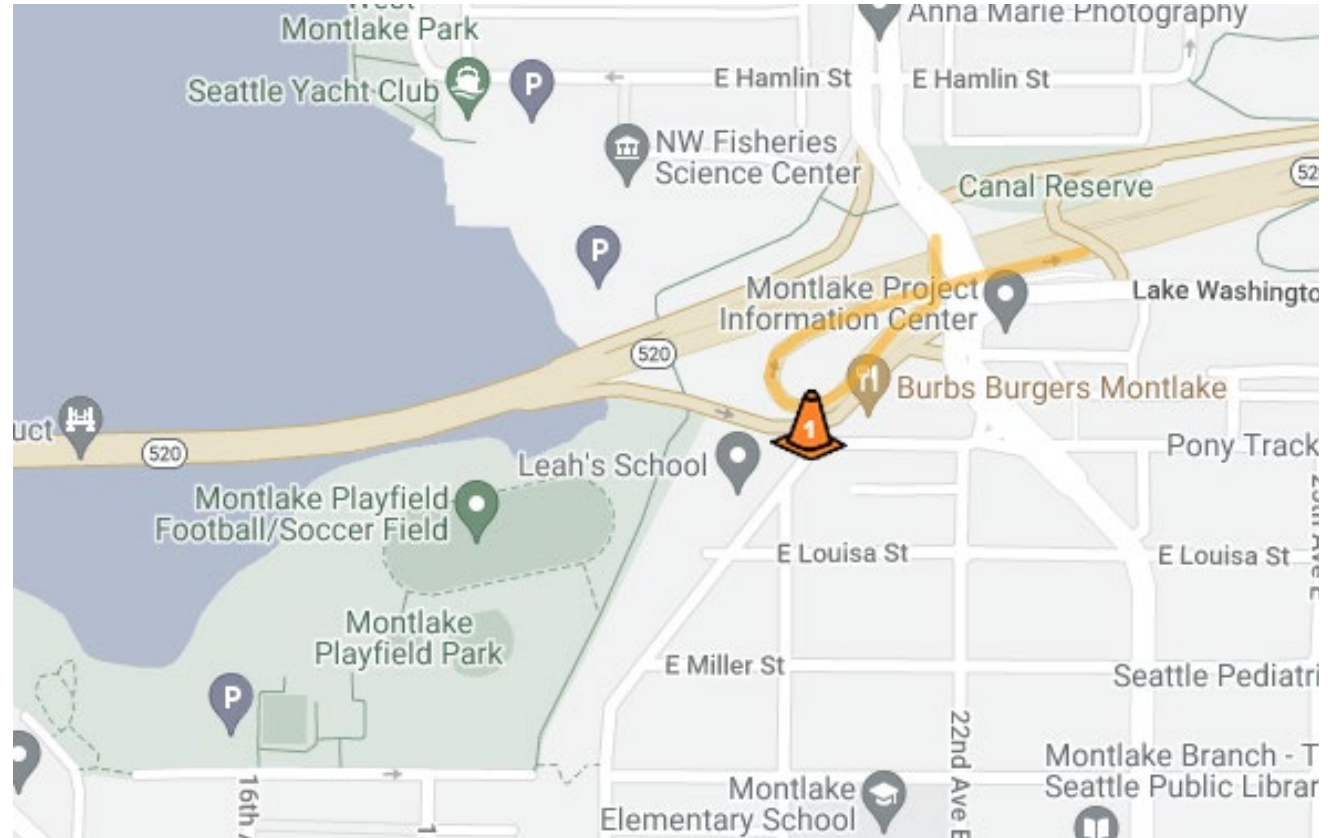

Example of Construction Corner map



Comments and questions?

