

DRAWN BY: LISA CYFORD

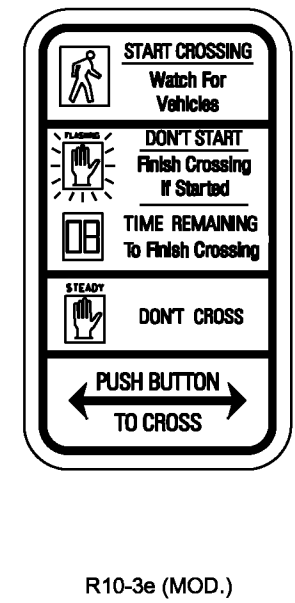

PEDESTRIAN PUSHBUTTON INSTRUCTIONAL SIGN

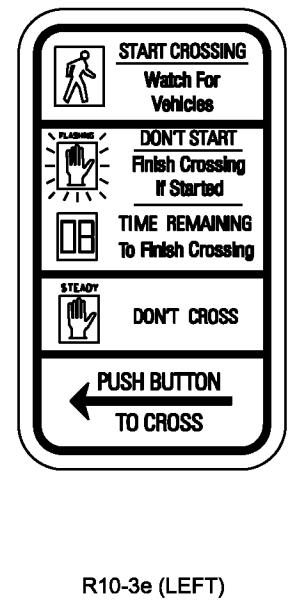
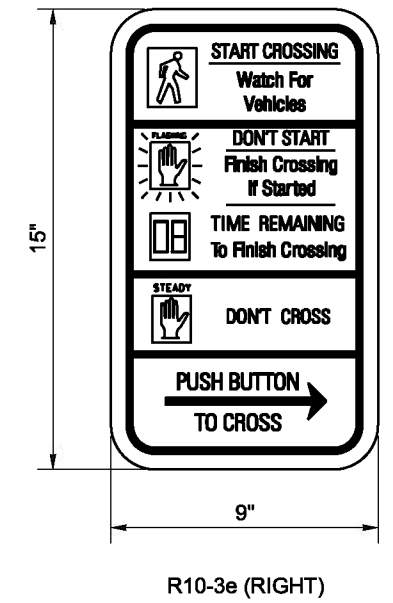
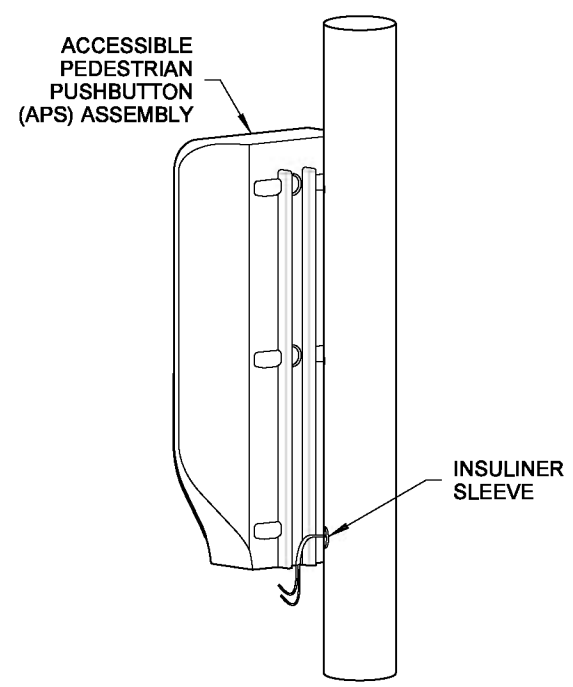
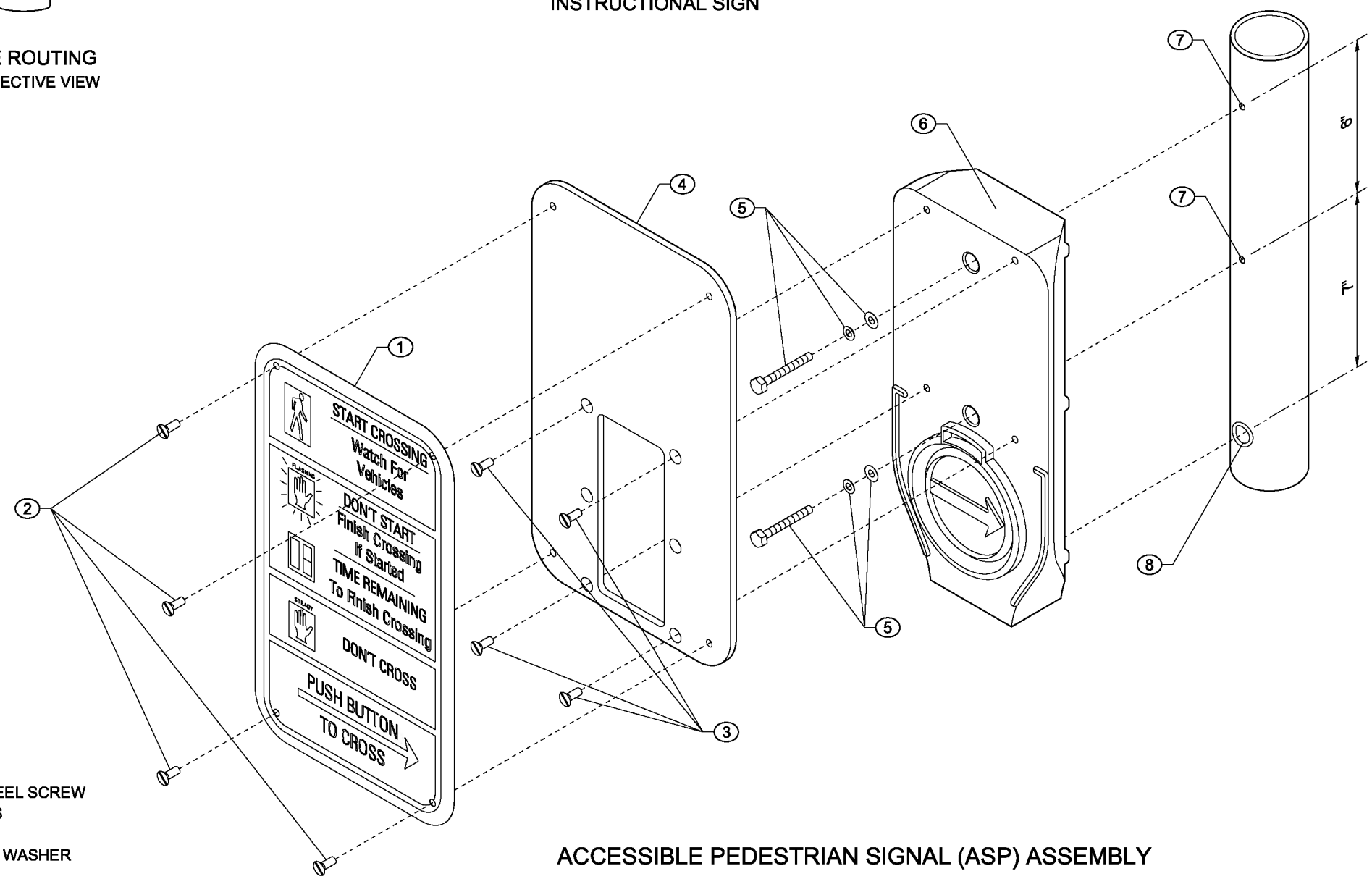
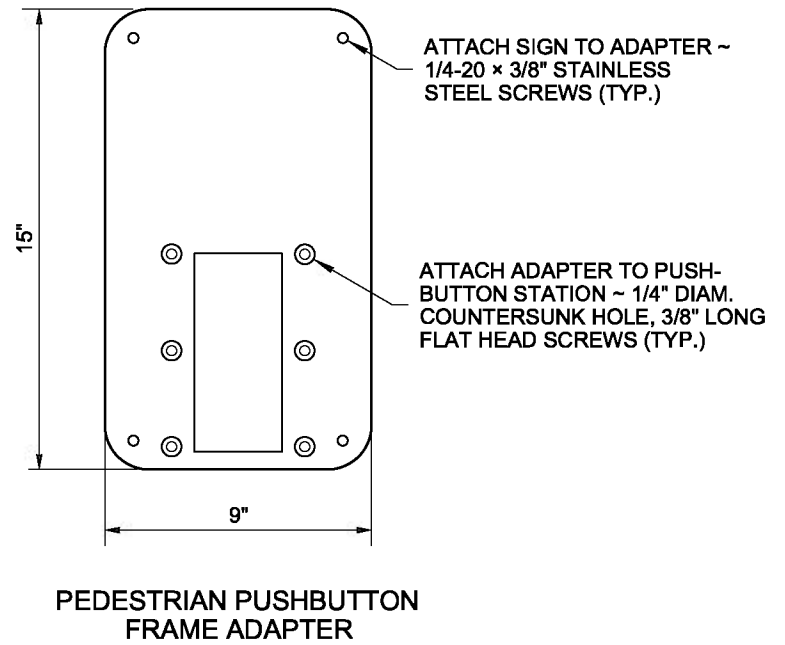

- KEY**
- ① FACE PLATE
  - ② 1/4-20 x 3/8" LONG STAINLESS STEEL SCREW
  - ③ 1/4-20 STAINLESS STEEL SCREWS
  - ④ PUSHBUTTON FRAME ADAPTER
  - ⑤ 1/4-20 STAINLESS STEEL BOLT W/ WASHER AND LOCK WASHER
  - ⑥ PUSHBUTTON STATION
  - ⑦ DRILL AND TAP SHAFT FOR 1/4" DIAM. BOLT
  - ⑧ DRILL AND TAP SHAFT FOR 5/8" WIRE GUIDE HOLE - ADD INSULINER

ACCESSIBLE PEDESTRIAN SIGNAL (ASP) ASSEMBLY  
METAL POLE INSTALLATION  
PPB-M

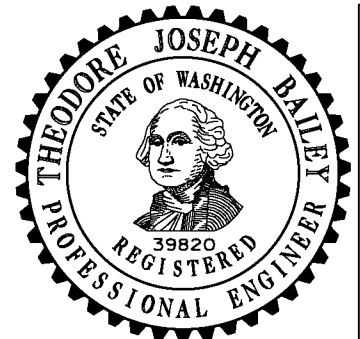
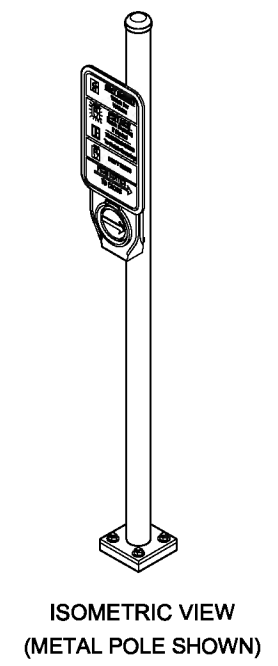

NOTE: THIS PLAN IS NOT A LEGAL ENGINEERING DOCUMENT UNTIL ELECTRONICALLY SIGNED BY THE ENGINEER AND APPROVED FOR PUBLICATION. IT MUST BE FILED AT THE WASHINGTON STATE DEPARTMENT OF TRANSPORTATION. A COPY MAY BE OBTAINED UPON REQUEST.

**ACCESSIBLE PEDESTRIAN PUSHBUTTON (PPB) DETAILS**  
**STANDARD PLAN J-20.26-01**

SHEET 1 OF 2 SHEETS

APPROVED FOR PUBLICATION

**Pasco Bakotich III** 7/12/12  
STATE DESIGN ENGINEER DATE

Washington State Department of Transportation

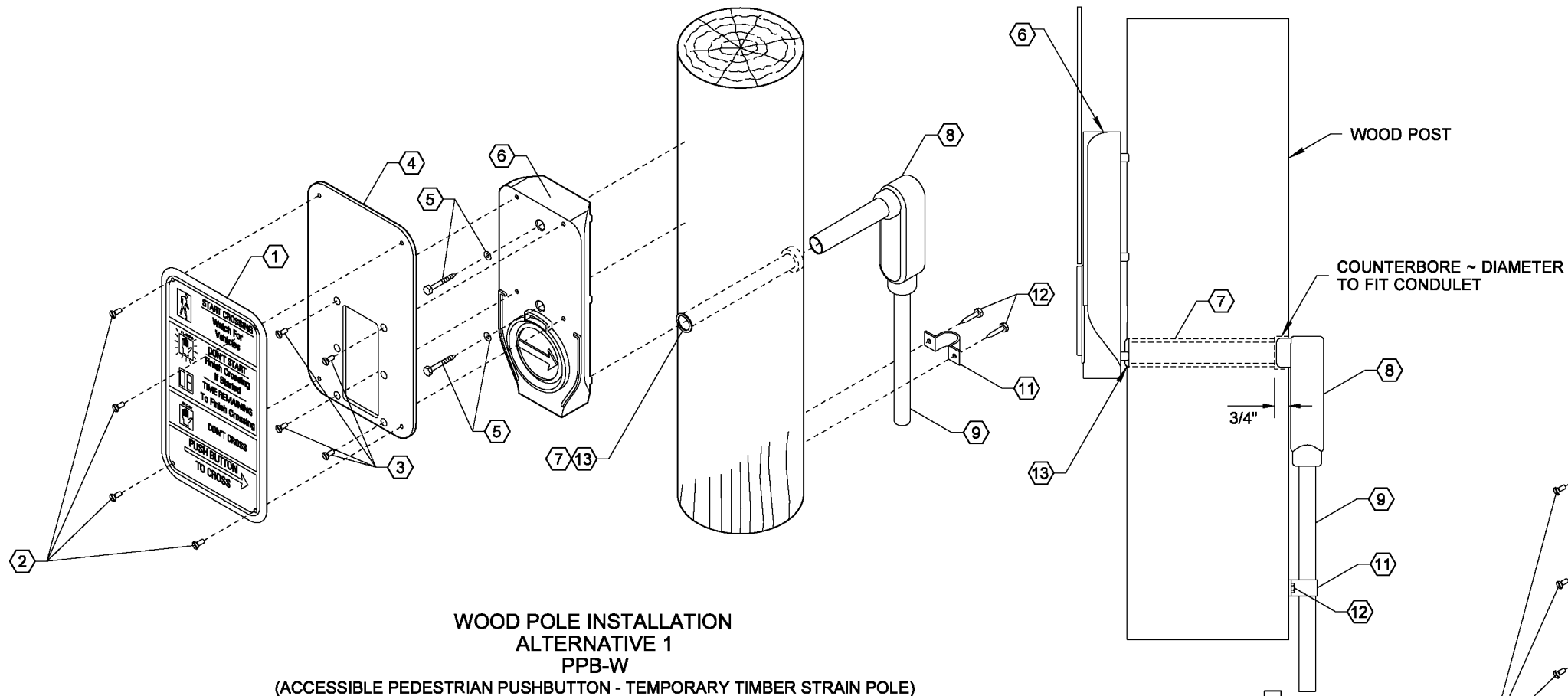

**WOOD POLE INSTALLATION  
ALTERNATIVE 1  
PPB-W**

(ACCESSIBLE PEDESTRIAN PUSHBUTTON - TEMPORARY TIMBER STRAIN POLE)

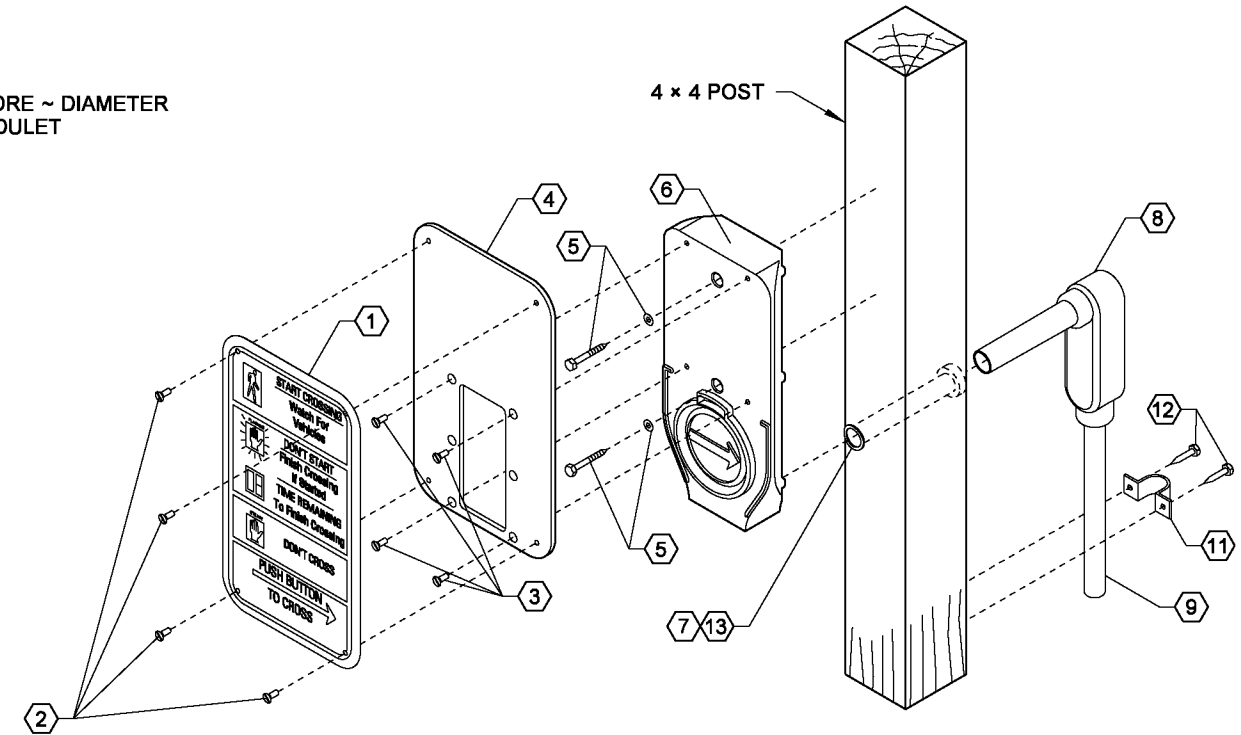

**WOOD POLE INSTALLATION  
ALTERNATIVE 3  
PPB-W**

(ACCESSIBLE PEDESTRIAN PUSHBUTTON - TEMPORARY TIMBER POLE)

INSTALL FITTING WITH NYLON WASHER ON OUTSIDE OF HOUSING  
~ SEAL WITH SILICONE AFTER UNIT IS FULLY ASSEMBLED

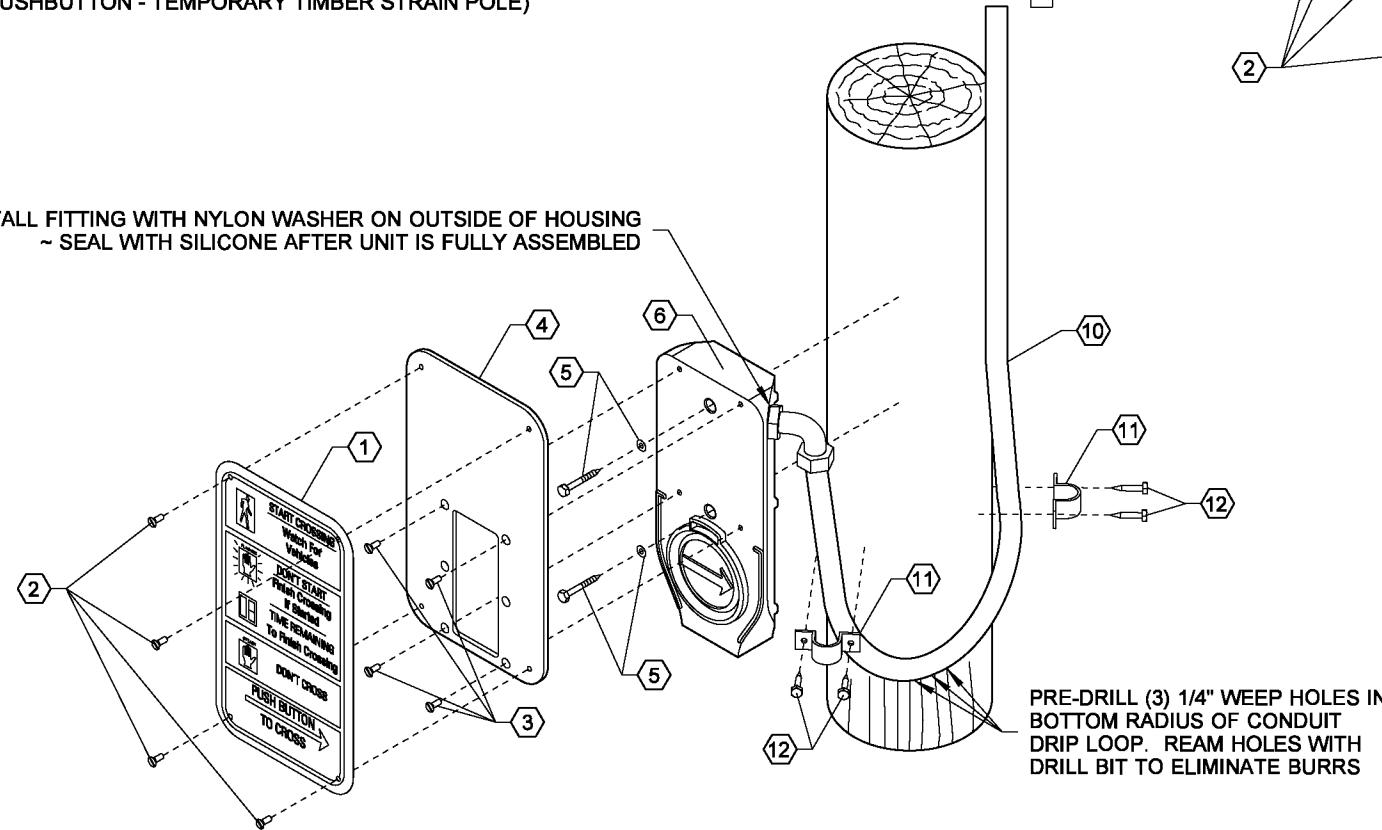

**ACCESSIBLE PEDESTRIAN SIGNAL (ASP) ASSEMBLY**

**WOOD POLE INSTALLATION  
ALTERNATIVE 2  
PPB-W**

(ACCESSIBLE PEDESTRIAN PUSHBUTTON - TEMPORARY TIMBER STRAIN POLE)

**TEMPORARY TIMBER POLE**

**KEY**

- 1 FACE PLATE
- 2 1/4-20 x 3/8" LONG STAINLESS STEEL SCREW
- 3 1/4-20 STAINLESS STEEL SCREWS
- 4 PUSHBUTTON FRAME ADAPTER
- 5 LAG BOLT WITH WASHER
- 6 PUSHBUTTON STATION
- 7 CONDUIT DIAMETER + 1/8" HOLE THRU POLE
- 8 CONDULET
- 9 3/4" CONDUIT
- 10 LIQUID-TITE FLEX CONDUIT
- 11 ONE PIECE TWO HOLE CLAMP
- 12 LAG BOLT
- 13 INSULINER SLEEVE

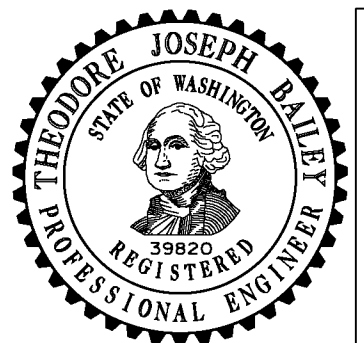

NOTE: THIS PLAN IS NOT A LEGAL ENGINEERING DOCUMENT UNTIL ELECTRONICALLY SIGNED BY THE ENGINEER AND APPROVED FOR PUBLICATION. IT IS THE OBLIGATION OF THE ENGINEER TO FILE AT THE WASHINGTON STATE DEPARTMENT OF TRANSPORTATION. A COPY MAY BE OBTAINED UPON REQUEST.

**ACCESSIBLE PEDESTRIAN  
PUSHBUTTON (PPB)  
DETAILS**

**STANDARD PLAN J-20.26-01**

SHEET 2 OF 2 SHEETS

APPROVED FOR PUBLICATION

**Pasco Bakotich III** 7/12/12  
STATE DESIGN ENGINEER DATE

