

**DETAIL 1**  
1/2 INCH JOINT SEAL AT END OF CONCRETE

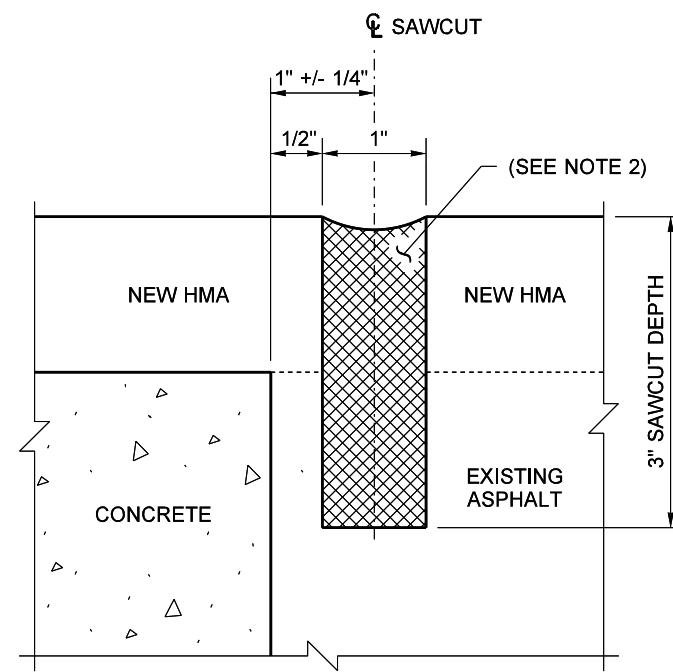

**DETAIL 2**  
1 INCH JOINT SEAL AT END OF CONCRETE

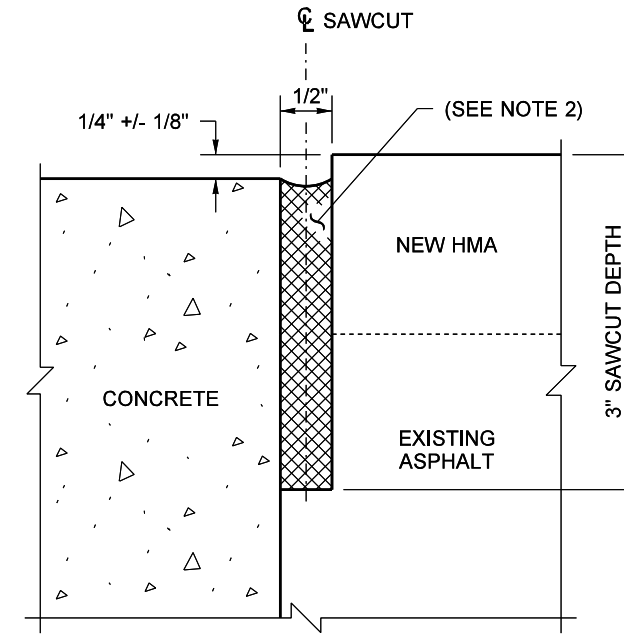

**DETAIL 3**  
1/2 INCH CONCRETE ASPHALT BUTT JOINT

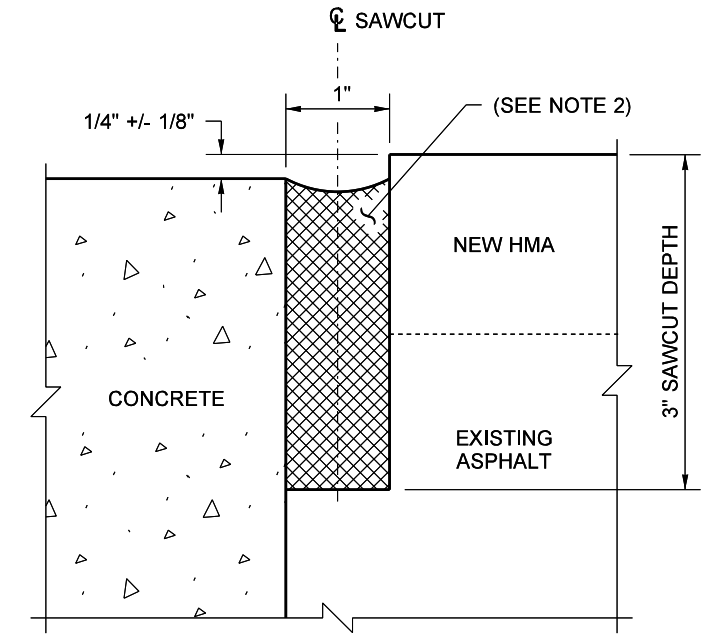

**DETAIL 4**  
1 INCH CONCRETE ASPHALT BUTT JOINT

**NOTES**

1. Use the 1/2 inch joint details for bridges with expansion length less than 100 feet and for bridges with L type abutments. Use the 1 inch joint details for other applications. Use Detail 5 on steel trusses and timber bridges with concrete deck panels.
2. Sawcut shall be as described in **Standard Specification Section 5-05.3(8)** and sealed in accordance with **Standard Specification Section 5-05.3(8)B**.
3. The Contractor shall avoid sawcutting concrete at all locations. For **Details 1** and **2**, the construction tolerance to locate the sawcut is 1/4 inch (0 min. to 1/2 inch max.) from the concrete.
4. For **Details 1, 2, 3, and 4**, the item "HMA SAWCUT AND SEAL" shall be used for payment. For **Details 5 and 6**, the item "PAVED PANEL JOINT SEAL" shall be used for payment. For **Detail 7**, the item "SEALING EXISTING LONGITUDINAL AND TRANSVERSE JOINT" shall be used for payment.

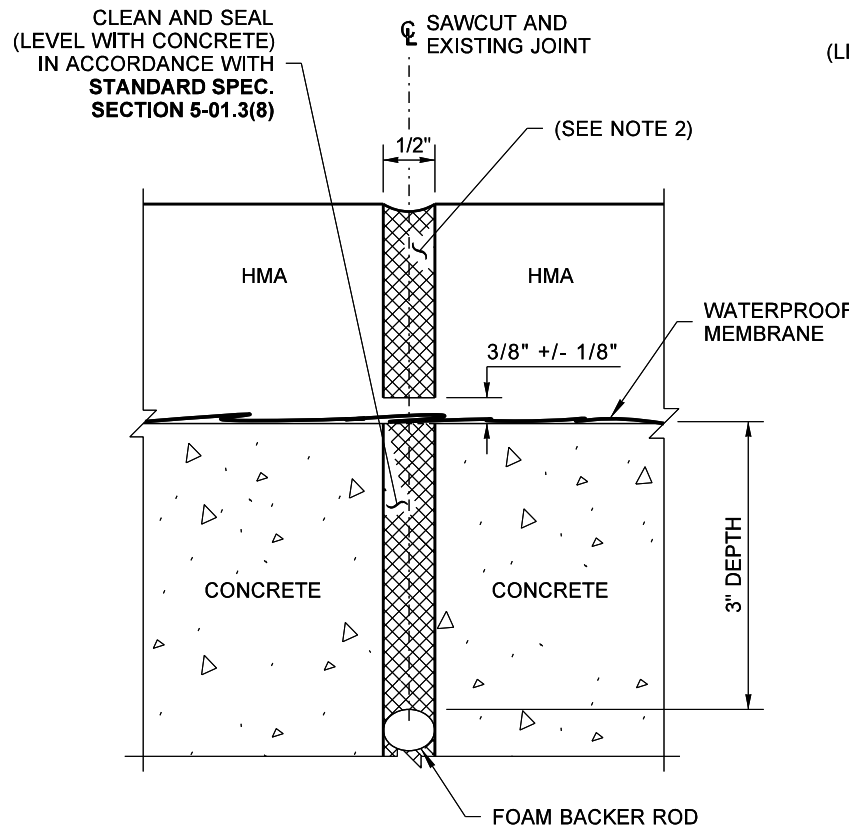

**DETAIL 5**  
1/2 INCH PAVED PANEL JOINT SEAL

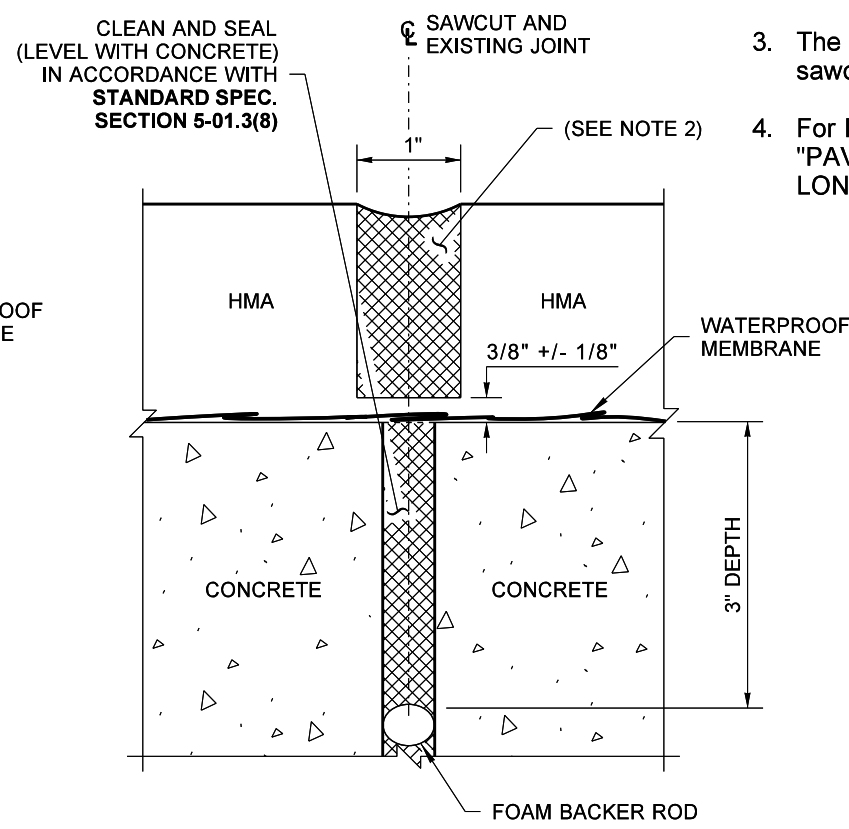

**DETAIL 6**  
1 INCH PAVED PANEL JOINT SEAL

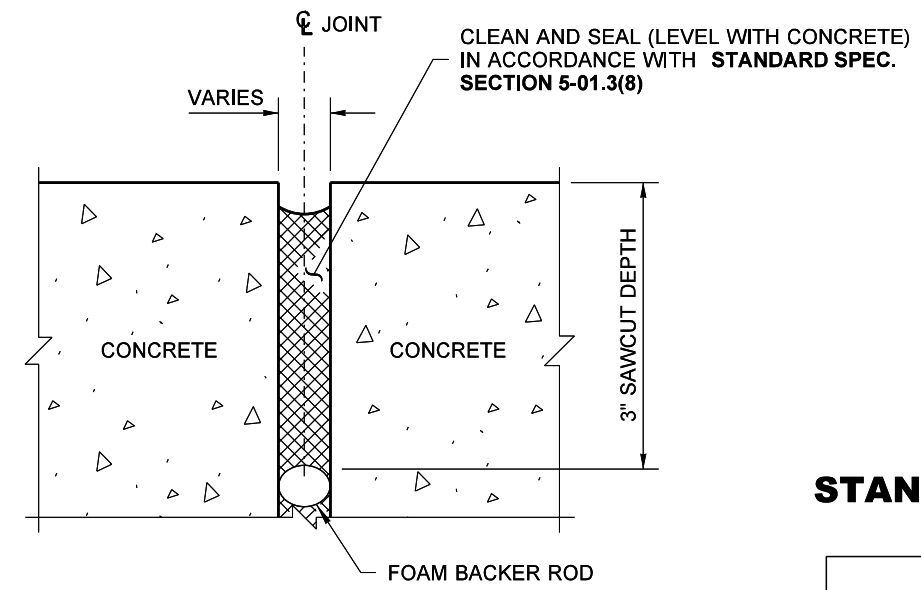

**DETAIL 7**  
CONCRETE OPEN JOINT



**BRIDGE PAVING  
JOINT SEALS  
STANDARD PLAN A-40.20-04**

SHEET 1 OF 2 SHEETS

APPROVED FOR PUBLICATION

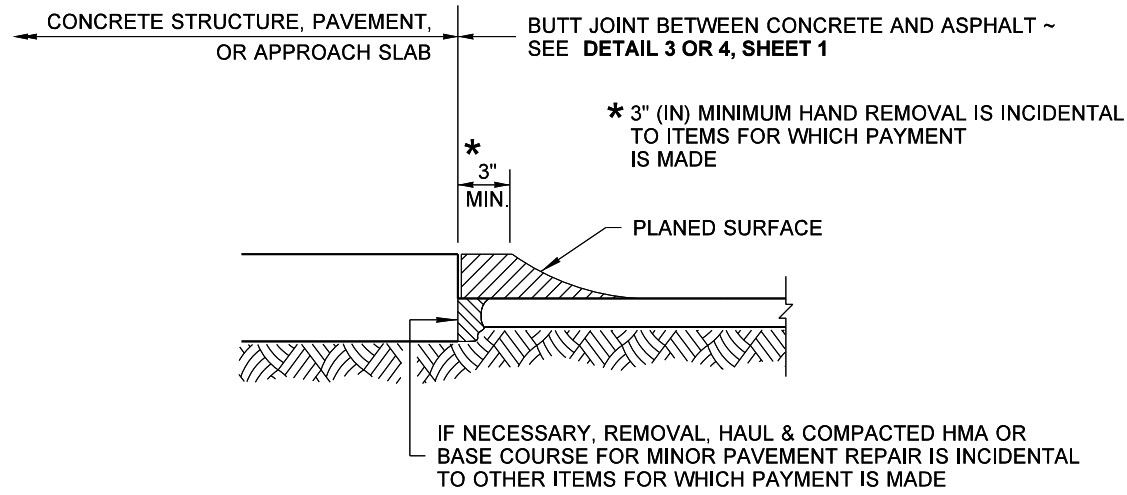

**DETAIL 8**

**CONCRETE TO ASPHALT BUTT JOINT PLANING DETAIL**

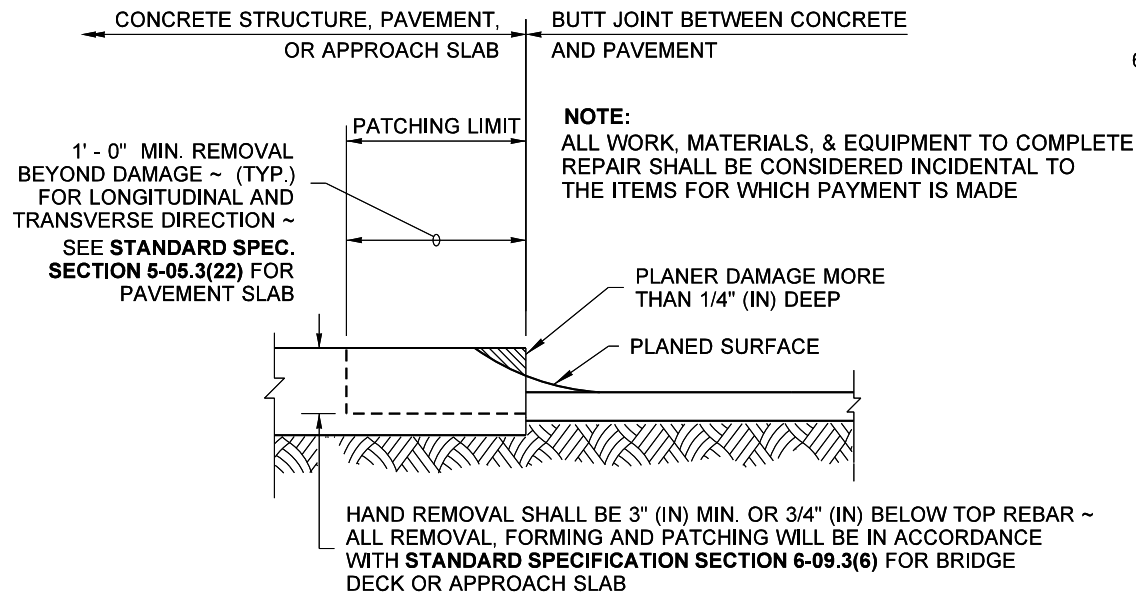

**DETAIL 9**

**PLANER DAMAGE DETAIL**

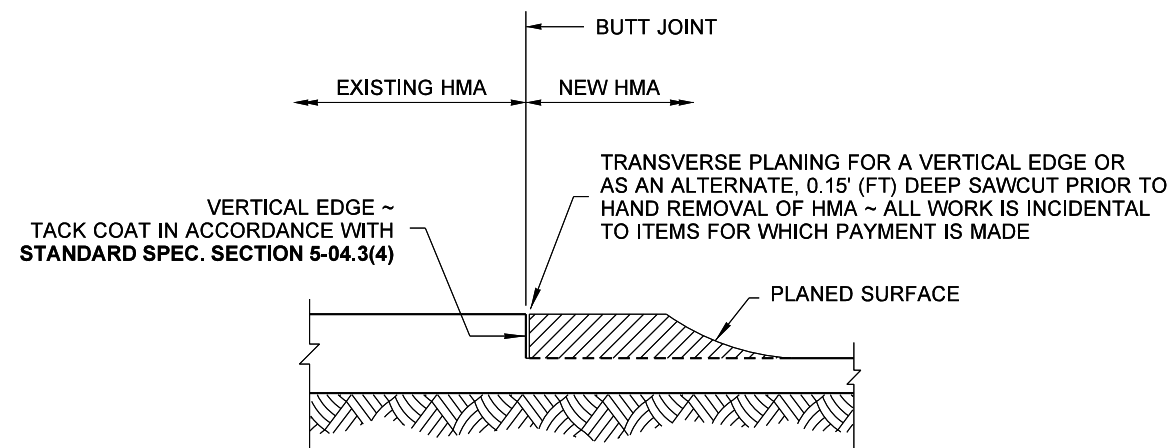

**DETAIL 10**

**ASPHALT BUTT DETAIL (SHOWING VERTICAL EDGE)**

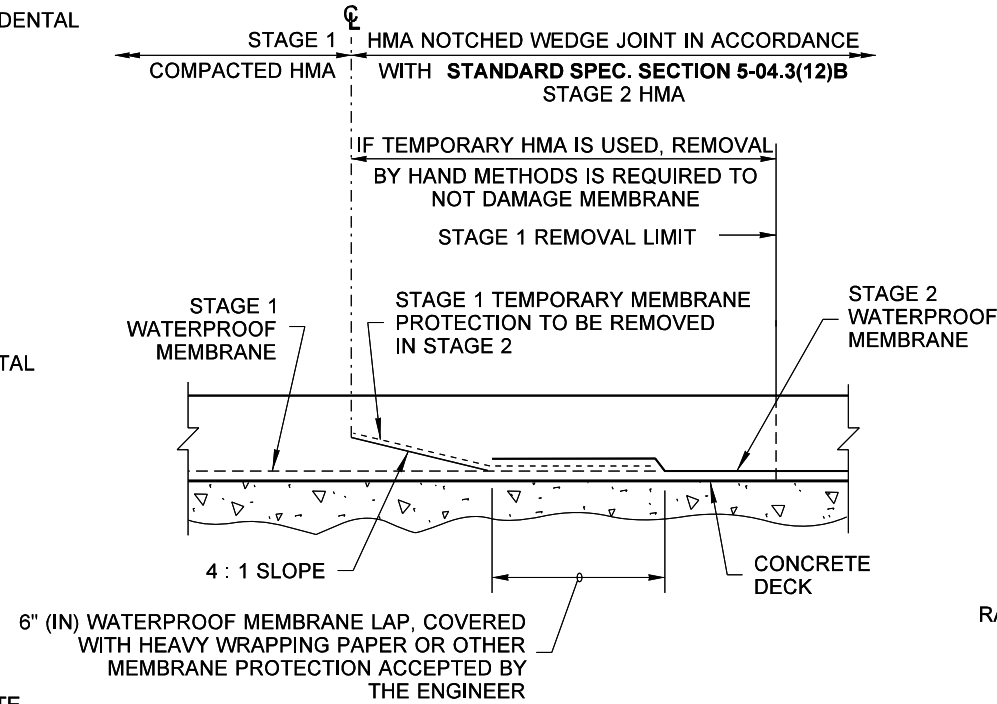

**DETAIL 11**

**LONGITUDINAL PAVEMENT JOINT DETAIL WITH WATERPROOF MEMBRANE**

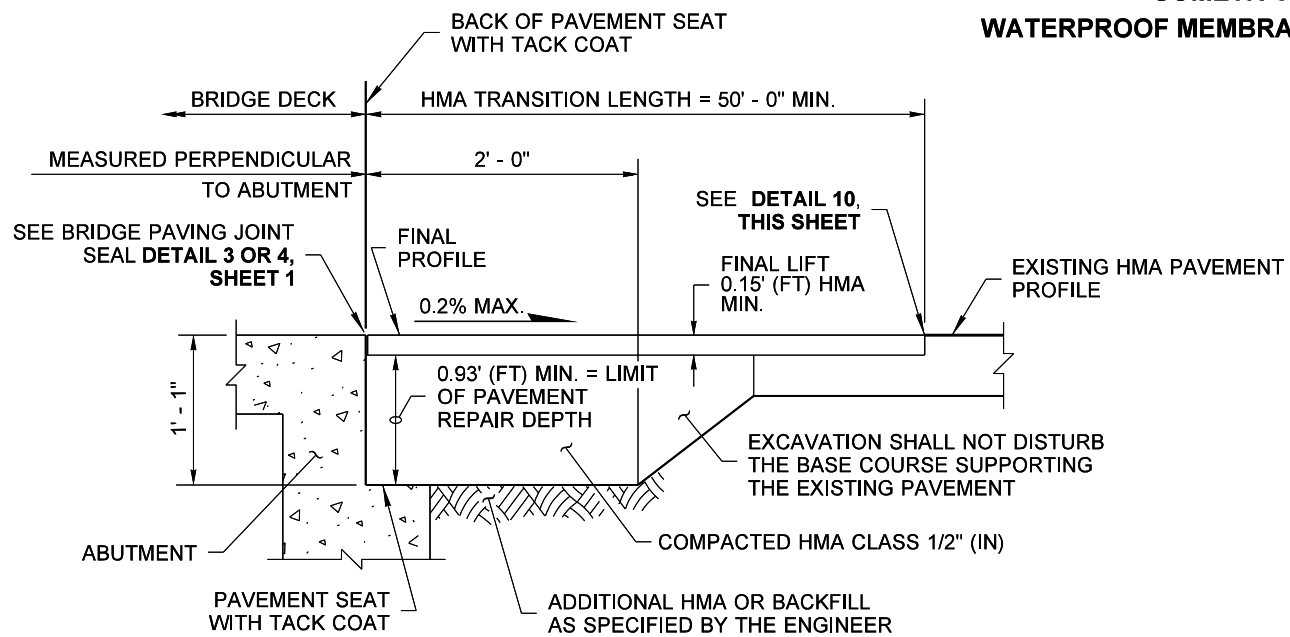

**DETAIL 12**

**PAVEMENT REPAIR AT BACK OF PAVEMENT SEAT (BRIDGE WITH HMA NOT SHOWN)**

**NOTES FOR DETAIL 12: PAVEMENT REPAIR AT BACK OF PAVEMENT SEAT**

1. Final profile grade shall transition per **Standard Plan A-60.30** to the existing profile and use vertical control per **Standard Specification Section 5-04.3(3)C**.
2. The length of pavement repair for measurement and payment is the curb distance, measured along the back-of-pavement seat. Placement will be in accordance with **Standard Specification Section 5-04.3(9)**.
3. Payment for final lift HMA is considered incidental to the item Pavement Repair, unless specified otherwise in the plans.
4. Mix design, design & acceptance is commercial HMA, unless specified otherwise in the plans.
5. Additional backfill up to one (1x) cubic yard is considered incidental to the item Pavement Repair.

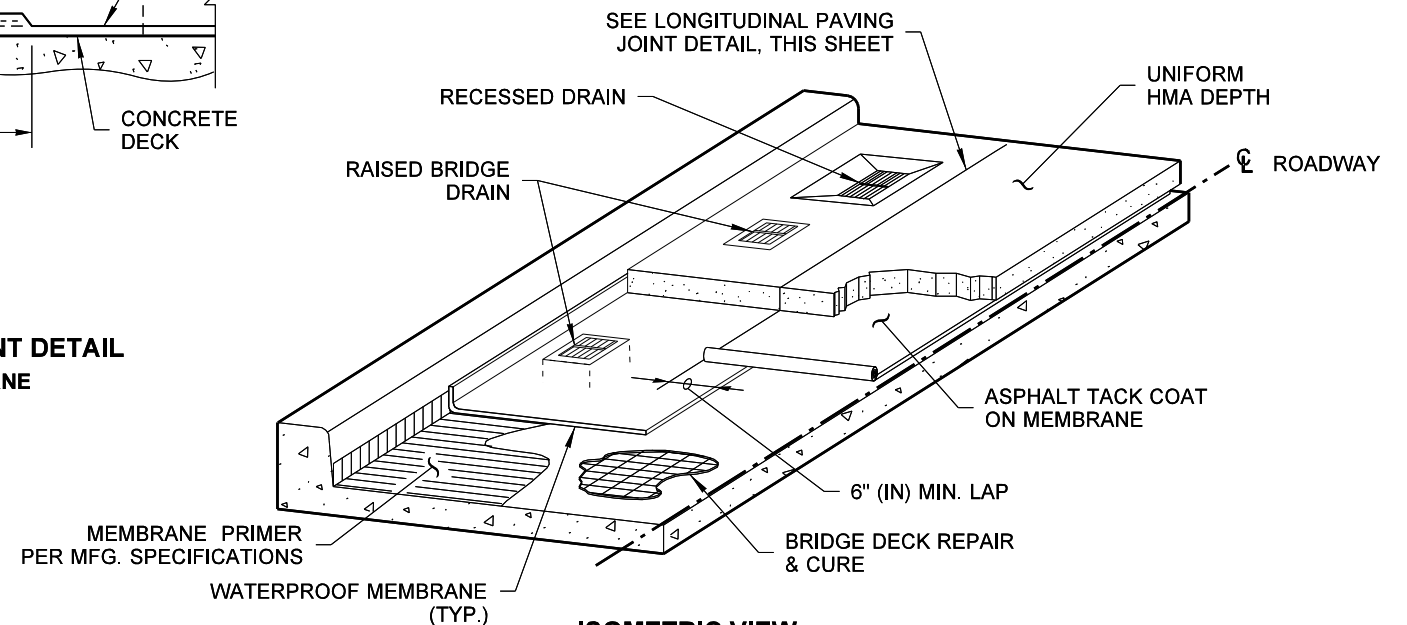

**ISOMETRIC VIEW WATERPROOF MEMBRANE PLACEMENT**



**BRIDGE PAVING JOINT SEALS**  
**STANDARD PLAN A-40.20-04**

SHEET 2 OF 2 SHEETS

APPROVED FOR PUBLICATION