

LAST REVISED: 09/05/2025

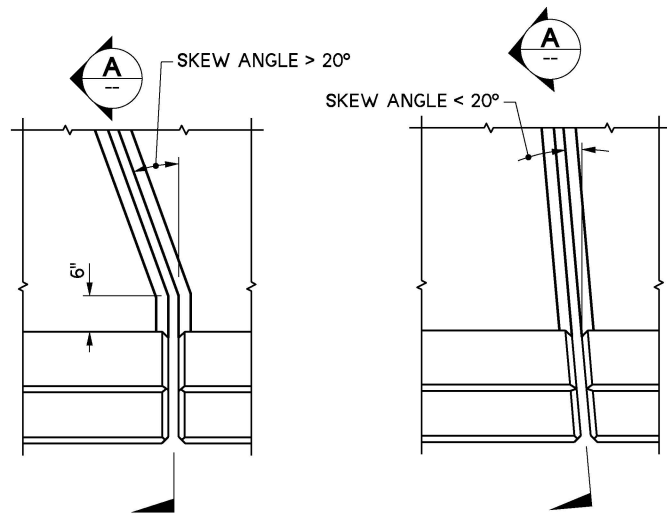

**PLAN - EXPANSION JOINT**

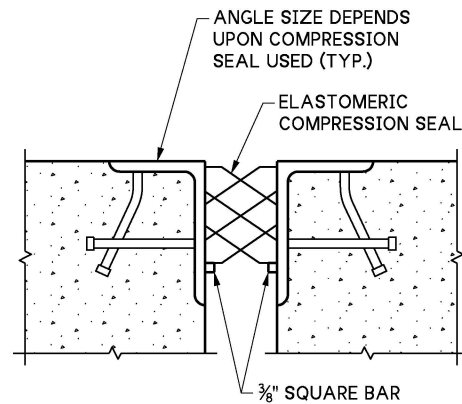

**COMPRESSION SEAL**

ARMORED OPENING.  
USE IN BRIDGE WIDENINGS WITH  
EXISTING ARMORED JOINTS

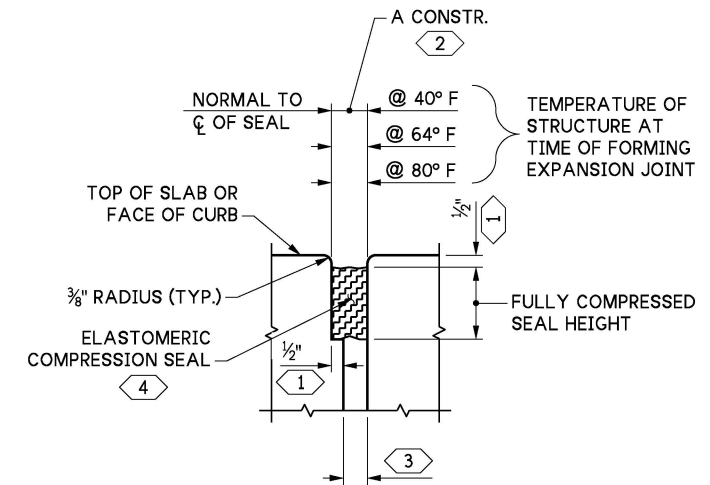

**COMPRESSION SEAL**

CONCRETE OPENING

**NOTE TO DESIGNER:**  
DESIGNER TO USE APPROPRIATE DETAILS  
FROM THIS SHEET AND CONSULT WITH  
EXPANSION JOINT SPECIALIST FOR  
LATEST PLAN SHEET LAYOUT, NOTES,  
AND UP-TO-DATE DETAILS.

- DESIGN NOTES:** (REMOVE THESE AND CORRESPONDING  
FLAGS AFTER DESIGN)
- ① USE 1/2" FOR ALL SEALS.
  - ② COMPUTE "A CONSTR." PER EQUATION (12) @ 40° F, 64° F, AND 80° F.
  - ③ TO BE CHECKED BY THE DESIGNER. SHALL BE LARGE ENOUGH TO  
PREVENT CLOSURE UNDER THERMAL MOVEMENTS.
  - ④ SEE BDM SECTION 9.1.3A AND DESIGN EXAMPLE FOR COMPRESSION  
SEAL DESIGN AND SEE "COMPRESSION SEAL TABLE" ON THIS SHEET.

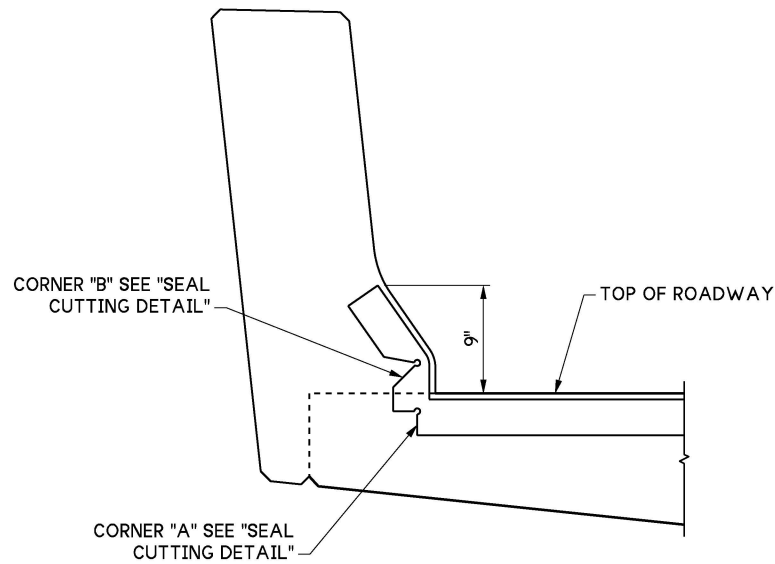

**SECTION A**

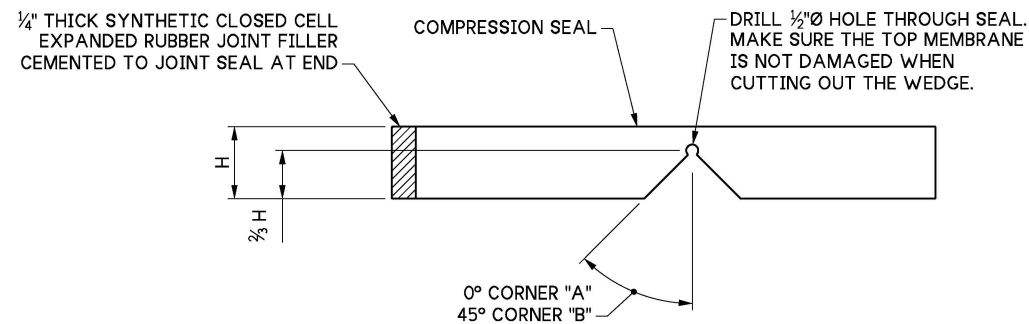

**SEAL CUTTING DETAIL**

**COMPRESSION SEAL TABLE**

D.S. BROWN		WATSON BOWMAN ACME	
SEAL	WIDTH	SEAL	WIDTH
CV-2000	2"	WA-200	2"
CV-2502	2 1/2"	WA-250	2 1/2"
CV-3000	3"	WA-300	3"
CV-3500	3 1/2"	WA-350	3 1/2"
CV-4000	4"	WA-400	4"

**GENERAL NOTES:**

- COMPRESSION SEALS GREATER THAN FOUR INCHES  
WIDE SHOULD NOT BE USED.
- TESTING SHALL BE PER ASTM D2628 PRIOR TO USE  
OF ANY COMPRESSION SEAL.

9.1-A 1-1

FILE NAME	9.1-A 1-1_Compression Seal.dgn		
BRIDGE DES. ENG.			
BRIDGE PROJ. ENG.			
SUPERVISOR			
DESIGNED BY			
CHECKED BY			
ENTERED BY			
PRELIM. PLAN BY			
ARCH. / SPEC.			
	REVISION	DATE	BY

REGION NO.	STATE
10	WASH
JOB NUMBER	
CONTRACT NO.	

**WSDOT**  
PRELIMINARY PLAN  
NOT FOR CONSTRUCTION

SEE  
CERTIFICATION SHEET  
DATE  
STAMP BOX

SEE  
CERTIFICATION SHEET  
DATE  
STAMP BOX

STANDARD DESIGN DRAWINGS  
EXPANSION JOINTS

COMPRESSION SEAL DETAILS

PLAN REF NO  
SHEET  
OF  
SHEETS