

LAST REVISED: 04/15/2025

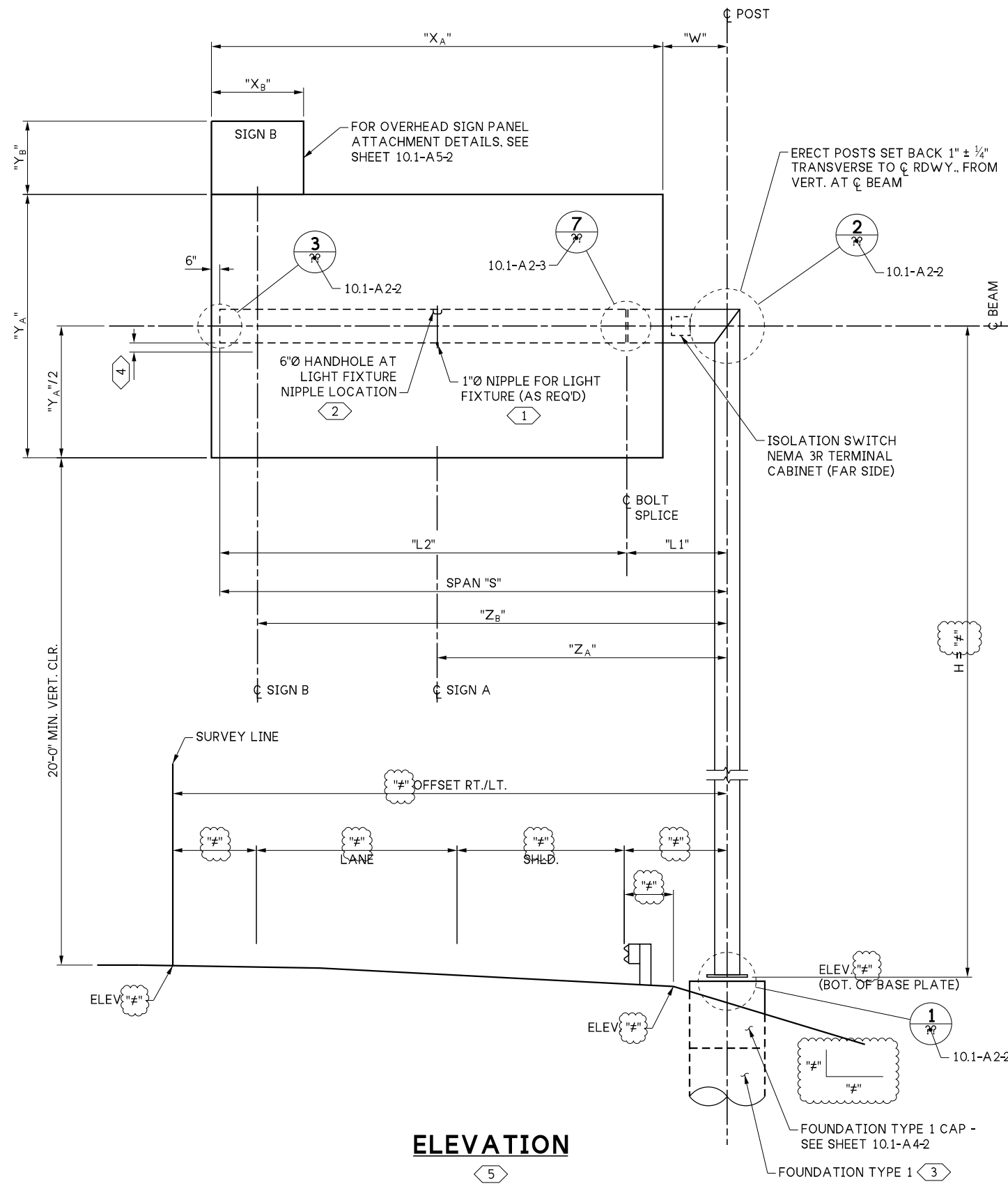

ELEVATION

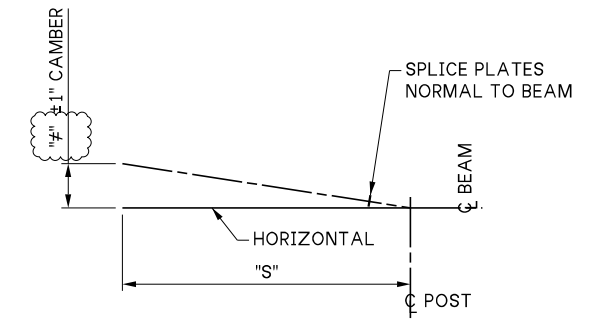

BEAM CAMBER DIAGRAM

NOTES TO THE DESIGNER

- DELETE ALL LIGHTS AND ELECTRICAL DETAILS, CALLOUTS, AND NOTES IF NO ELECTRICAL ITEMS ARE REQUIRED ON THE SIGN STRUCTURE.
- EXISTING ROADWAY LINES DASHED AND NEW ROADWAY IS SOLID.
- ALWAYS SHOW SIGN IN FRONT OF STRUCTURE.
- REMOVE NOTES THAT ARE NOT APPLICABLE.
- "#" IS SHOWN WHERE DIMENSIONS ARE REQUIRED.

KEY NOTES:

- 1 CONTRACTOR TO VERIFY NIPPLE LOCATION TO MATCH LIGHT FIXTURE CONDUIT LOCATIONS. PRIOR TO SIGN STRUCTURE FABRICATION. NO FIELD WELDING OR DRILLING SHALL BE PERMITTED.
- 2 HANDHOLE IS ONLY REQUIRED IF NIPPLE LOCATION IS GREATER THAN 1'-6" FROM ANOTHER HAND HOLE LOCATION.
- 3 SEE SHEET 10.1-A4-1 (FOUNDATION TYPE 2 OR 3 NOT SHOWN. FOR DETAILS SEE SHEET 10.1-A4-3).
- 4 CAMBER MAX. AT END OF SPAN
- 5 CANTILEVER # _ - STA. _____ RT./LT. THE MAXIMUM SIGN AREA ON THIS STRUCTURE SHALL BE _____ SQ. FT. AND $\Sigma(XYZ)$ SHALL BE LESS THAN OR EQUAL TO _____ CU. FT. LOOKING _____ ON STATIONING.

10.1-A2-1

FILE NAME	10.1-A2-1_Monotube Cantilever Layout.dgn		
BRIDGE DES. ENG.			
BRIDGE PROJ. ENG.			
SUPERVISOR			
DESIGNED BY			
CHECKED BY			
ENTERED BY			
PRELIM. PLAN BY			
ARCH. / SPEC.			
	REVISION	DATE	BY

REGION NO.	STATE
10	WASH
JOB NUMBER	
CONTRACT NO.	



SEE CERTIFICATION SHEET DATE	SEE CERTIFICATION SHEET DATE
STAMP BOX	STAMP BOX

STANDARD DESIGN DRAWINGS MONOTUBE SIGN STRUCTURES	PLAN REF NO
MONOTUBE CANTILEVER LAYOUT	SHEET OF SHEETS