



### Please Note:

To ensure both current and historical interchange system information is available to all who utilize the Interchange Drawing Viewer, some of the Interchange Drawing PDF files will display with hand-sketched updates. New hand-sketched files will be added when updated information is received through construction and maintenance channels. New CAD drawings will be added as they are completed. There is currently a five-year backlog on updating the CAD drawings.

If you have questions about updates to the Interchange Drawing, the hand-sketched versions of the drawings, or the Interchange Viewer Web App please email [TransportationGISDataSteward@WSDOT.WA.GOV](mailto:TransportationGISDataSteward@WSDOT.WA.GOV) with Interchange Drawing Feedback or Inquiry in the subject line.

**Continue to the following pages to see the current and historical interchange configurations.**

### *Did you know...?*

- You can download the PDF file to your computer.
- Once downloaded, you can access the layers that compose each drawing through Adobe Acrobat Reader or Pro. NOTE: Layers are not available on hand-sketches.
- [How to download and view Interchange Drawing layers in Adobe Acrobat \(PDF 115KB\)](#)

EFFECTIVE: 2/21/2019

Effective date: *Hiatt*  
02/21/19  
See supplement next page

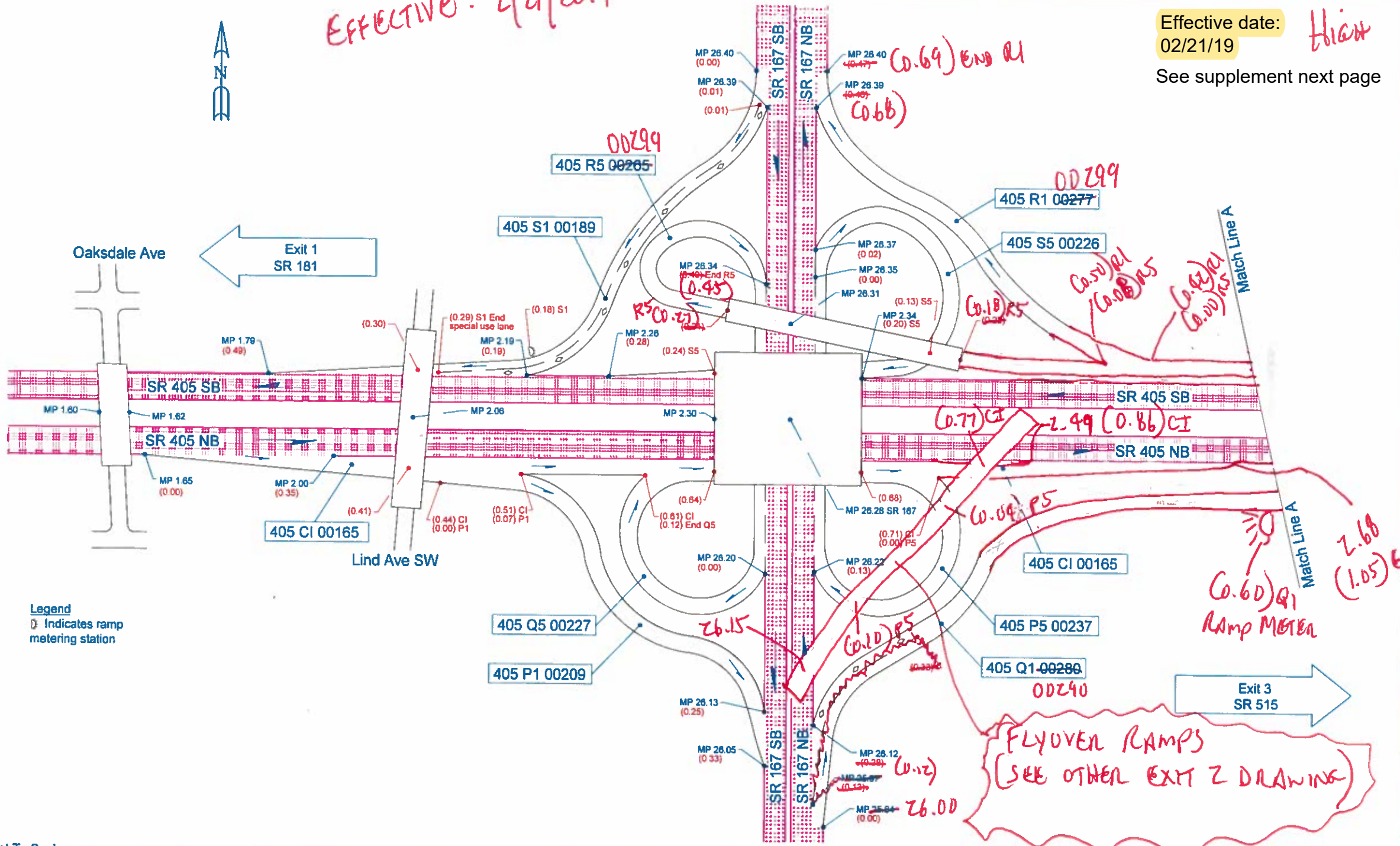

Legend  
☐ Indicates ramp metering station

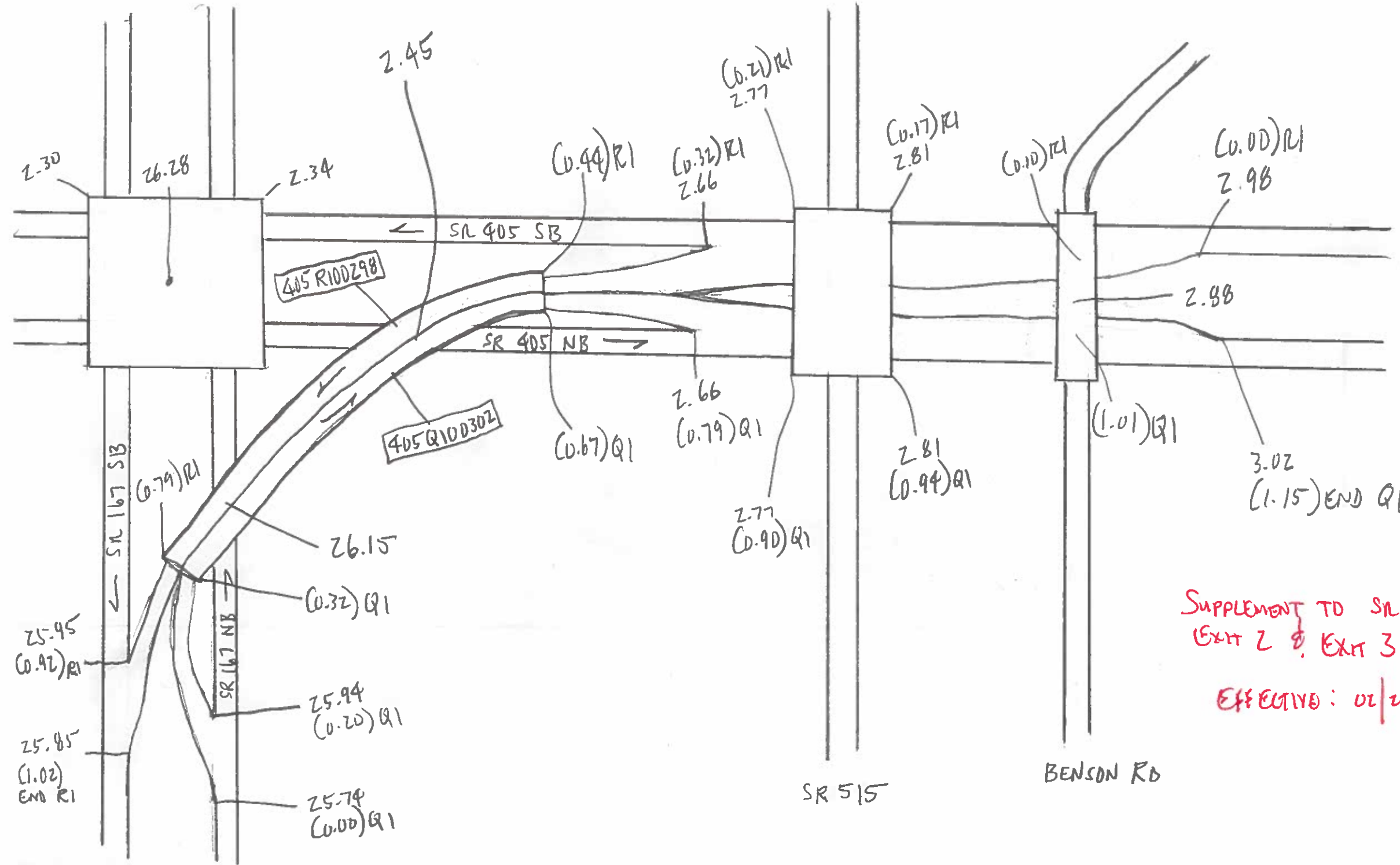

SUPPLEMENT TO SR 405  
EXIT 2 & EXIT 3  
EFFECTIVE: 02/21/2019

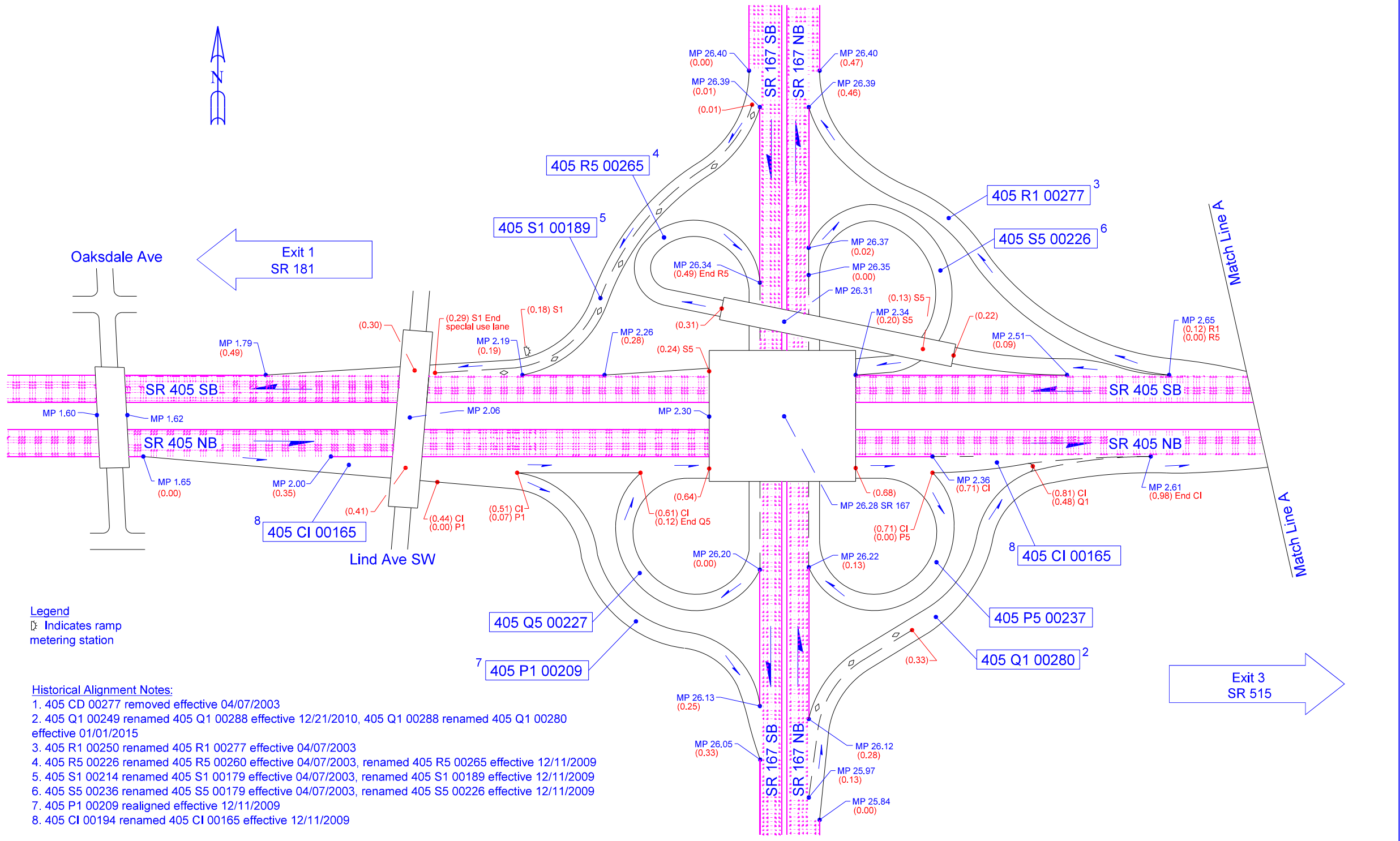

**Legend**  
 ◊ Indicates ramp metering station

- Historical Alignment Notes:**
- 405 CD 00277 removed effective 04/07/2003
  - 405 Q1 00249 renamed 405 Q1 00288 effective 12/21/2010, 405 Q1 00288 renamed 405 Q1 00280 effective 01/01/2015
  - 405 R1 00250 renamed 405 R1 00277 effective 04/07/2003
  - 405 R5 00226 renamed 405 R5 00260 effective 04/07/2003, renamed 405 R5 00265 effective 12/11/2009
  - 405 S1 00214 renamed 405 S1 00179 effective 04/07/2003, renamed 405 S1 00189 effective 12/11/2009
  - 405 S5 00236 renamed 405 S5 00179 effective 04/07/2003, renamed 405 S5 00226 effective 12/11/2009
  - 405 P1 00209 realigned effective 12/11/2009
  - 405 CI 00194 renamed 405 CI 00165 effective 12/11/2009