



# Emergency Bridge Flood Damage Repairs



## Technical Session Agenda

### **Introduction & Response Program (Jim Markus, King County)**

- a. November 2006 King County Flooding
- b. Planning & Response Program
- c. Vicinity Mapping and Emergency Repair Projects

### **Preston Frontage Road Response (Ken Wilson, ISE)**

- a. Flooding Damage at Preston Frontage Road Bridge
- b. Emergency Response Requirements
- c. Construction and Repair Implementation
- d. Bridges Open to Community and Conclusions

**Q&A**

---

Introduction

Planning

Flood Damage

Construction

Bridges Open



# Emergency Bridge Flood Damage Repairs

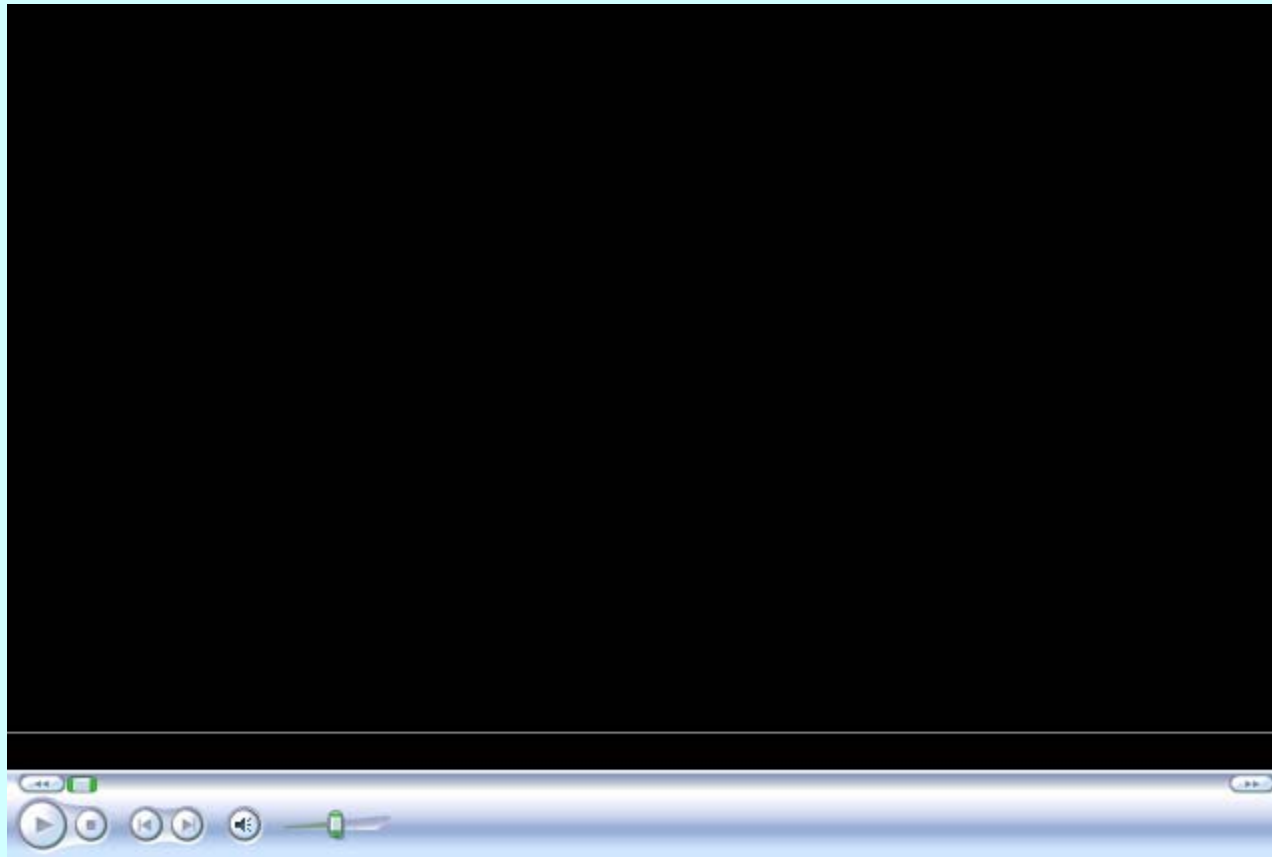
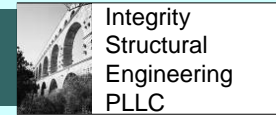



# Emergency Bridge Flood Damage Repairs

## Response to Bridge Structure Flooding Emergency

- **Bridge Pre-Flood Planning**

- ✓ Creation of Flood Watch Listing of Bridges
- ✓ Assignment of Inspection Responsibilities
- ✓ Emergency Contact Succession
- ✓ Organized Inspection Plan
- ✓ Contact Listing for Utilities, Fire, & Safety
- ✓ Implementation of Risk Reduction Activities



# Emergency Bridge Flood Damage Repairs

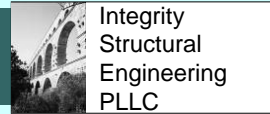

## Response to Bridge Structure Flooding Emergency

- Emergency Response to Flood Hazard
  - County Flood Warning System
  - Monitor USGS Stream Gauges
  - Inspection of Critical Bridges on Flood Watch
  - Automated data Sharing via “*E-Track*”
  - Immediate Response from On-Call Consultant
  - Immediate/Timely Response to Public
  - Initiating Emergency Construction Contracts



# Emergency Bridge Flood Damage Repairs



## King County Bridge Flood Planning

- **Bridge Flood Hazard Management**
  - King County Surface Water Design Standards
  - Avoid Creation of New Bridge Flood Risks
  - Protect & Enhance Aquatic and Riparian Habitat
  - Routine ( Biennial or Annual) Scour Inspections
  - Underwater Inspections every 5 years (max)
  - Map Upstream and Downstream Channel
  - Comparative Analysis of Streambed Stability



King County

# Emergency Bridge Flood Damage Repairs

Integrity  
Structural  
Engineering  
PLLC

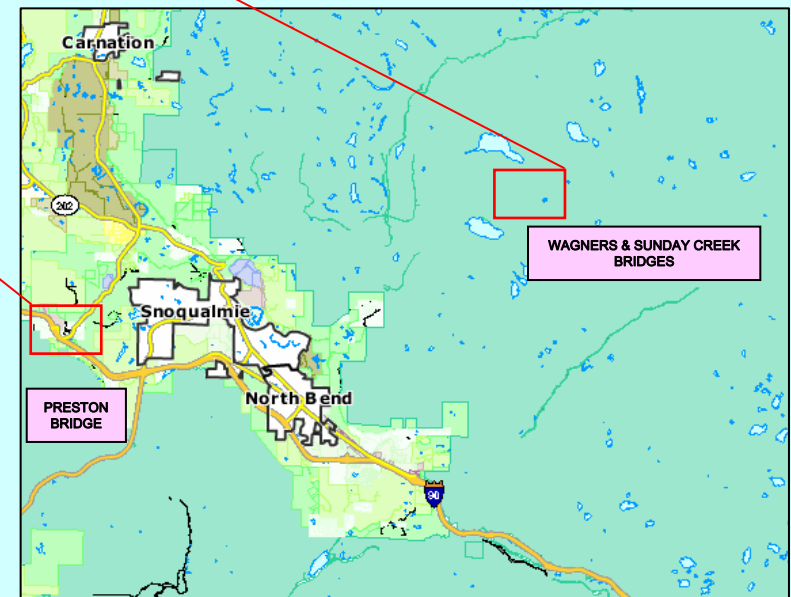
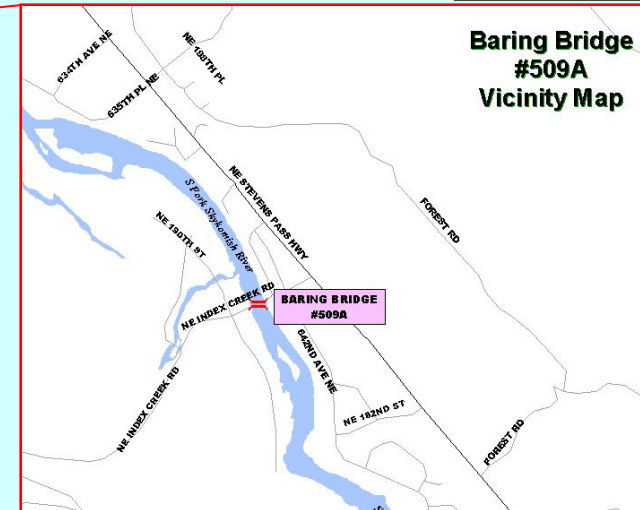
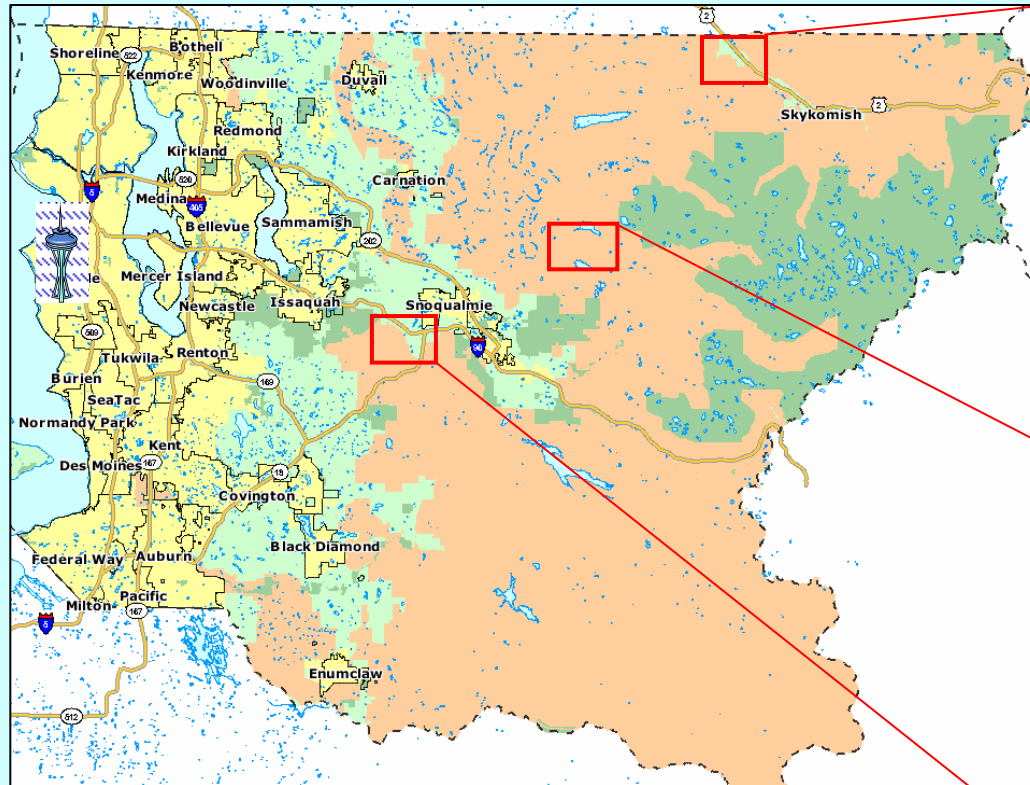

## KING COUNTY VICINITY

- Major Flooding Throughout
- Access Roads Closed to Tolt, Novelty, & Duvall Bridges
- Emergency Repair Response to Baring, Wagners, Sunday Creek, & Preston Frontage Road Bridges

Introduction

Planning

Flood Damage

Construction

Bridges Open



King County

# Emergency Bridge Flood Damage Repairs

Integrity  
Structural  
Engineering  
PLLC

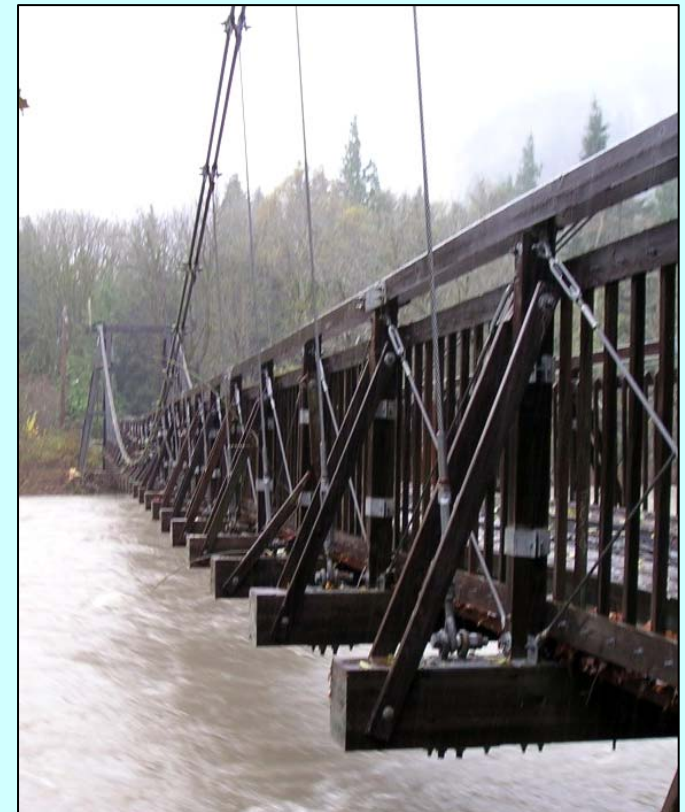

## **BARING BRIDGE (Skykomish)**

- Sole Access to 43 Residential Sites
- Historic County Landmark, 272-foot Timber & Cable Suspension



# Emergency Bridge Flood Damage Repairs



## **BARING BRIDGE**

- Scouring/Flooded Support Towers
- Heavy Debris Accumulation





# Emergency Bridge Flood Damage Repairs

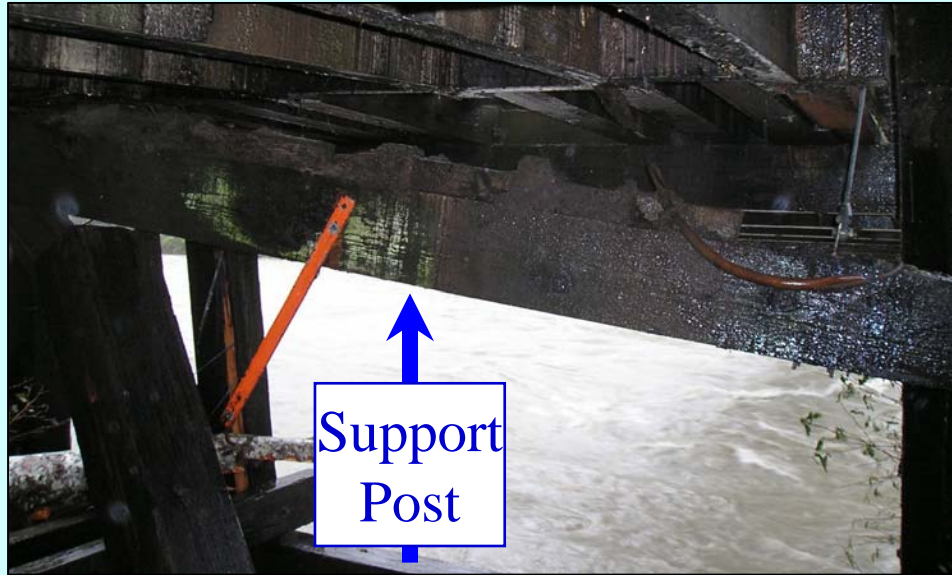

**BARING BRIDGE**  
- Loss of two Approach Support Posts below West Tower



# Emergency Bridge Flood Damage Repairs



**BARING BRIDGE**  
- Log Damage to Deck, Rails, Vertical, and Brace Cables



# Emergency Bridge Flood Damage Repairs



Scour Critical Piers

## WAGNERS BRIDGE (North Fork Snoqualmie)

- Logging & Mining Access
- Recreational Area Road





# Emergency Bridge Flood Damage Repairs



**Very Important Rock (VIR)**



## **WAGNERS BRIDGE**

**(North Fork Snoqualmie)**

- Flood Water Overtops “VIR”
- Road Closed During Flood



# Emergency Bridge Flood Damage Repairs



## UPPER PRESTON ROAD SE (Raging River)

- Sole Access to About 200 Homes
- Temporary I-90 Access Added



# Emergency Bridge Flood Damage Repairs



**UPPER PRESTON ROAD SE**  
**(Raging River)**

- Stabilize Road
- Repair and Re-Build Embankment

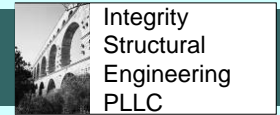

## **Preston Frontage Road Bridge Emergency Response**

- a. Flooding Damage**
- b. Emergency Response Required**
- c. Construction and Repair Implementation**
- d. Conclusions and Bridges Open**



King County

# Emergency Bridge Flood Damage Repairs

Integrity  
Structural  
Engineering  
PLLC



## PRESTON FRONTAGE ROAD (Raging River)

- Providing Access to Area Residents
- 316-foot Curved Reinforced Concrete Box Girder Bridge







# Emergency Bridge Flood Damage Repairs

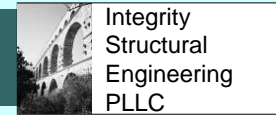

## Day 1



Scour  
Attack



# Emergency Bridge Flood Damage Repairs

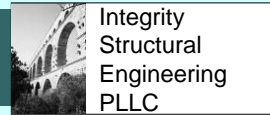

**Preston Fr. Rd. Bridge**



**Major Fiber Optic Utilities**



**Upper Preston Road SE**



# Emergency Bridge Flood Damage Repairs



## Emergency Response Objectives:

- Redirect Raging River Allowing Access
- Support Bridge and Remove Pending Collapse
- Stabilize Steep Slopes
- Address Scour/Install Permanent Countermeasures

## Immediate Challenges:

- Flooding Conditions and Continued Rains
- Limited Material Availability
- Poor Access and Steep Slopes
- Unsafe Conditions with On-going Scour and Jeopardy of Bridge Collapse



# Emergency Bridge Flood Damage Repairs



## Day 1



### **Construct Guide Bank to Protect Bridge and Redirect Flood**

- HEC-23 countermeasures considered
- Most direct response with riprap (limited availability)
- Sized riprap and mapped out placement sequence



# Emergency Bridge Flood Damage Repairs



## Day 1

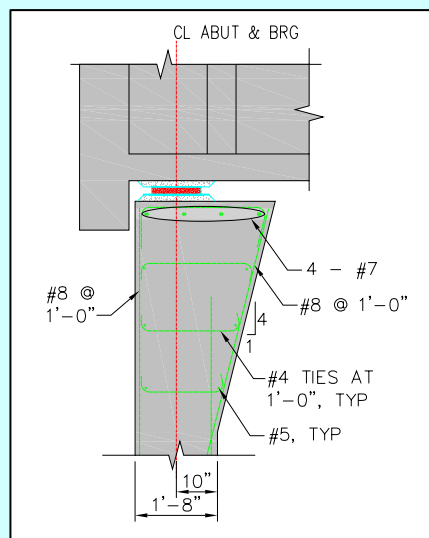

### Abutment Analysis

- Acting as a cracked, inverted T-beam
- #7 bars yielding, but layers of #5 bars engaged
- System ductile and temporarily stable



# Emergency Bridge Flood Damage Repairs



## Day 2



### Provide Abutment Support

- River redirected
- Crane support added for safety
- Some slope stabilization work
- Constructed precast foundation support using on-hand materials





# Emergency Bridge Flood Damage Repairs

Integrity  
Structural  
Engineering  
PLLC

## Day 3



### Jacking and Scour Countermeasures

- Installed steel bearing shims
- 160-tons of jacking force
- Placed foundation enclosure
- Pumped rapid set/high cement concrete below the abutment
- Continued riprap placement





# Emergency Bridge Flood Damage Repairs



## Bridges Open to Community







# Emergency Bridge Flood Damage Repairs

## Results

### Closure Duration

- All Bridges and Community Access Opened by Day 4
- Upper Preston Road SE Complete in December

### Flood Repair Costs

- Baring Bridge at \$30,000
- Upper Preston Road SE at about \$2.2 Million
- Preston Frontage Road Bridge Repair Cost at \$600,000  
(compared to \$5 million for Replacement)

## Conclusion

- ✓ Preplanning and Pre-Assigned Responsibilities were Critical to Saving the Bridges
- ✓ On-Call Engineering/Technical Support was Fundamental to Response Time
- ✓ Repairs were Cost-Effective and provided Substantial Public Benefit
- ✓ Public Safety, Welfare, and Goodwill were Enhanced



# Emergency Bridge Flood Damage Repairs



## Team Acknowledgements:

### King County Department of Transportation

Jim Markus, PE, KC Managing Engineer

Ben Blegen, KC Project Manager

Margaret Holwegner, KC Engineer

Jessy Jose, KC Senior Engineer

Bob Lee, KC Construction Manager

Kino Gomez, KC Construction Superintendent

Casey Hayes, KC Inspector

Mark Anderson, KC Maintenance Lead

### Integrity Structural Engineering, PLLC

Ken Wilson, PE SE, Project Engineer/Manager

### KPFF Consulting Engineers

Izzat Hasayen, Principal

### West Consulting Engineers

Dr. Ray Walton, Hydraulic Engineer

### Wilder Construction

Marty Griffith, Superintendent



# Emergency Bridge Flood Damage Repairs



Q & A

