

CASE 16

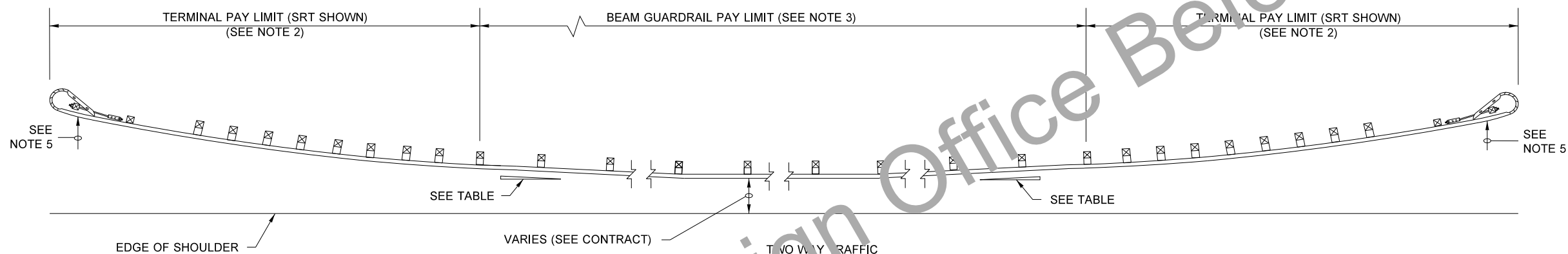

CASE 17

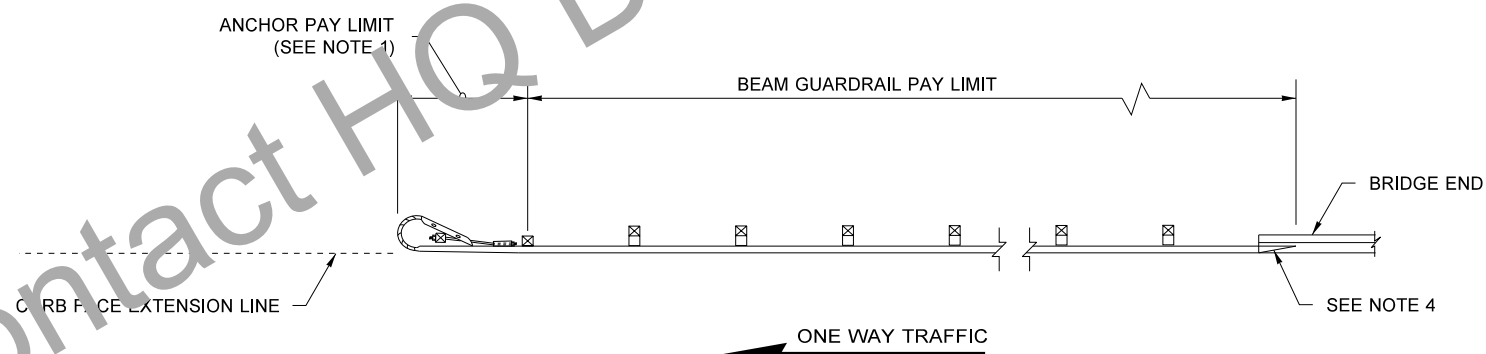

CASE 18

TYPE 1 GUARDRAIL PLACEMENT (CASES 16, 17, & 18)

NOTES

1. TYPE 4 ANCHOR REQUIRED. FOR DETAILS, SEE APPLICABLE **PLAN(S)**.
2. FOR TERMINAL TYPE AND DETAILS, SEE CONTRACT AND APPLICABLE **PLAN(S)**.
3. POST SPACING IS 6' - 3" EXCEPT WHERE NOTED.
4. FOR GUARDRAIL TO BRIDGE RAIL CONNECTION SEE APPLICABLE **PLAN(S)** OR CONTRACT.
5. THE SLOPE FROM THE EDGE OF THE SHOULDER INTO THE FACE OF THE GUARDRAIL SHOULD NOT BE STEEPER THAN 10H : 1V WHEN THE GUARDRAIL IS WITHIN 12' - 0" FROM THE EDGE OF THE SHOULDER. BEYOND 12' - 0", THE SLOPE SHALL NOT BE STEEPER THAN 6H : 1V.

FLARE RATE TABLE	
RATE	POSTED SPEED (MPH)
15 : 1	70
14 : 1	60
12 : 1	55
11 : 1	50
10 : 1	45
9 : 1	40 or less

FILE NAME: S:\Design R P & S\4-Standards\2-Plan Sheet Library\02-PSL Work in Progress\C series conversion\TB-c2\TB-c2].dgn				REGION NO. STATE		FED.AID PROJ.NO.		Plot 1	
TIME: 8:29:46 AM				10 WASH				PLAN REF NO	
DATE: 8/2/2018								TB-C2j	
PLOTTED BY: liddelf				JOB NUMBER				SHEET	
DESIGNED BY:				CONTRACT NO.		LOCATION NO.		OF	
ENTERED BY:								SHEETS	
CHECKED BY:									
PROJ. ENGR.:									
REGIONAL ADM.:				REVISION		DATE BY			
						DATE		P.E. STAMP BOX	
						DATE		P.E. STAMP BOX	

