

Cooperative Agreement GCA 6402
Between
Washington State Department of Transportation
and the City of Selah

This Agreement is made and entered into between the STATE OF WASHINGTON, Department of Transportation, hereinafter the "STATE," and the City of Selah, 115 W. Naches Ave. Selah, Washington 98942, hereinafter the "CITY."

WHEREAS, the CITY proposed and sought funding for a project titled, "SR 823 Realignment and Railroad Avenue Improvements," hereinafter the "Project," and

WHEREAS, 2005 Transportation Partnership Account funding for the Project improvements has been secured and re-approved in the 2009 Legislative Transportation Budget, as a STATE Project, and

WHEREAS, the Project provides for realigning state highway SR 823 from Fifth Avenue to Bartlett Avenue vicinity to reduce congestion and improve safety and rebuilding a portion of South Railroad Avenue and North Railroad Avenue adjacent to SR 823, from Naches Avenue vicinity to Bartlett Avenue, and

WHEREAS, the Project will result in transferring state highway designation from certain city streets to other city streets, and

WHEREAS, the STATE has notified the CITY of the proposed change to the SR 823 alignment pursuant to RCW 47.24.010, and

WHEREAS, as part of the Project the STATE has acquired private property located outside the limits of the proposed SR 823 alignment that the STATE will transfer to the CITY through a quitclaim deed, and

WHEREAS, the Parties have been working on Project development and now wish to define each Party's responsibilities for the Project, and

WHEREAS, subject to the terms and conditions contained herein, this Agreement constitutes certification and transfer of a portion of the existing SR 823 right of way to the CITY pursuant to WAC 468-30-075,

NOW, THEREFORE, pursuant to RCW 47.28.140, chapter 47.24 RCW, and/or chapter 39.34 RCW, and in consideration of the provisions, terms, conditions and performances contained herein or attached and incorporated and made a part hereof,

IT IS MUTUALLY AGREED AS FOLLOWS:

1. Project Parameters

- 1.1 The existing highway SR 823 coincides with South First Street from Fifth Avenue to West Naches Avenue then turns east and coincides with East Naches Avenue to North Wenas Avenue where it turns northerly along North Wenas Avenue.
- 1.2 SR 823, when realigned, will follow the existing alignment, coinciding with South First Street to Fifth Avenue and then turn and proceed in a northeasterly direction intersecting and crossing West Selah Avenue heading in a Northerly direction along South Wenas Avenue to East Naches Avenue where it will again coincide with North Wenas Avenue.
- 1.3 North and South Railroad Avenue serve an agricultural processing area with heavy truck use. Prior to replacing the existing pavement with Portland Cement Concrete Pavement (PCCP), the aged portions of the infrastructure will be replaced to avoid future disruptions of the new surface.
- 1.4 The Project roadways are shown on Exhibit A, attached hereto and by this reference is made a part of this Agreement.

2. Term of Agreement

- 2.1 Unless otherwise provided herein or terminated pursuant to Section 6, the term of this Agreement shall commence on the last signature date below and shall continue until the Project is accepted by the CITY pursuant to Section 9.

3. Pre-contract Project Activities

- 3.1 The STATE or its agents will be responsible for designing, including Project design approval, securing Project permits, prepare plans, specifications and estimates, including Project development approval, arranging affected utility adjustments, and acquiring SR 823 right of way.

4. Project Ad, Award, and Construction

- 4.1 The STATE or its agents shall prepare the contract plans, advertise and award a construction contract if bids are acceptable, and administer the construction of the Project in accordance with the current Standard Specifications for Road, Bridge and Municipal Construction and its amendments thereto (Standard Specifications).
- 4.2 The Project contract plans and provisions, when completed, shall by this reference be incorporated as Exhibit C to this Agreement as if fully attached. The STATE has designated a Project Engineer to provide all necessary services and tools, including but not limited to, construction administration, inspection, materials testing, and the representation necessary to administer and manage the construction contract for the Project to ensure the Project work is constructed in accordance with the contract plans and provisions.

- 4.3 The CITY will consult with the STATE's Project Engineer, attend all meetings, and have access to all documentation as to all matters concerning the Project. The CITY shall not provide direction, directly or indirectly, to the STATE's agent(s) or contractor. All formal contacts between the CITY and the STATE's agent(s) or contractor shall be only through the STATE's Project Engineer or designated representative.
- 4.4 The CITY acknowledges and accepts that the proposed waterline construction on Railroad Avenue will result in thirty-six inches (36) nominal cover from the top of the waterline to finished surface. This cover depth is the maximum achievable within the constraints of other utility conflicts.
- 4.5 The STATE will prepare the final construction documentation in general conformance with the STATE's Construction Manual. The STATE will maintain one set of plans as the official "as-built" set, then make notations in red ink of all plan revisions typically recorded per standard STATE practices, as directed by the STATE's Construction Manual. Once final CITY acceptance of the Project has occurred, the STATE will submit one reproducible set of as-built plans to the CITY when such plans become available.
- 4.6 Agreement Contacts:

City of Selah		Department of Transportation
Joe Henne		Paul Gonseth, P.E.
Public Works Director		Project Engineer
115 West Naches Avenue		115 East Ahtanum Road
Selah, WA 98942		Union Gap, WA 98903
(509) 698-7365		(509) 577-1840

5. Payment

- 5.1 This Project has been funded by Legislative action. The STATE has control of the funding and will be paying the Project expenses. No money is anticipated to be exchanged between the Parties as a result of this Agreement.
- 5.2 The Project construction cost estimate is shown on Exhibit B, attached hereto and by this reference is made a part of this Agreement.

6. Termination

- 6.1 This Agreement shall terminate upon completion of the Project work and CITY acceptance of the Project pursuant to Section 9, unless otherwise stated herein.
- 6.2 The STATE may terminate this Agreement for public convenience, whenever:
- 6.2.1 The contractor is prevented from proceeding with the Project work as a direct result of an Executive Order of the President of the United States of America (President) with respect to the prosecution of war or in the interest of national

defense, or an Executive Order of the President or Governor of the State of Washington with respect to the preservation of energy resources.

- 6.2.2 The contractor is prevented from proceeding with the Project work by reason of a preliminary, special, or permanent restraining order of a court of competent jurisdiction where the issuance of such order is primarily caused by the acts or omissions of persons or agencies other than the contractor.
- 6.2.3 The STATE determines that such termination is in the best interests of the state of Washington.
- 6.2.4 Funding for the Project is reduced or eliminated.

7. Records

- 7.1 During Project construction and for a period of not less than three (3) years from the date of Physical Completion of the Project, the records and accounts pertaining to the design, property acquisitions, and construction of the Project will be maintained and shall be kept available by the STATE for inspection and audit by the CITY, or other authorized entity, and for use in the event of litigation, claim or any other purpose. Should the CITY require copies of any records following the submittal of plans as specified in Section 4.4, it agrees to pay the costs thereof.

8. Change Orders

- 8.1 Changes to the Project contract will be documented by change order in accordance with the Standard Specifications.
- 8.2 Required changes involve such changes in quantities or alterations to the Project work as are necessary to satisfactorily complete the Project as determined by the STATE. All other changes affecting the Project work shall be considered elective changes. All elective changes requested by the CITY shall be made in writing to the STATE. The STATE will implement the requested changes as elective changes, provided that a change does not negatively impact the STATE's transportation system and complies with the Standard Specifications, Project permits, state and/or federal law, applicable rules and/or regulations, and/or STATE design policies, and does not unreasonably delay critically scheduled Project contract activities as determined by the STATE. If the CITY requests an elective change order, it agrees to pay to the STATE all costs associated with the elective change order within thirty (30) calendar days after receipt of a STATE invoice for said costs. The STATE shall process all required change orders in the manner as set forth in subsection 1-2.4C (3), Approval of Changes/Checklist, of the Washington State Department of Transportation Construction Manual, current edition.
- 8.3 The STATE will initiate, negotiate, document, and execute all required change orders.
- 8.4 The STATE will advise the CITY of any proposed required changes affecting South Railroad Avenue or North Railroad Avenue and provide the CITY with an opportunity, if time permits, to review the change before implementation. The STATE will determine

the length of the review time based upon the need to expedite the change to avoid delay to the contractor.

- 8.5 The STATE will make available to the CITY all change order documentation.

9. Project Acceptance

- 9.1 Prior to Project acceptance, the STATE and CITY will perform a joint final inspection. The CITY agrees, upon satisfactory completion of the Project and receipt of the STATE's Notice of Physical Completion, as determined by the STATE, to deliver a letter of acceptance which shall include a release of the STATE from all future claims or demands of any nature resulting from the performance of the Project work , except as provided under Section 9.3.
- 9.2 If a letter of acceptance is not received by the STATE within twenty (20) calendar days following the date of the STATE's Notice of Physical Completion of the Project, the Project shall be considered accepted by the CITY and the STATE shall be released from all future claims and demands of any nature resulting from the performance of the Project work.
- 9.3 The CITY may withhold the acceptance of the Project by submitting a written notification to the STATE within twenty (20) calendar days following the date of the STATE's Notice of Physical Completion of the Project. This notification shall include detailed reason(s) for withholding the acceptance. The STATE shall address the reason(s), and describe to the CITY, in writing, how the reason(s) were addressed. If the reason(s) for withholding acceptance cannot be resolved between the STATE and CITY, then resolution shall be per Section 10.

10. Disputes

- 10.1 In the event that a dispute arises solely between the CITY and STATE under this Agreement, it shall be resolved as follows:

The CITY and the STATE shall each appoint a member to a disputes board. These two members shall select a third board member not affiliated with either Party. The three-member board shall conduct a dispute resolution hearing that shall be informal and unrecorded. An attempt at such dispute resolution in compliance with aforesaid process shall be a prerequisite to the filing of any litigation concerning the dispute. The Parties shall equally share in the cost of the third disputes board member; however, each Party shall be responsible for its own costs and fees.

11. General Provisions

- 11.1 Rights of Entry and Ownership of Project

11.1.1 The CITY hereby grants to the STATE and its contractors and/or agents a right of entry upon all land in which the CITY has an interest for performing the Project work under this Agreement.

11.1.2 Upon completion and acceptance of the Project, maintenance and operation of all improvements and facilities located on Fifth Avenue and Wenas Avenue, comprising part of the realigned state route SR 823 as described in Section 1.2, shall be in accordance with chapter 47.24 RCW, WAC 468-18-050, and the 1997 City Streets as Part of State Highways guidelines.

11.1.3 Upon completion and acceptance of the Project, ownership of all improvements and facilities located on the CITY's South Railroad Avenue and North Railroad Avenue right of way as described in Section 1.3 shall be the CITY's and all future operation and maintenance of said improvements and facilities shall be at the sole cost of the CITY without expense or liability to the STATE.

11.1.4 The CITY agrees that completion of the terms and conditions of this Agreement shall constitute the STATE's certification and transfer of SR 823 right of way described in Section 1.1 to the CITY pursuant to WAC 468-30-075.

11.1.5 Additional right of way purchased by the STATE for the CITY street connections and not required for state highway purposes shall be deeded to the CITY upon completion and acceptance of the Project.

Turnback Agreement TB 5-0057 between the STATE and the CITY will contain all transfer details for right of way purchased for city street intersection triangles which is outside of SR 823 right of way.

11.2 Modification

No modification of this Agreement is valid unless evidenced in writing by amendment to this Agreement and signed by both Parties. No verbal agreement may supersede, replace or amend this section.

11.3 Assignment

Neither Party to this Agreement shall transfer or assign any right or obligation hereunder without the prior written consent of the other Party.

11.4 Severability

Should any part, term or provision of this Agreement be determined to be invalid, the remainder of this Agreement shall not be affected and the same shall continue in full force and effect.

11.5 Venue

In the event that either Party deems it necessary to institute legal action or proceedings to enforce any right or obligation under this Agreement, the Parties agree that any such action or proceedings shall be brought in the superior court situated in Thurston County, Washington. Further, the Parties agree that each will be solely responsible for payment of its own attorney's fees, witness fees, and costs.

IN WITNESS WHEREOF, the Parties hereto have executed this Agreement as of the Party's date signed last below.

CITY OF SELAH

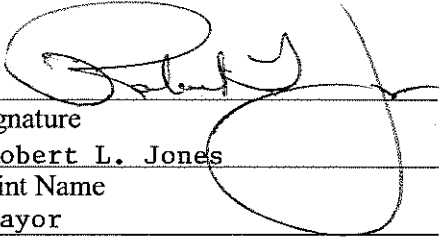
By: 
Signature
Robert L. Jones
Print Name
Mayor
Title
March 9, 2010
Date

**WASHINGTON STATE
DEPARTMENT OF TRANSPORTATION**

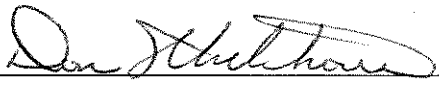
By: 
Don Whitehouse
Region Administrator
March 16, 2010
Date

APPROVED AS TO FORM:

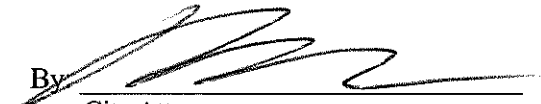
By: 
City Attorney
3/10/10
Date

APPROVED AS TO FORM:

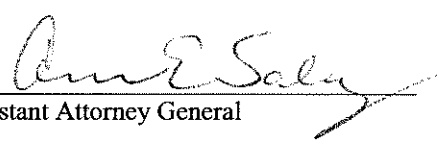
By: 
Assistant Attorney General
1-14-10
Date

CITY OF SELAH

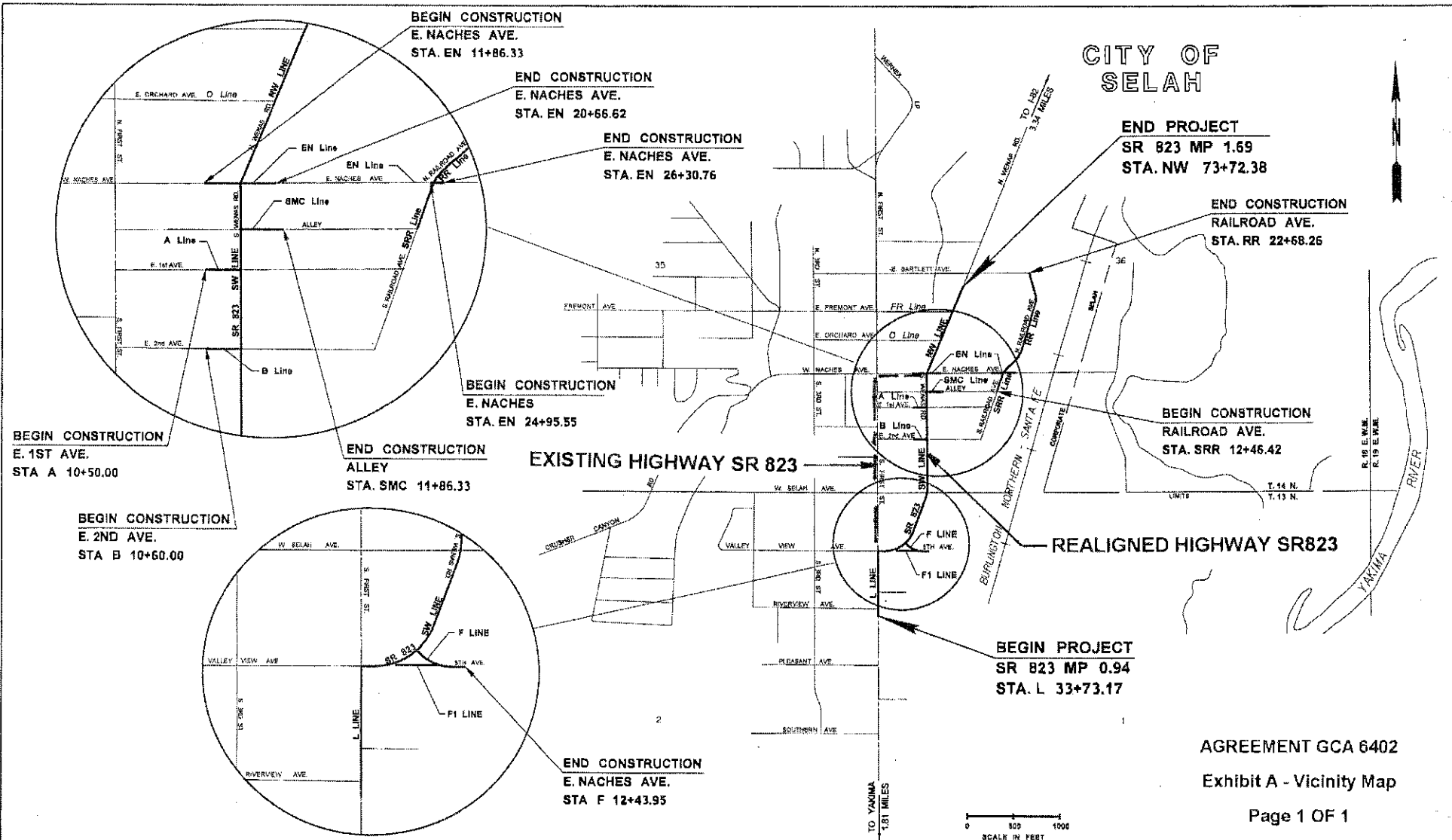

END PROJECT
 SR 823 MP 1.69
 STA. NW 73+72.38

END CONSTRUCTION
 RAILROAD AVE.
 STA. RR 22+68.26

BEGIN CONSTRUCTION
 RAILROAD AVE.
 STA. SRR 12+46.42

REALIGNED HIGHWAY SR823

BEGIN PROJECT
 SR 823 MP 0.94
 STA. L 33+73.17

AGREEMENT GCA 6402
 Exhibit A - Vicinity Map
 Page 1 OF 1

FILE NAME	P:\432002\8 PROJECT MISC DATA\Project & Reloc\SR 823, Selah Vicinity\CAD Base Map\XL1694.PS VM.dgn	REGION NO.	10	STATE	WASH	FED/AID PROJ. NO.	
TIME	9:42:24 AM	JOB NUMBER	09Y027	LOCATION NO.			
DATE	11/9/2009	CONTRACT NO.		DATE			
PLOTTED BY	kalaerm						
DESIGNED BY	D. HOLLRAH						
ENTERED BY	L. HUNT						
CHECKED BY	G. ELDER						
PROJ. ENGR.	K. GRANT						
REGIONAL ADM.	D. WHITEHOUSE	REVISION		DATE			



SR 823
 SELAH VICINITY
 RE-ROUTE HIGHWAY
 VICINITY MAP

Sheet
 V1
 3
 2009

PS&E JOB NO: XL3094

CONTRACT NO: 000000

WORK ORDER#: XL3094

WASHINGTON STATE DEPARTMENT OF TRANSPORTATION

ESTIMATES AND BIDS ANALYSIS SYSTEM

*** PRELIMINARY ESTIMATE - BY GROUP ***

DATE: 12/09/2009 PAGE: 1

TIME: 13:07 VER: 1

DOT_RGG300

GROUP NO : 1

PROGRAM ITEM NUMBER : 582301S

CONSTR. TYPE CODE : F000

PROGRAM CODE : I1

STATE ROUTE(S) : 823

COUNTY : YAKIMA

CONTROL SECTION/SALES TAX : 394101 /0.00%

SAFETY CLASS CODE :

FUND NO: 1

PARTICIPANT: STATE TPA

PARTICIPATION PERCENT: 100.00%

MAX AMOUNT:

Agreement GCA 6402

Exhibit B - Cost Estimate

Page 1 of 5

MP 0.94 TO MP 1.69

STA. L 33+73.17 TO STA. NW 73+72.38

F LINE, SMC LINE, RR LINE

GRADING, PLANING BITUMINOUS PAVEMENT, PAVING WITH CEMENT CONCRETE PAVEMENT AND HMA.

ITEM NO.	STD. NO.	ITEM DESCRIPTION	UNIT MEAS	UNIT PRICE	QUANTITY	AMOUNT
1	0001	MOBILIZATION	L.S.			445,523.00
2	0035	CLEARING AND GRUBBING	L.S.			45,000.00
3	0050	REMOVAL OF STRUCTURE AND OBSTRUCTION	L.S.			73,000.00
4	0310	ROADWAY EXCAVATION INCL. HAUL	C.Y.	8.2900	13,290.00	110,174.10
5	0470	EMBANKMENT COMPACTION	C.Y.	12.0000	590.00	7,080.00
6	1046	CONCRETE INLET	EACH	1,100.0000	10.00	11,000.00
7	1063	COMBINATION INLET	EACH	1,450.0000	6.00	8,700.00
8		COMBINATION INLET FRAME, GRATE, CURB BOX	EACH	1,500.0000	9.00	13,500.00
9	1086	QUARRY SPALLS	TON	35.0000	4.00	140.00
10	1160	UNDERDRAIN PIPE 6 IN. DIAM.	L.F.	60.0000	12.00	720.00
11	1165	UNDERDRAIN PIPE 18 IN. DIAM.	L.F.	62.0000	15.00	930.00
12		UNDERDRAIN PIPE 36 IN. DIAM.	L.F.	72.5000	526.00	38,135.00
13	3090	CATCH BASIN TYPE 1L	EACH	900.0000	7.00	6,300.00
14	3091	CATCH BASIN TYPE 1	EACH	1,100.0000	41.00	45,100.00
15	3105	CATCH BASIN TYPE 2 48 IN. DIAM.	EACH	2,100.0000	52.00	109,200.00
16	3106	CATCH BASIN TYPE 2 54 IN. DIAM.	EACH	3,500.0000	1.00	3,500.00
17	3109	CATCH BASIN TYPE 2 60 IN. DIAM.	EACH	3,500.0000	2.00	7,000.00
18	3151	TESTING STORM SEWER PIPE	L.F.	2.0000	6,620.00	13,240.00
19	3391	PLAIN CONC. STORM SEWER PIPE 6 IN. DIAM.	L.F.	68.0000	18.00	1,224.00
20	3394	PLAIN CONC. STORM SEWER PIPE 12 IN. DIAM.	L.F.	70.0000	16.00	1,120.00
21	3396	PLAIN CONC. STORM SEWER PIPE 18 IN. DIAM.	L.F.	72.0000	18.00	1,296.00
22		PLAIN CONC. STORM SEWER PIPE 30 IN. DIAM.	L.F.	75.0000	6.00	450.00
23		PLAIN CONC. STORM SEWER PIPE 36 IN. DIAM.	L.F.	78.0000	6.00	468.00

SR 823
SELAH VICINITY -
RE-ROUTE HIGHWAY
09Y027

PS&E JOB NO: XL3094
 CONTRACT NO: 000000
 WORK ORDER#: XL3094

WASHINGTON STATE DEPARTMENT OF TRANSPORTATION
 ESTIMATES AND BIDS ANALYSIS SYSTEM
 *** PRELIMINARY ESTIMATE - BY GROUP ***
 GROUP NO : 1

DATE: 12/09/2009 PAGE: 2
 TIME: 13:07 VER: 1
 DOT_RGG300

Agreement GCA 6402

Exhibit B - Cost Estimate

Page 2 of 5

ITEM NO.	STD. NO.	ITEM DESCRIPTION	UNIT MEAS	UNIT PRICE	QUANTITY	AMOUNT
24	3455	CL. IV REINF. CONC. STORM SEWER PIPE 12 IN. DIAM.	L.F.	40.0000	436.00	17,440.00
25		CL. V REINF. CONC. STORM SEWER PIPE 8 IN. DIAM.	L.F.	50.0000	39.00	1,950.00
26	3480	CL. V REINF. CONC. STORM SEWER PIPE 12 IN. DIAM.	L.F.	35.0000	174.00	6,090.00
27		SCHEDULE A STORM SEWER PIPE 6 IN. DIAM.	L.F.	85.0000	20.00	1,700.00
28		SCHEDULE A STORM SEWER PIPE 8 IN. DIAM.	L.F.	85.0000	166.00	14,110.00
29	3541	SCHEDULE A STORM SEWER PIPE 12 IN. DIAM.	L.F.	32.0000	2,761.00	88,352.00
30	3542	SCHEDULE A STORM SEWER PIPE 18 IN. DIAM.	L.F.	40.0000	2,107.00	84,280.00
31	3544	SCHEDULE A STORM SEWER PIPE 30 IN. DIAM.	L.F.	85.0000	44.00	3,740.00
32	3545	SCHEDULE A STORM SEWER PIPE 36 IN. DIAM.	L.F.	90.0000	128.00	11,520.00
33		DUCTILE IRON PIPE FOR STORM SEWER 12 IN. DIAM.	L.F.	60.0000	668.00	40,080.00
34		OBSERVATION WELL	L.S.			400.00
35		HYDRODYNAMIC SEPARATOR (SMALL)	EACH	15,840.0000	1.00	15,840.00
36		HYDRODYNAMIC SEPARATOR (LARGE)	EACH	23,980.0000	1.00	23,980.00
37	3152	TESTING SEWER PIPE	L.F.	2.0000	1,470.00	2,940.00
38		PVC SANITARY SEWER PIPE 15 IN. DIAM.	L.F.	60.0000	1,298.00	77,880.00
39		PVC SANITARY SEWER PIPE 18 IN. DIAM.	L.F.	80.0000	172.00	13,760.00
40	6165	GATE VALVE 12 IN.	EACH	2,100.0000	4.00	8,400.00
41	3846	HYDRANT ASSEMBLY	EACH	4,000.0000	4.00	16,000.00
42	3848	RESETTING EXISTING HYDRANTS	EACH	1,850.0000	5.00	9,250.00
43	3850	MOVING EXISTING HYDRANTS	EACH	2,000.0000	3.00	6,000.00
44		TRANSFER EXISTING FIRE DEPARTMENT CONNECTION ASSEMBLY	EACH	1,500.0000	1.00	1,500.00
45	3861	SERVICE CONNECTION 2 IN. DIAM.	EACH	2,500.0000	3.00	7,500.00
46	3866	DUCTILE IRON PIPE FOR WATER MAIN 6 IN. DIAM.	L.F.	60.0000	23.00	1,380.00
47	3867	DUCTILE IRON PIPE FOR WATER MAIN 8 IN. DIAM.	L.F.	60.0000	528.00	31,680.00
48	3869	DUCTILE IRON PIPE FOR WATER MAIN 12 IN. DIAM.	L.F.	65.0000	1,171.00	76,115.00
49	4472	NOISE BARRIER WALL TYPE 8B	S.F.	76.0000	2,100.00	159,600.00
50		RETAINING WALL (LARSON FRUIT CO.)	L.S.			7,500.00
51		RETAINING WALL (SELAH MINING CO.)	L.S.			7,500.00
52	5100	CRUSHED SURFACING BASE COURSE	TON	15.0000	6,400.00	96,000.00
53	5120	CRUSHED SURFACING TOP COURSE	TON	20.0000	760.00	15,200.00

SR 823
 SELAH VICINITY -
 RE-ROUTE HIGHWAY
 09Y027

PS&E JOB NO: XL3094
 CONTRACT NO: 000000
 WORK ORDER#: XL3094

WASHINGTON STATE DEPARTMENT OF TRANSPORTATION
 ESTIMATES AND BIDS ANALYSIS SYSTEM
 *** PRELIMINARY ESTIMATE - BY GROUP ***
 GROUP NO : 1

DATE: 12/09/2009 PAGE: 3
 TIME: 13:07 VER: 1
 DOT_RGG300

Agreement GCA 6402

Exhibit B - Cost Estimate

Page 3 of 5

ITEM NO.	STD. NO.	ITEM DESCRIPTION	UNIT MEAS	UNIT PRICE	QUANTITY	AMOUNT
54	5334	ANTI-STRIPPING ADDITIVE	EST.			3,980.00
55	5625	CEMENT CONC. PAVEMENT	C.Y.	350.0000	1,290.00	451,500.00
56	5638	PORTLAND CEMENT CONC. COMPLIANCE ADJUSTMENT	CALC			-1.00
57	5685	CORROSION RESISTANT DOWEL BAR	EACH	18.0000	4,016.00	72,288.00
58	5711	PLANING BITUMINOUS PAVEMENT	S.Y.	7.5000	850.00	6,375.00
59	5767	HMA CL. 1/2 IN. PG 64-28	TON	80.0000	4,030.00	322,400.00
60	5830	JOB MIX COMPLIANCE PRICE ADJUSTMENT	CALC			9,560.00
61	5835	COMPACTION PRICE ADJUSTMENT	CALC			6,370.00
62	5837	ASPHALT COST PRICE ADJUSTMENT	CALC			9,015.00
63	6403	ESC LEAD	DAY	300.0000	260.00	78,000.00
64	6471	INLET PROTECTION	EACH	110.0000	105.00	11,550.00
65	6500	COMPOST SOCK	L.F.	6.5000	1,930.00	12,545.00
66	6490	EROSION/WATER POLLUTION CONTROL	EST.			5,000.00
67	6405	TOPSOIL TYPE A	C.Y.	45.0000	291.00	13,095.00
68	6555	SOD INSTALLATION	S.Y.	6.0000	670.00	4,020.00
69		SHALE ROCK	S.Y.	75.0000	72.00	5,400.00
70	6700	CEMENT CONC. TRAFFIC CURB AND GUTTER	L.F.	16.0000	6,964.00	111,424.00
71	6701	CEMENT CONC. TRAFFIC CURB	L.F.	25.0000	257.00	6,425.00
72		3 IN. CEMENT CONCRETE CURB AND GUTTER	L.F.	30.0000	142.00	4,260.00
73	6707	CEMENT CONC. PEDESTRIAN CURB	L.F.	20.0000	484.00	9,680.00
74	6806	PAINT LINE	L.F.	0.2000	7,280.00	1,456.00
75	6828	PLASTIC WIDE LANE LINE	L.F.	3.0000	2,050.00	6,150.00
76	6857	PLASTIC CROSSWALK LINE	S.F.	4.0000	7,000.00	28,000.00
77	6859	PLASTIC STOP LINE	L.F.	7.0000	400.00	2,800.00
78	6833	PLASTIC TRAFFIC ARROW	EACH	50.0000	47.00	2,350.00
79	6871	PLASTIC TRAFFIC LETTER	EACH	60.0000	4.00	240.00
80	6890	PERMANENT SIGNING	L.S.			13,000.00
81	6902	SIGN COVERING	S.F.	10.0000	22.00	220.00
82	6904	ILLUMINATION SYSTEM	L.S.			325,000.00
83	6912	TRAFFIC SIGNAL SYSTEM AT NACHES AVE	L.S.			250,000.00
84	6912	TRAFFIC SIGNAL SYSTEM AT FREMONT AVE	L.S.			180,000.00

SR 823
 SELAH VICINITY -
 RE-ROUTE HIGHWAY
 09Y027

PS&E JOB NO: XL3094
CONTRACT NO: 000000
WORK ORDER#: XL3094

WASHINGTON STATE DEPARTMENT OF TRANSPORTATION
ESTIMATES AND BIDS ANALYSIS SYSTEM
*** PRELIMINARY ESTIMATE - BY GROUP ***
GROUP NO : 1

DATE: 12/09/2009 PAGE: 4
TIME: 13:07 VER: 1
DOT_RGG300

Agreement GCA 6402

Exhibit B - Cost Estimate

Page 4 of 5

ITEM NO.	STD. NO.	ITEM DESCRIPTION	UNIT MEAS	UNIT PRICE	QUANTITY	AMOUNT
85	6912	TRAFFIC SIGNAL SYSTEM 5TH/VALLEY VIEW AVE	L.S.			80,000.00
86	6956	SEQUENTIAL ARROW SIGN	HR	3.0000	300.00	900.00
87	6993	PORTABLE CHANGEABLE MESSAGE SIGN	HR	4.2500	5,200.00	22,100.00
88	6973	OTHER TEMPORARY TRAFFIC CONTROL	L.S.			30,000.00
89	6980	FLAGGERS AND SPOTTERS	HR	40.0000	400.00	16,000.00
90	6992	OTHER TRAFFIC CONTROL LABOR	HR	40.0000	4,160.00	166,400.00
91	6974	TRAFFIC CONTROL SUPERVISOR	L.S.			142,500.00
92	6982	CONSTRUCTION SIGNS CLASS A	S.F.	15.0000	560.00	8,400.00
93	6868	PEDESTRIAN CONTROL AND PROTECTION	L.S.			5,000.00
94	7003	TYPE B PROGRESS SCHEDULE	L.S.			10,000.00
95	7006	STRUCTURE EXCAVATION CLASS B INCL. HAUL	C.Y.	8.0000	7,690.00	61,520.00
96	7007	SHORING OR EXTRA EXCAVATION TRENCH	S.F.	1.0000	6,160.00	6,160.00
97	7008	SHORING OR EXTRA EXCAVATION CLASS B	S.F.	1.5000	49,820.00	74,730.00
98	7014	GRAVEL BACKFILL FOR DRAIN	C.Y.	40.0000	828.00	33,120.00
99	7028	CURE BOX	L.S.			5,000.00
100	7041	BOLLARD TYPE 2	EACH	600.0000	8.00	4,800.00
101	7055	CEMENT CONC. SIDEWALK	S.Y.	30.0000	3,462.00	103,860.00
102	7059	CEMENT CONC. DRIVEWAY ENTRANCE TYPE 1	S.Y.	40.0000	986.00	39,440.00
103	7059	CEMENT CONC. DRIVEWAY ENTRANCE TYPE 2	S.Y.	40.0000	32.00	1,280.00
104	7058	CEMENT CONC. SIDEWALK RAMP TYPE 1	EACH	900.0000	2.00	1,800.00
105	7058	CEMENT CONC. SIDEWALK RAMP TYPE 2	EACH	900.0000	14.00	12,600.00
106	7058	CEMENT CONC. SIDEWALK RAMP TYPE 4A	EACH	900.0000	2.00	1,800.00
107	7058	CEMENT CONC. SIDEWALK RAMP TYPE 4C	EACH	900.0000	3.00	2,700.00
108		TRUNCATED DOME DETECTABLE WARNING PATTERN	S.F.	60.0000	54.00	3,240.00
109	7084	CHAIN LINK FENCE TYPE 4	L.F.	17.0000	123.00	2,091.00
110		TEMPORARY CHAIN LINK FENCE	L.F.	5.0000	770.00	3,850.00
111	3080	ADJUST MANHOLE	EACH	350.0000	4.00	1,400.00
112	7360	MANHOLE 48 IN. DIAM. TYPE 1	EACH	900.0000	24.00	21,600.00
113	7363	MANHOLE 54 IN. DIAM. TYPE 1	EACH	3,000.0000	2.00	6,000.00
114	7480	ROADSIDE CLEANUP	EST.			5,000.00
116	7728	MINOR CHANGE	CALC			-1.00

SR 823
SELAH VICINITY -
RE-ROUTE HIGHWAY
09Y027

PS&E JOB NO: XL3094

CONTRACT NO: 000000

WORK ORDER#: XL3094

WASHINGTON STATE DEPARTMENT OF TRANSPORTATION

ESTIMATES AND BIDS ANALYSIS SYSTEM

*** PRELIMINARY ESTIMATE - BY GROUP ***

GROUP NO : 1

DATE: 12/09/2009 PAGE: 5

TIME: 13:07 VER: 1

DOT_RGG300

Agreement GCA 6402

Exhibit B - Cost Estimate

ITEM NO.	STD. NO.	ITEM DESCRIPTION	UNIT MEAS	UNIT PRICE	QUANTITY	AMOUNT
117	7736	SPCC PLAN	L.S.			1,000.00
118	7550	CONSTRUCTION GEOTEXTILE FOR UNDERGROUND DRAINAGE	S.Y.	3.0000	1,720.00	5,160.00
GROUP 1 BASE SUBTOTAL :						4,622,039.10 *
NACHES AVE SERVICE AGREEMENT						1,000.00
FREEMONT ST SERVICE AGREEMENT						1,000.00
SECOND ST SERVICE AGREEMENT						900.00
GROUP 1 SUBTOTAL						4,624,939.10 **
ENGINEERING 17.00%						786,239.65
GROUP 1 TOTAL						5,411,178.75 ***

Page 5 of 5