

I-405/Brickyard to SR 527 Improvement Project

Community Briefing

April 2, 2024

Introductions

- Evelyn Pao – WSDOT, Project Director
- Pat Prendergast - Skanska, Project Executive
- Craig Smiley – WSDOT, Communications Lead

Agenda

- I-405, Brickyard to SR 527 Improvement Project overview
- Construction updates
 - What has happened
 - What's coming up
- How to stay informed
- Discussion and Q&A

Project overview and benefits

Project overview



Expand express toll lane (ETL) capacity.



Widen I-405 through the SR 522 interchange.



Add direct access ramps at the SR 527 and SR 522.



Construct a new transit hub, build inline Bus Rapid Transit (BRT) stations on I-405, and improve bus transit connections locally.



Improve connections for pedestrians and cyclists to transit and trails.



Improve local roadways and state routes.



Correct and repair fish barriers.

Current I-405/Brickyard Park and Ride



Future I-405/Brickyard Park and Ride



Current SR 522 interchange

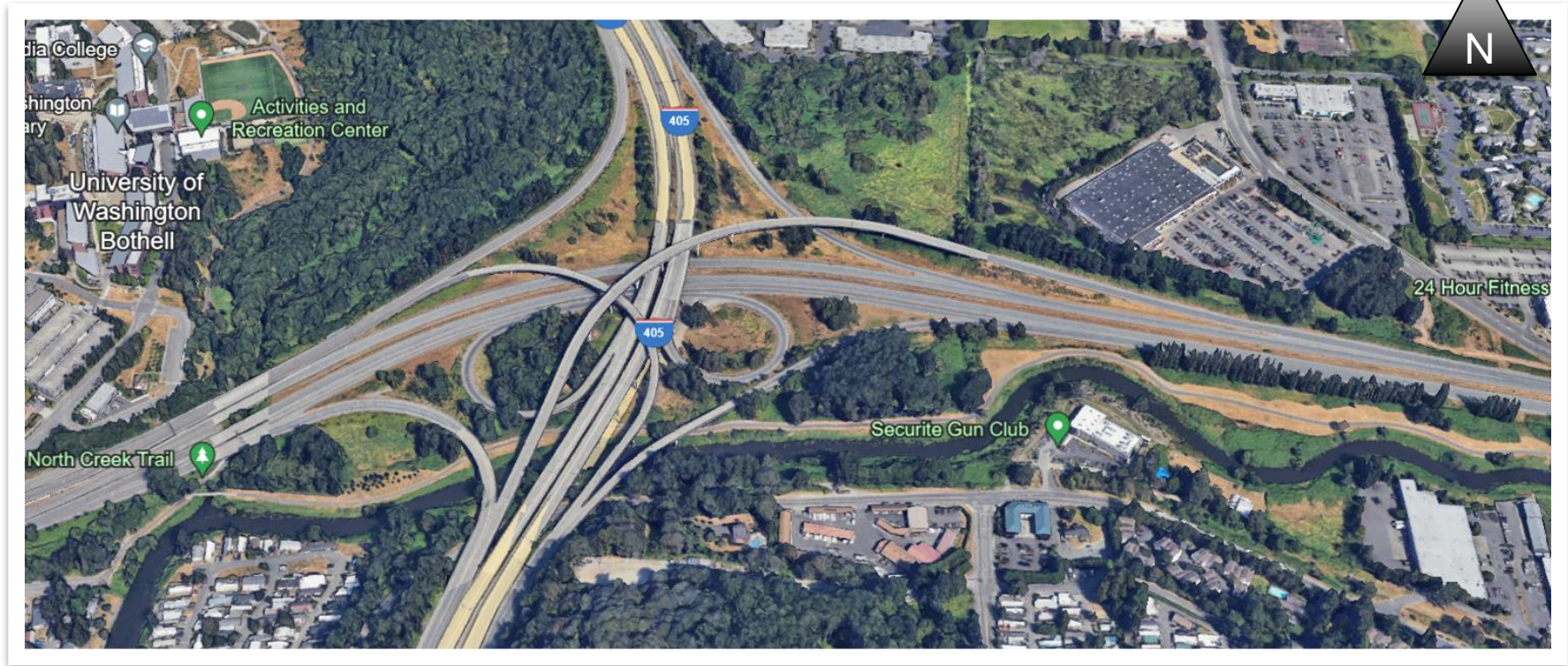

Future SR 522 interchange and hub

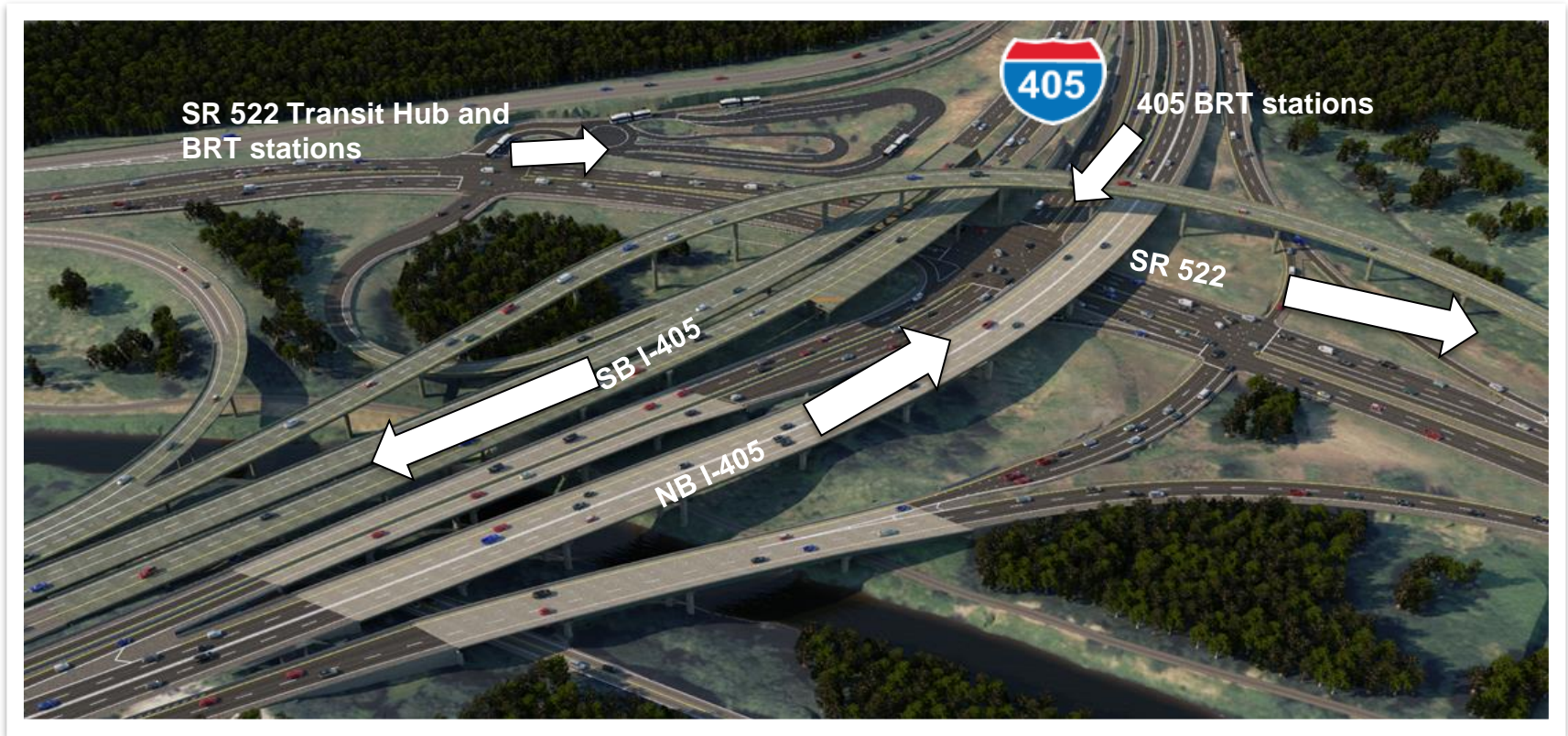

Current SR 527, Canyon Park Park and Ride



Future SR 527, Canyon Park Park and Ride

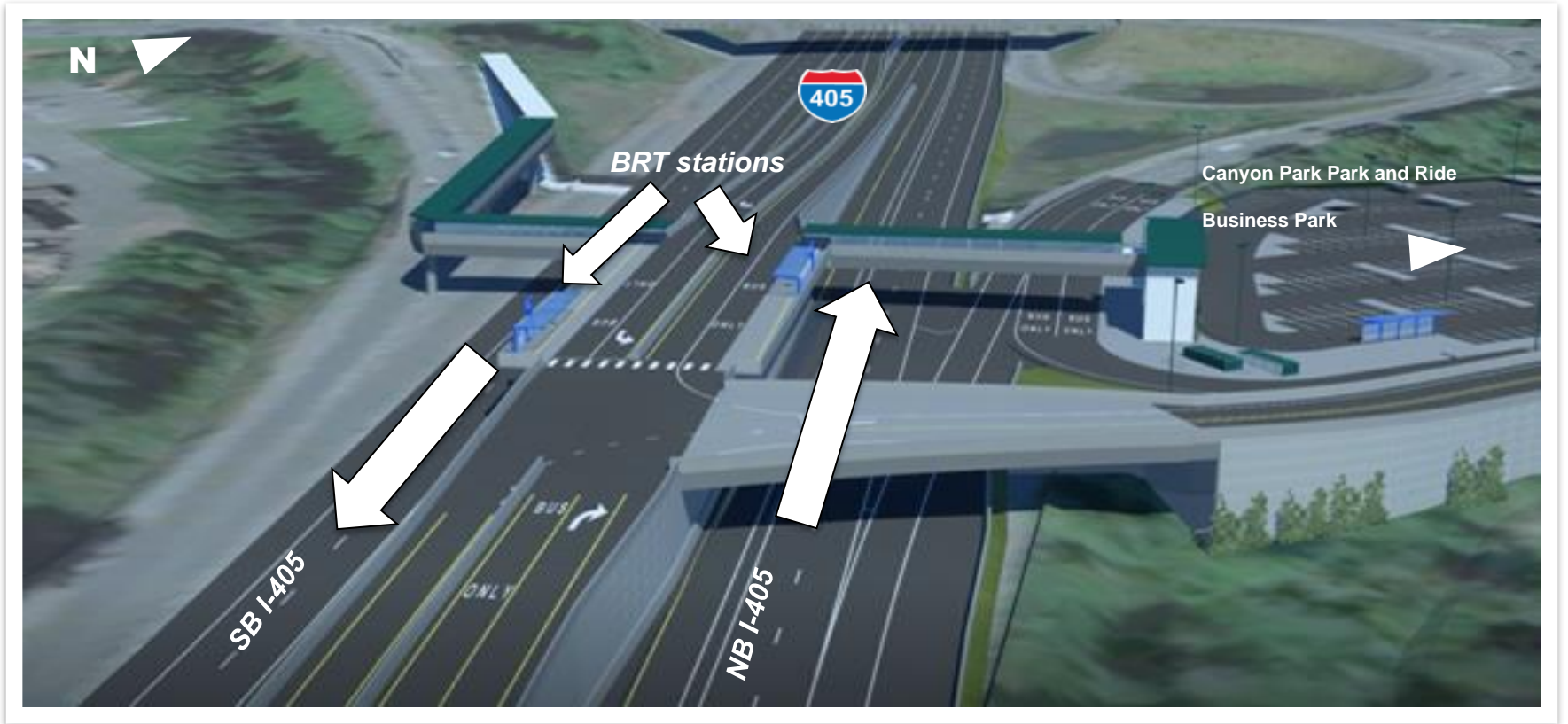

Construction updates

Construction milestones

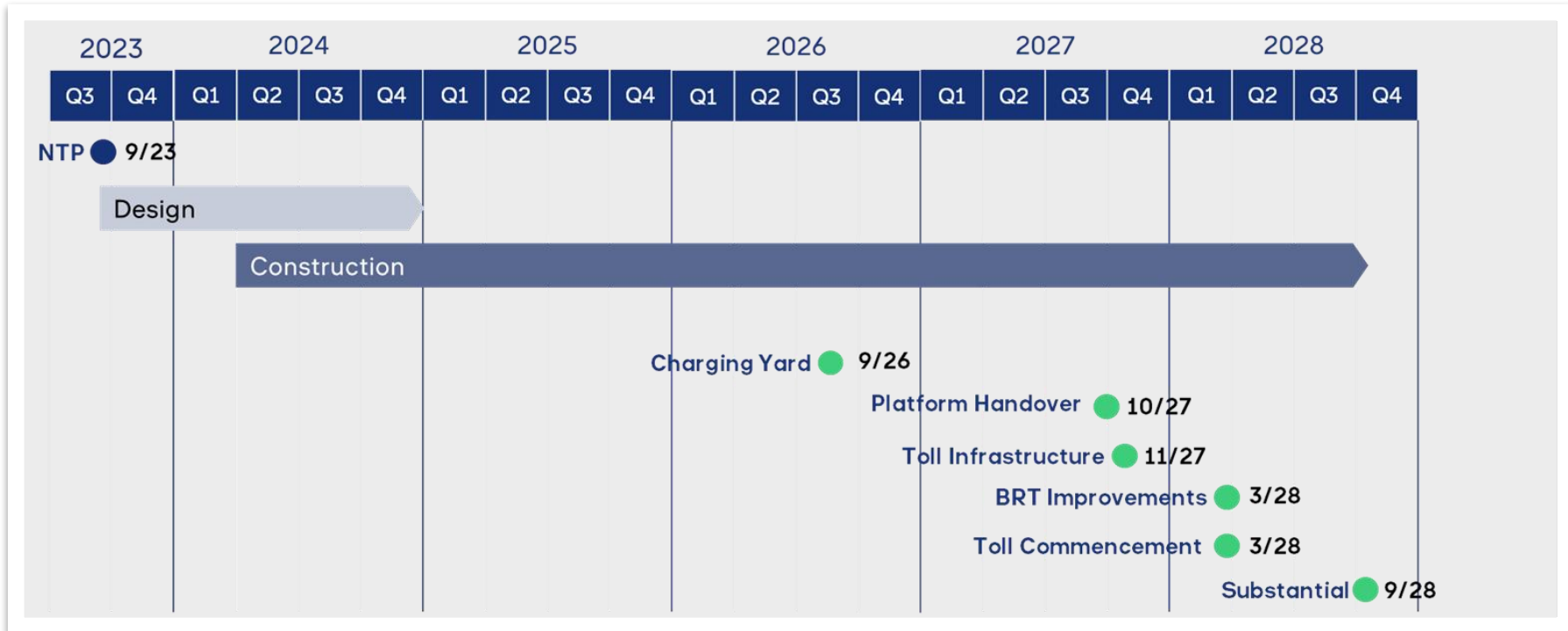

What's happened already?

- **Geotechnical surveys** and test anchors
- **Project site prep** and access work
- **SR 522 prep work** for traffic changes
- **Environmental prep work**



Crews performing saw cutting work on Woodinville Dr.

Upcoming Work

- **Ground improvements:** Building solid foundations by stabilizing the ground beneath construction areas.
- **Utility relocation:** Moving and adjusting utility pipes, cables, and lines to make way for the new infrastructure
- **Weekday and night work**



Upcoming Traffic Changes

- **Weekend lane closures:** Traffic on SR 522 reduced in both directions 4/12 - 4/15, 4/19 – 4/22
- **Lane shifts and speed limit reduction** (35 mph) starting 4/22 on SR 522

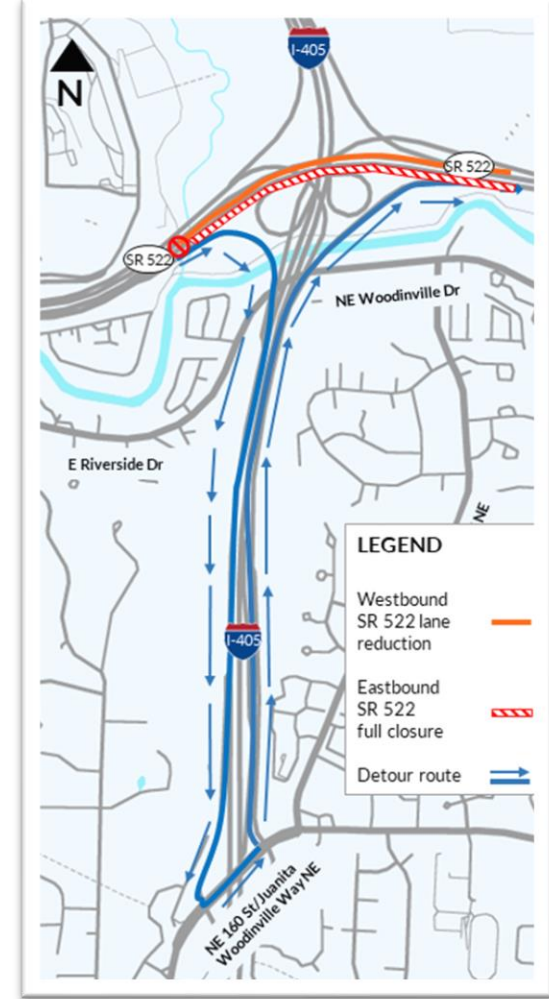

How to stay updated on the project

How we're keeping communities and partners informed

- Road signs
- Mailed materials and information
- Briefings, meetings, and events
- Email and website updates
- Poster and flyer distribution
- Project toolkits



Stay informed by subscribing to email updates.

Updates include:

- Closures
- Lane shifts
- Night or potentially impactful work
- Changes in work hours
- Construction milestones

How to stay updated



General project questions and email list:

I405SR167Program@wsdot.wa.gov

Email us to be added to the Brickyard to SR 527 Project email list.



Construction email:

info@405Brickyard.com



Visit our website:

bit.ly/BY-to-SR-527



Call our construction hotline:

425-354-3232

Monitored weekdays, 8 a.m. to 5 p.m.



Scan the QR code
with your phone to
visit our website.

Questions?